



Burwell Meadow, Witney

Guide Price £400,000



Burwell Meadow

Witney

Situated in a peaceful cul-de-sac on the popular Burwell Meadow development is this well-presented three-bedroom detached home with garage.

Council Tax band: TBD

Tenure: Freehold

EPC Energy Efficiency Rating: C

EPC Environmental Impact Rating: D

- A great opportunity to purchase this detached three-bedroom home located on the popular Burwell Meadow development.
- Garage and off-street parking.
- Open plan sitting/dining room with door leading out to the rear garden.
- South facing garden with summer house.
- Close to local amenities.
- Fitted kitchen.





Burwell Meadow - Witney

Approximate Gross Internal Area = 80.0 sq m / 861 sq ft
(Excluding Void)
Garage = 13.7 sq m / 147 sq ft
Total = 93.7 sq m / 1008 sq ft

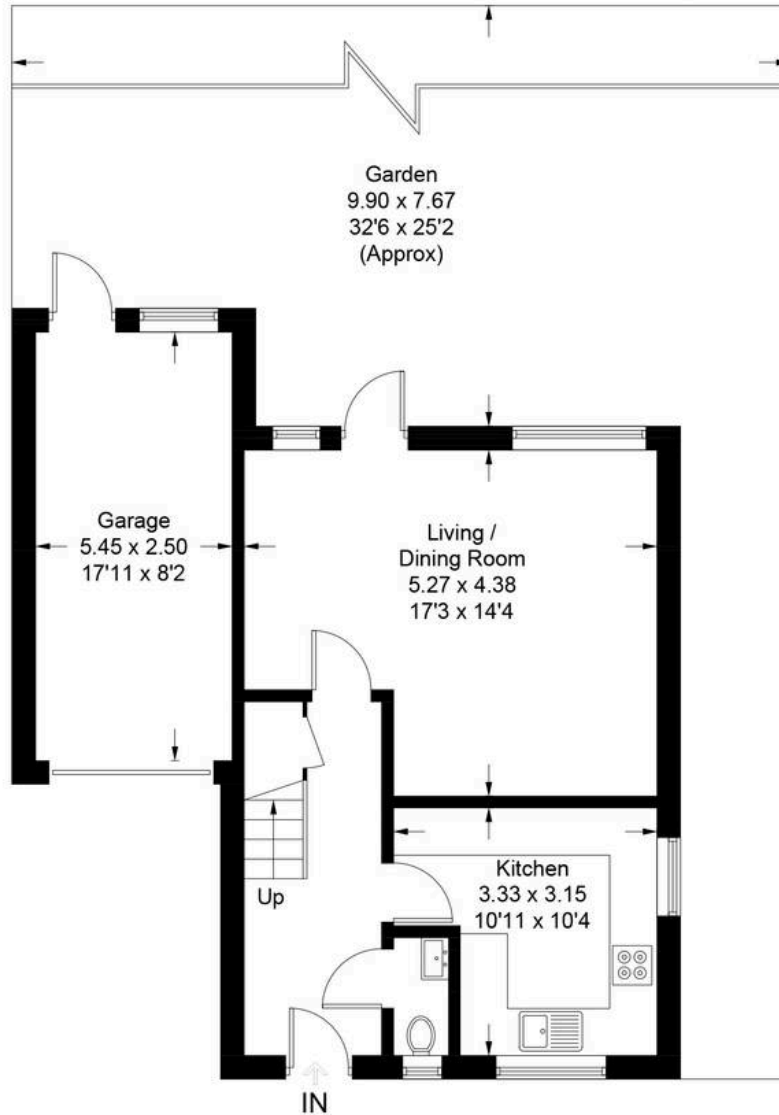

Ground Floor

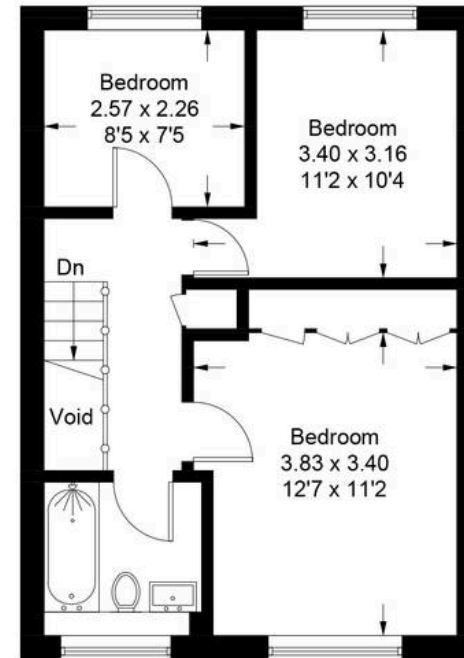

First Floor

Illustration for identification purposes only, measurements are approximate,
not to scale. Fourlabs.co © (ID1302831)



Simpsons Witney Branch

4 Langdale Court Witney, Oxfordshire - OX28 6AD

01993 835030 • witney@simpsonsproperty.com • www.simpsonsproperty.com/