

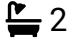



we are
morfittsmith

The Hearthwick, Blacksmith Croft, Dinnington, S25 2PL

Fixed Price £365,000

 3  2  2



A beautiful family home with heritage at its heart.

"Two Homes Reserved Already" Welcome to **The Hearthwick**—a stunning three-bedroom detached home in the sought-after Blacksmith Croft development. One of only eight individually crafted homes in this exclusive enclave, The Hearthwick blends characterful architecture with modern family living, all in a conservation setting rich with local history.

Set in natural stone and positioned just off Dinnington's historic High Street, this remarkable home offers generous living space, flexible family layouts, and the unique opportunity to personalise your interiors with a curated selection of kitchens, flooring, and finishes.

With spacious rooms, a private garden, and off-road parking, it's a home that gives you the freedom to grow, entertain, and unwind. Designed to reflect the story of its surroundings, The Hearthwick sits proudly on the site once home to Billy Hawke's village forge—a place where community and craftsmanship came together. That same spirit now lives on in every detail of this development.

A Story Worth Living In:

Blacksmith Croft is a place with soul. This peaceful corner of Dinnington is just a short stroll from local shops, traditional pubs, and St Leonard's Church, while the nearby A57 and M1 offer swift links to Sheffield, Rotherham, and beyond.

A Home Built to Last. A Setting Built to Remember.

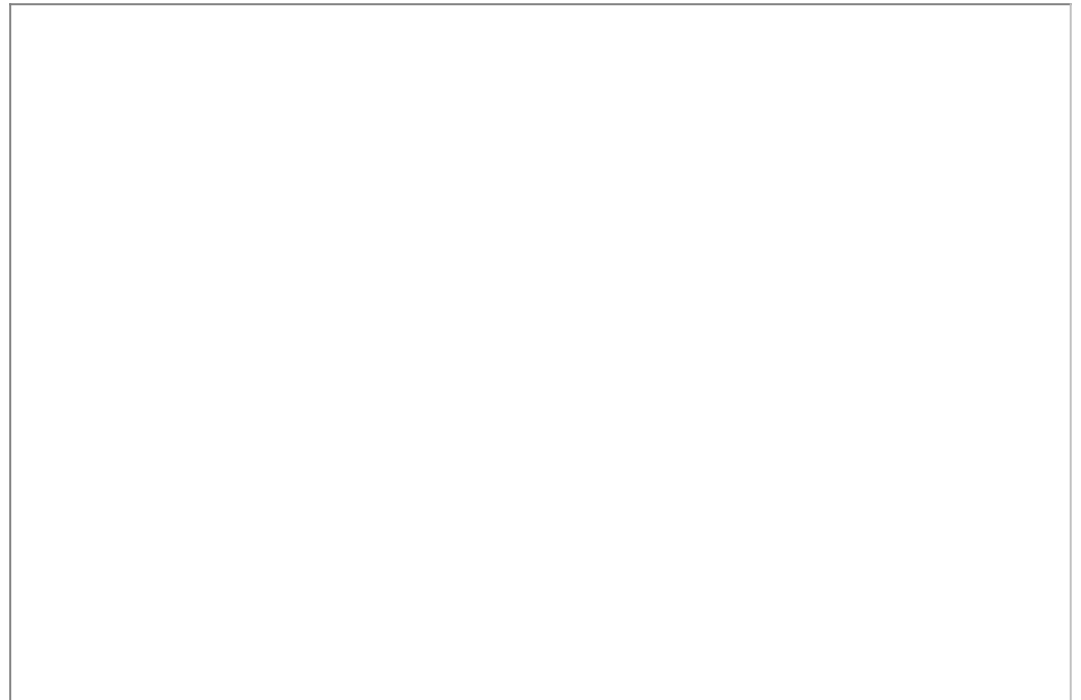

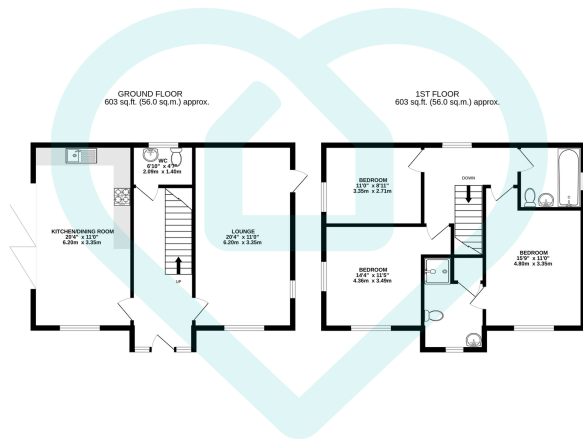

TOTAL FLOOR AREA : 1206 sq.ft. (112.0 sq.m.) approx.

This floor plan is for illustrative purposes only. All measurements and layouts are approximations and do not necessarily capture the precise specifications of the property. No responsibility is taken for any error, omission, or misstatement. We always recommend viewing in person to confirm the exact floor plan of a property. Made with Metropix.



- Exclusive three bedroom detached home.
- Traditional stone-built design
- Spacious family friendly layout
- Historic forge site location
- Near shops, schools and Anston Stones
- Select eight-home development
- Bespoke kitchen & interior choices
- Private garden and driveway parking
- Great links to M1 & A57
- 10 year New Build warranty



Sales | Lettings | New Homes

VAT Reg Number: 191 3588 84
 Company Reg Number: 08610489
 Company Reg Address: 67 Middlewood Road, Hillsborough, Sheffield, S6 4GX.

The MorfittSmith Building
 67 Middlewood Road
 Hillsborough
 Sheffield
 S6 4GX

Get in touch - arrange an appointment



0114 232 1764
 sales@morfittsmith.co.uk
 lettings@morfittsmith.co.uk
 newhomes@morfittsmith.co.uk
 www.morfittsmith.co.uk



@MorfittSmith
 @MorfittSmith
 MorfittSmith
 Estate & Letting Agent