

207 Saddlebow Road, King's Lynn PE30 5BW

£129,995

3 1 0



This well-proportioned terraced home offers flexible living space and plenty of potential for buyers seeking a property they can truly make their own. The accommodation is arranged over two floors and includes a generous open-plan living area with a striking fireplace, a spacious kitchen/breakfast room with additional utility facilities, and three bedrooms (2 rooms adjoined) upstairs alongside a sizeable family bathroom. Outside, the property benefits from a practical frontage, side access, and a private rear garden enjoying an easterly aspect. Double glazing and gas central heating are already in place, while the home would benefit from a degree of modernisation, making it an ideal opportunity for those looking to add value and personalise a characterful house in a convenient setting.



Key Features

- Terraced house with great potential
- 4-Piece-suite bathroom
- Ground floor W.C.
- Double glazed
- Feature fireplace
- 3 Bedrooms
- Generous garden
- Gas central heating
- No chain
- 25ft7 Lounge / dining room

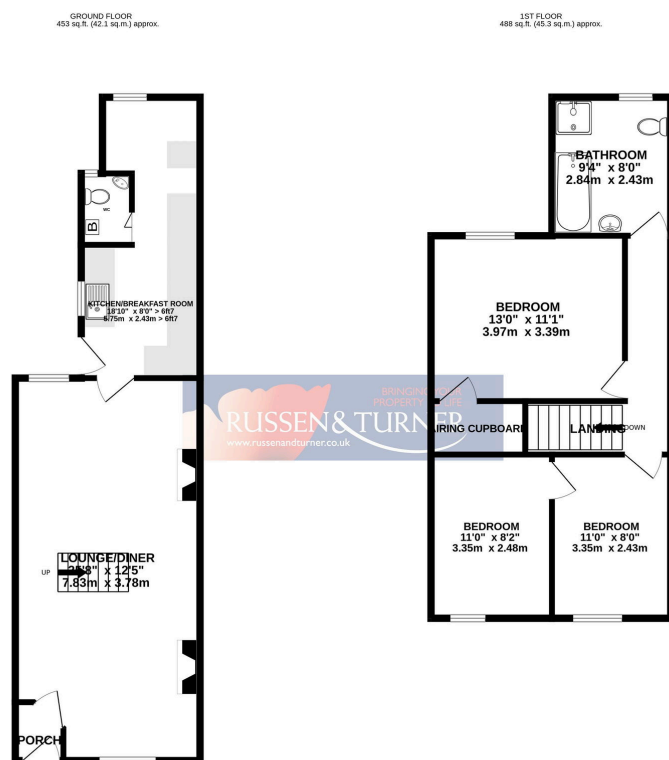

TOTAL FLOOR AREA : 941 sq.ft. (87.4 sq.m.) approx.
While every attempt has been made to ensure the accuracy of the floorplan contained herein, measurements of doors, windows, rooms and any other items are approximate and no responsibility is taken for any error, omission or mis-statement. This plan is for illustrative purposes only and should be used as such by any prospective purchaser. The services, systems and appliances shown have not been tested and no guarantee as to their operation or efficiency can be given.
Made with Metropix i2025