



76 Skripka Drive

, Billingham, TS22 5EZ

£335,000



Igomove is pleased to present this beautifully maintained four-bedroom detached family home, occupying a generous corner plot with a detached side garage, driveway providing off-road parking for two vehicles, and a private south-facing rear garden. Stylishly upgraded throughout, the property offers spacious, versatile accommodation perfectly suited to modern family living.



The welcoming entrance hall provides access to the main ground floor accommodation and features a useful understairs storage cupboard together with a convenient guest cloakroom/WC. To the front of the property is a generously proportioned lounge, offering an excellent space for relaxing or entertaining. Sliding doors open into the conservatory, creating a bright additional reception room with views over the garden and providing an excellent transition between indoor and outdoor living.

To opposite side, the impressive kitchen/diner is fitted with a comprehensive range of contemporary wall and base units, generous work surfaces and ample space for family dining.

To the first floor, the landing gives access to four well-proportioned bedrooms. The spacious master bedroom benefits from a modern en-suite shower room, while the remaining three bedrooms are served by a stylish family bathroom fitted with a contemporary white suite featuring fitted bath, basin and WC.

Externally, the property enjoys attractive gardens to the front and rear. The enclosed south-facing rear garden is predominantly laid to lawn with a paved patio, making it the perfect space for entertaining, al fresco dining or simply enjoying the sunshine throughout the day. A detached side garage provides excellent storage or secure parking, while the driveway offers off-road parking for two vehicles.

This superb family home combines generous living space, a practical layout, an enviable corner plot position and a highly desirable south-facing garden, making it an excellent opportunity for buyers seeking a home ready to move straight into. Make this home your own and book your viewing today. Igomove are open 7 days a week.

Area Map

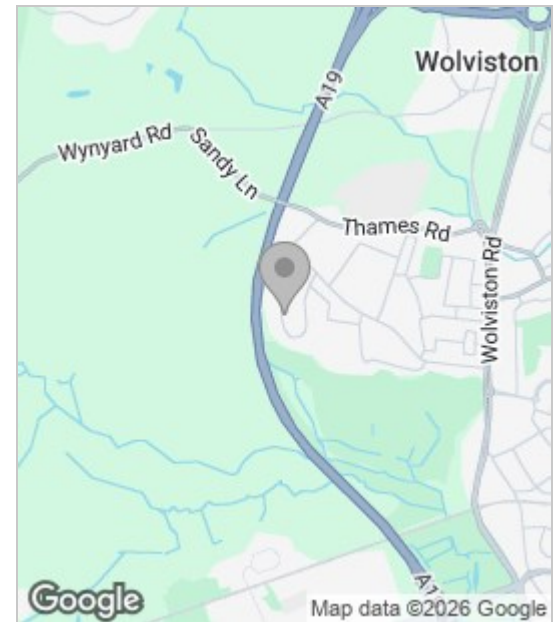

Floor Plan

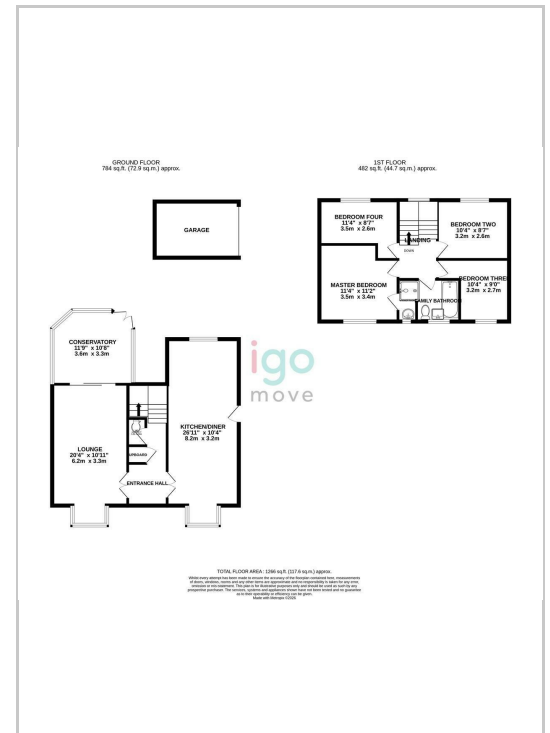

Energy Efficiency Graph

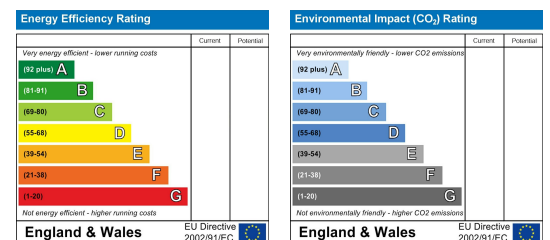

These particulars, whilst believed to be accurate are set out as a general outline only for guidance and do not constitute any part of an offer or contract. Intending purchasers should not rely on them as statements of representation of fact, but must satisfy themselves by inspection or otherwise as to their accuracy. No person in this firm's employment has the authority to make or give any representation or warranty in respect of the property.