



## 146 Whitchurch Road, Sundorne, Shrewsbury, Shropshire, SY1 4EJ

**Offers Over £220,000**

**A really well presented 3 bedroom semi detached house  
with ample parking and neat enclosed rear garden.**



The property enjoys a prominent corner position, with an ample gravel driveway and parking around the property. Built by Fletcher Homes, this traditional twin bay semi-detached house is entered through a decoratively glazed double-glazed entrance door into the generous entrance hall. The living room is the first on the left, enjoying a deep walk-in bay window and feature tiled fireplace. The dining room beyond also has a bay window, continuing the feel of space. The kitchen, to the rear of the property, has been extended and is fitted with an excellent range of units with integrated appliances and a door to the garden. The ground floor accommodation is completed with a cloakroom with a modern WC. Upstairs, the spacious landing leads to two double bedrooms, both with bay windows and a single bedroom with a feature bow window. The bathroom is fitted with a contemporary 3-piece suite and is located to the rear of the house. Outside is a neat rear garden enclosed by timber fencing and provides a patio, lawn and gravel seating area. The property is very well presented both internally and externally, and we thoroughly recommend booking a viewing.

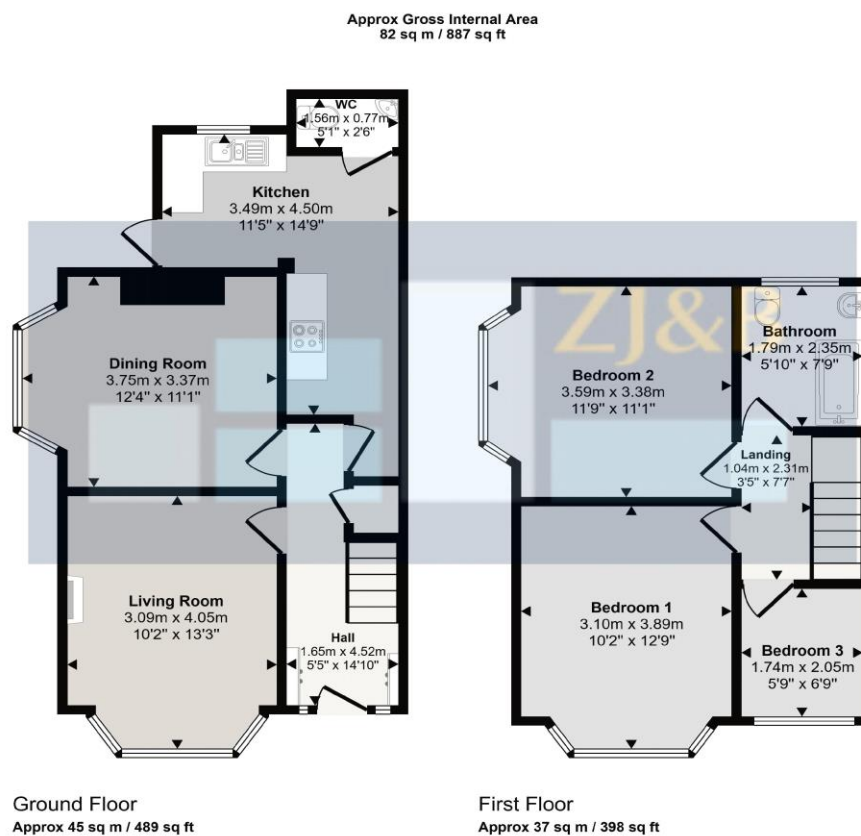

This floorplan is only for illustrative purposes and is not to scale. Measurements of rooms, doors, windows, and any items are approximate and no responsibility is taken for any error, omission or mis-statement. Icons of items such as bathroom suites are representations only and may not look like the real items. Made with Made Snappy 360.

FLOOR PLANS FOR GUIDANCE ONLY

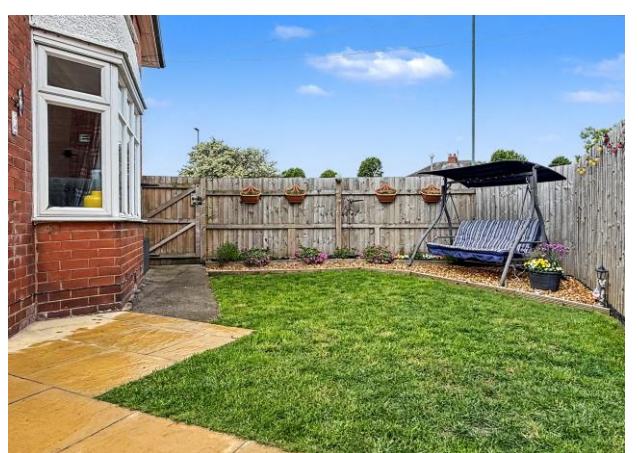

Find an energy certificate (/)

English | Cymraeg

## Energy performance certificate (EPC)

146 Whichurch Road SHREWSBURY SY1 4EJ	Energy rating <b>D</b>	Valid until: 24 February 2036
		Certificate number: 0300-2454-9520-2426-2951

**Property type** Semi-detached house

**Total floor area** 86 square metres

### Rules on letting this property

Properties can be let if they have an energy rating from A to E.

You can read [guidance for landlords on the regulations and exemptions \(https://www.gov.uk/guidance/domestic-private-rented-property-minimum-energy-efficiency-standard-landlord-guidance\)](https://www.gov.uk/guidance/domestic-private-rented-property-minimum-energy-efficiency-standard-landlord-guidance).

### Energy rating and score

This property's energy rating is D. It has the potential to be C.

[See how to improve this property's energy efficiency.](#)



This is a copy of the title plan on 13 MAY 2026 at 13:58:30. This copy does not take account of any application made after that time even if still pending in HM Land Registry when this copy was issued.

This copy is not an 'Official Copy' of the title plan. An official copy of the title plan is admissible in evidence in a court to the same extent as the original. A person is entitled to be indemnified by the registrar if he or she suffers loss by reason of a mistake in an official copy. If you want to obtain an official copy, the HM Land Registry web site explains how to do this.

HM Land Registry endeavours to maintain high quality and scale accuracy of title plan images. The quality and accuracy of any print will depend on your printer, your computer and its print settings. This title plan shows the general position, not the exact line, of the boundaries. It may be subject to distortions in scale. Measurements scaled from this plan may not match measurements between the same points on the ground.

This title is dealt with by HM Land Registry, Telford Office.

## Council Tax Band B

**Tenure:** Our client advises us that the property is Freehold. Should you proceed with the purchase of the property, these details must be verified by your solicitor.

**NB:** The mention of any appliances and/or services within these sales particulars does not imply that they are in full and efficient working order.

**Viewing:** To arrange a viewing call in at our office or telephone **01743 248351**

## FREE MORTGAGE ADVICE

Whether you are a first-time buyer, moving home, buying as an investor or looking to save on your mortgage payments, you could benefit from some **free** no obligation mortgage advice.

Contact **Stephen Bath** of Bee Mortgages, who is based at our office

**01743 248351**

**Whole of Market** clear and relevant tailored to your individual needs and circumstances.

**Your home may be repossessed if you do not keep up repayments on your mortgage**