

IMPORTANT NOTICE Wilkie May & Tuckwood for themselves and for the vendors of the property, whose agents they are, give notice that the particulars are intended to give a fair and substantially correct overall description for the guidance of intending purchasers and do not constitute part of an offer or contract. Prospective purchasers and lessees ought to seek their own professional advice. 2. All descriptions, dimensions, areas, references to condition and necessary permissions for use and occupation and other details are given in good faith, and are believed to be correct, but any intending purchasers should not rely on them as statements or representations of fact, but must satisfy themselves by inspection or otherwise as to the correctness of each of them. 3. No person in the employment of Wilkie May & Tuckwood has any authority to make or give any representations or warranty. 4. No responsibility can be accepted for any expenses incurred by whatever in relation to this property on behalf of Wilkie May & Tuckwood, nor enter into any contract on behalf of the vendor. 5. Measurements are approximate and have been taken by the vendor. 6. No responsibility can be accepted for any expenses incurred by intending purchasers in inspecting properties which have been sold, let or withdrawn. Photographs taken and details prepared February 2025. MEASUREMENTS AND OTHER INFORMATION All measurements are approximate and have been taken by the vendor. 7. We endeavour to make our sales particular accurate and reliable, if there is any point which is of particular importance to you, please contact the office and we will be pleased to check the information with you. We routinely refer potential sellers and purchasers to a selection of recommended local conveyancing firms. It is their decision whether to use those services. In making that decision, it should be known that we receive a payment benefit of not more than £150+VAT. Once an offer is accepted by our client, an Administration Fee of £20+VAT (£24) per buyer will be required in order to process the necessary checks relating to our compliance under Anti-Money Laundering legislation. This is a non-refundable payment and cannot be returned should purchase cease to continue. It can be paid via a card machine, or via BACS transfer. Code of Practice for Residential Estate Agents: Effective from 1 August 2011. 8. Financial Evaluation 8a At the time that an offer has been made and is being considered by the seller, you must take reasonable steps to find out from the prospective buyer the source and availability of his funds for buying the property and pass this information to the seller. Such information will include what her the prospective buyer needs to sell a property, requires a mortgage, claims to be a cash buyer or any combination of these. Such relevant information that is available should be included in the Memorandum of Sale having regard to the provisions of the Data Protection Act 1998. These reasonable steps must continue after acceptance of the offer until exchange of contracts (in Scotland, conclusion of missives) and must include regular monitoring of the prospective buyer's progress in achieving the funds required, and reporting such progress to the seller. The agent has not tested any apparatus, equipment, fixtures and fittings or services and so cannot verify that they are in working order or fit for their purpose. A Buyer is advised to obtain verification from their solicitor or surveyor. References to the Property are based on information supplied by the Seller. The agent has not had sight of the title documents. A Buyer is advised to obtain verification from their solicitor.

GENERAL REMARKS AND STIPULATIONS:
Tenure: Freehold
Services: All mains services, mains electricity, mains water, mains drainage, mains gas
Local Authority: Somerset Council, County Hall, The Crescent, Taunton, TA1 4DY
Property Location: <https://what3words.com/dated.busy.codes>
Council Tax Band: F
Broadband Availability: Superfast up to 80 Mbps download & 20 Mbps upload speed.
Mobile Phone Coverage: <https://www.ofcom.gov.uk/mobile-coverage-checker>
Flood Risk: Rivers & Sea - Very Low. Surface Water - Very Low.
Agents Note: The property is on a private road.
 Details accurate as of 7th May 26



7 Quantock Rise, TA2 8HJ
 £599,950 Freehold

4 2 2 C EPC

Wilkie May & Tuckwood

Floor Plan

Quantock Rise, Kingston St. Mary, Taunton, TA2

Approximate Area = 1624 sq ft / 150.8 sq m

Garage = 184 sq ft / 17 sq m

Outbuildings = 125 sq ft / 11.6 sq m

Total = 1933 sq ft / 179.4 sq m

For identification only - Not to scale

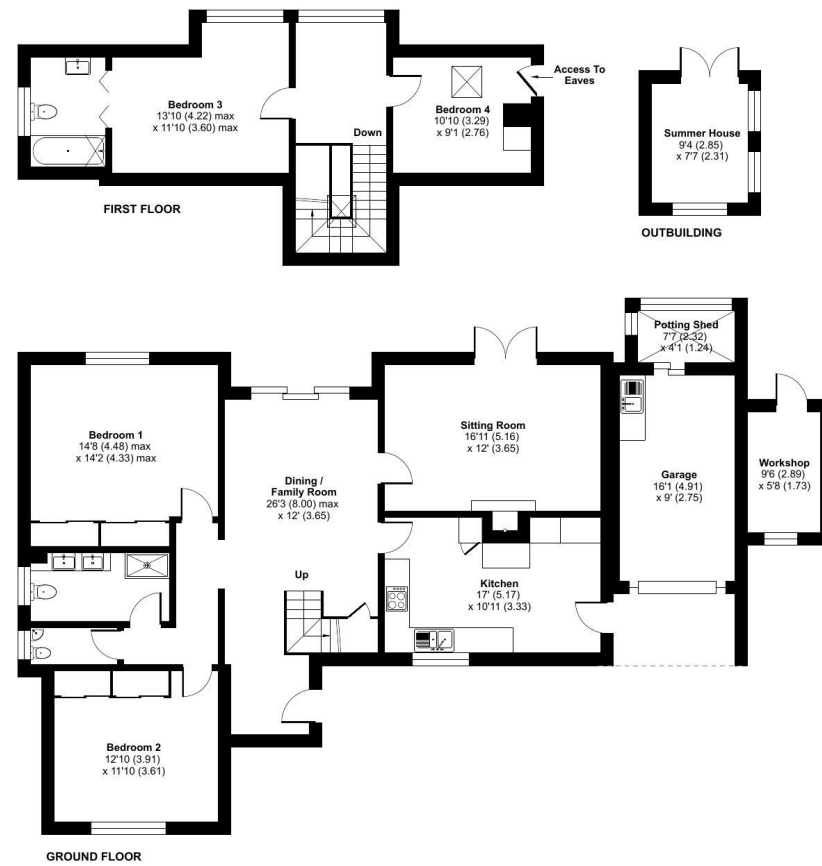

Floor plan produced in accordance with RICS Property Measurement 2nd Edition, Incorporating International Property Measurement Standards (IPMS2 Residential). © rlxhcom 2026. Produced for JREA Ltd TA Wilkie May & Tuckwood, Taunton. REF: 1454333

WM&T

Description

- Detached Chalet Bungalow
- 4 Bedrooms
- Fully Renovated
- Stunning Landscaped Gardens
- Views Over Countryside
- Private Road

Set along a private road on the edge of the highly desirable village of Kingston St Mary, 7 Quantock Rise is a beautifully presented and comprehensively renovated 3/4 bedroom detached chalet home, enjoying attractive views over open countryside to the front.

Occupying a generous plot, the property is surrounded by stunning, thoughtfully landscaped gardens and further benefits from a single garage and a driveway providing ample parking for several vehicles. Since 2021, the home has undergone an extensive programme of improvements, including a complete rewire, new central heating system, replacement windows, full redecoration, and the stylish refitting of the kitchen, bathroom, and en-suite. The gardens have also been creatively redesigned to provide attractive and functional outdoor spaces.



The accommodation is both versatile and well-proportioned. An inviting entrance porch leads into a spacious dining/family room, featuring sliding patio doors opening onto the garden and stairs rising to the first floor. From here, access is gained to a comfortable living room, complete with a multi fuel-burning stove and French doors leading outside.

The modern, re-fitted kitchen is well-equipped with a range of matching wall and base units, work surfaces, and tiled splashbacks. Integrated appliances include a double oven, electric hob, and extractor, with additional space for a dishwasher and tall fridge freezer. A door provides convenient access to the exterior.

On the ground floor, there are two generously sized bedrooms, including a principal bedroom with large built-in wardrobes and pleasant views over the garden.

A stylishly re-fitted shower room and a separate WC complete the ground floor accommodation.

Upstairs, the first floor offers two further bedrooms, one of which benefits from its own en-suite bathroom. There is also useful eaves storage, where the gas boiler is located.

Externally, the property truly excels, with beautifully landscaped gardens designed to offer a combination of relaxation, entertaining space, and visual appeal, making this an exceptional home in a highly sought-after village setting.

WM&T