

Wilcox Close, SW8

£395,000

A bright two bedroom first floor flat in excellent condition throughout. Comprising of a reception room which leads into a separate kitchen which offers space for dining and direct access onto a south facing balcony. Furthermore the property has good storage and is being sold with no onward chain.

A fantastic location for those seeking quick access to transport links. There are many bus routes just moments away, as is Nine Elms Tube station (Northern Line). There are a number of shops and cafés close by including access to Vibrant Nine Elms and the Battersea Power Station via "Arch 42".

Features

- Two Bedrooms
- No Onward Chain
- South Facing Balcony
- Great Condition
- Purpose Built
- Separate Kitchen

Wilcox Close, London, SW8

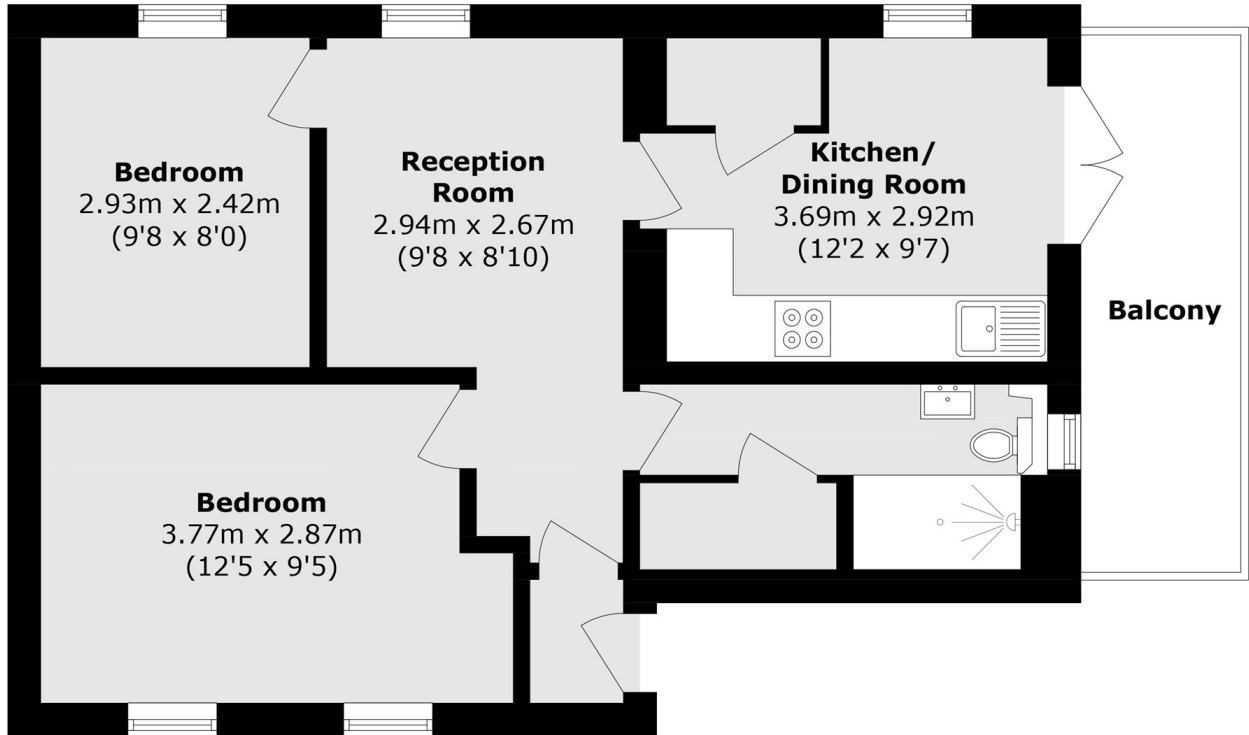

Total area (approx.): 49.7 sq. m (535.0 sq. ft)

Balcony (approx.): 7.0 sq. m (75.3 sq. ft)