



Whitfield Street, W1T

£865 Per week

The property consists of spacious reception area, separate fully fitted kitchen, two double bedrooms and private outside space. The apartment has wooden floors throughout as well as built in wardrobes with excellent transport links to central tube stations.

Whitfield Street is quietly tucked away just behind the famous Fitzroy Square and a few yards from Tottenham Court Road.

Features

- Two Bedrooms
- Prime Location
- Great Storage
- Wooden Floors
- Outside Space
- Spacious

Whitfield Street, London, W1T

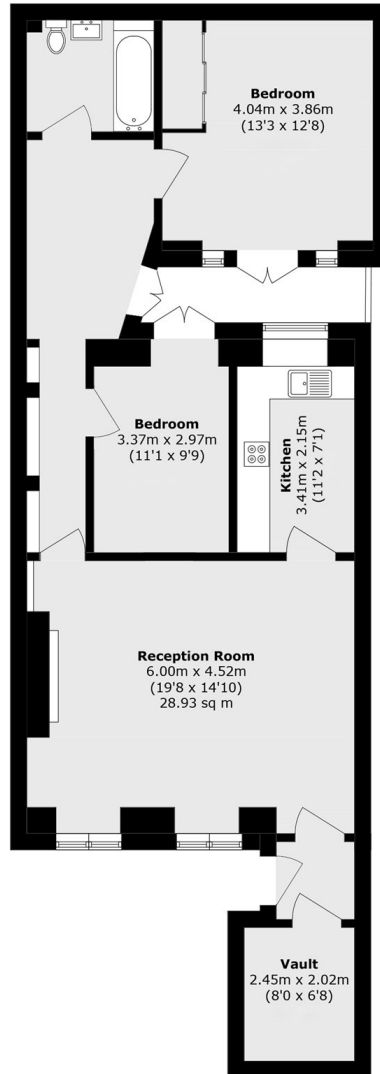

Total area (approx.): 89.5sq. m (963.3sq. ft)