



Bradwell Green

Hutton, Brentwood, CM13 1YR

Guide Price £270,000

Guide Price: £270,000 - £300,000

A well-presented and conveniently located apartment situated in the highly sought-after area of Hutton, just a short distance from Brentwood's vibrant town centre and excellent transport links.

This bright and spacious flat offers well-proportioned accommodation throughout, ideal for first-time buyers, investors, or those looking to downsize. The property features a welcoming entrance hall leading to a generous living/dining area, perfect for both relaxing and entertaining. The kitchen is fitted with a range of modern units and provides ample storage and workspace.

The bedroom is well-sized and benefit from plenty of natural light, while the bathroom is finished in a clean, contemporary style.

Externally, the property is set within well-maintained communal grounds and benefits from allocated parking.

Bradwell Court is ideally positioned for access to Shenfield Mainline Station, offering fast and direct services into London via the Elizabeth Line, making it perfect for commuters. Local shops, amenities, and reputable schools are also within easy reach.

- GUIDE PRICE £270,000 - £300,000
- CHAIN FREE
- BALCONY
- ALLOCATED PARKING SPACE
- DOUBLE BEDROOM WITH BUILT IN WARDROBES
- MODERN KITCHEN WITH INTEGRATED APPLIANCES
- SECOND FLOOR APARTMENT
- NEARBY GREEN SPACES & LOCAL AMENITIES
- COUNCIL TAX - C - BRENTWOOD
- ENERGY PERFORMANCE RATING - D

Viewing

Please contact our Sales Office on 01268 730707 if you wish to arrange a viewing appointment for this property or require further information.



Floor Plan

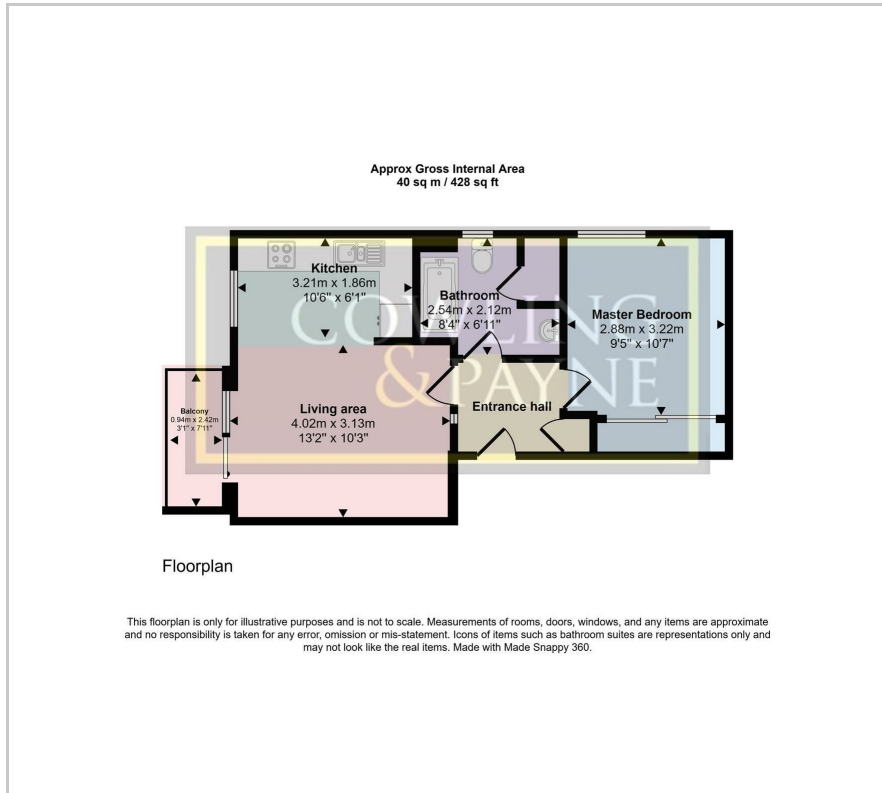

Area Map



Energy Efficiency Graph

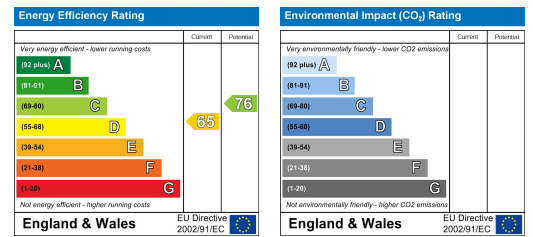

These particulars, whilst believed to be accurate are set out as a general outline only for guidance and do not constitute any part of an offer or contract. Intending purchasers should not rely on them as statements of representation of fact, but must satisfy themselves by inspection or otherwise as to their accuracy. No person in this firm's employment has the authority to make or give any representation or warranty in respect of the property.

2-4 Runwell Road, Wickford, Essex, SS11 7AB

Tel: 01268 730707 Email: info@cowlingandpayne.co.uk <https://www.cowlingandpayne.co.uk>