



## Plumbridge Street, SE10

£700,000

A charming three bedroom period cottage in a sought after location with potential to extend subject to planning permission.

Plumbridge Street is in West Greenwich with mainline rail and DLR services just moments away, as is the town centre which offers a fantastic array of shops, restaurants, markets and museums, along with the delightful Royal Park.

### Features

Period Family Home  
Three Bedrooms  
West Greenwich  
Freehold  
Potential To Extend STPP  
Sought After Location

Plumbridge Street,  
London, SE10

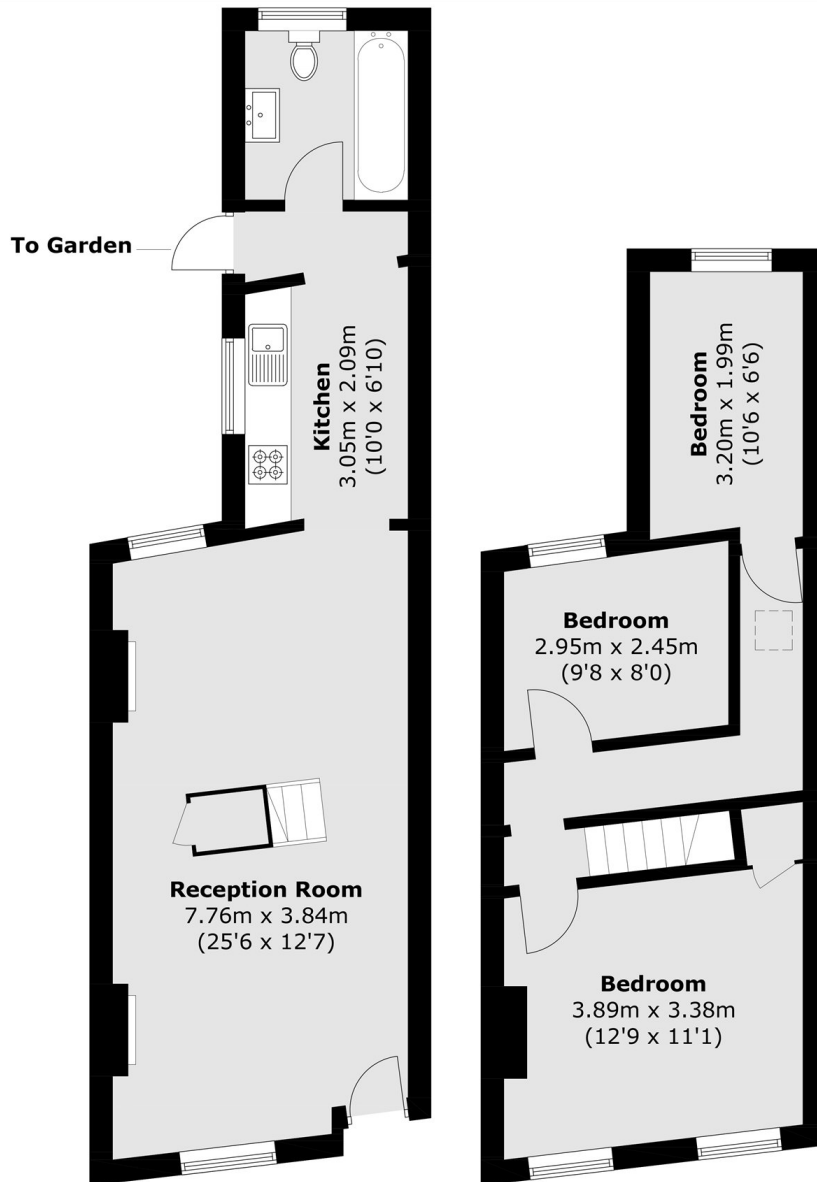

**Ground Floor**

**First Floor**

Total area (approx.): 80.7 sq. m (868.6 sq. ft)