



103 Montrose Avenue, Luton, LU3 1HP

Situated on the ever popular Montrose Avenue in Luton, this spacious four bedroom semi detached family home offers generous accommodation, excellent potential, and a well balanced layout ideal for modern family living.

The property benefits from a large private driveway providing ample off street parking and offers clear potential to extend (subject to the usual planning consents), making it an ideal long term family home or investment opportunity.

Internally, the ground floor comprises a well proportioned kitchen/diner, a separate lounge, and an additional reception room offering flexible living or entertaining space. A convenient downstairs WC adds further practicality. Upstairs, there are four good sized bedrooms served by two bathrooms.

- Nova Estate Agents
- Four Bedrooms
- Driveway
- Three Reception rooms
- Potential To Extend
- Two Bathrooms & Downstairs WC
- Close to Schools, Shops and Mosques
- Press Play Button For 360° Walkaround Tour

£500,000

Approx Gross Internal Area
148 sq m / 1594 sq ft

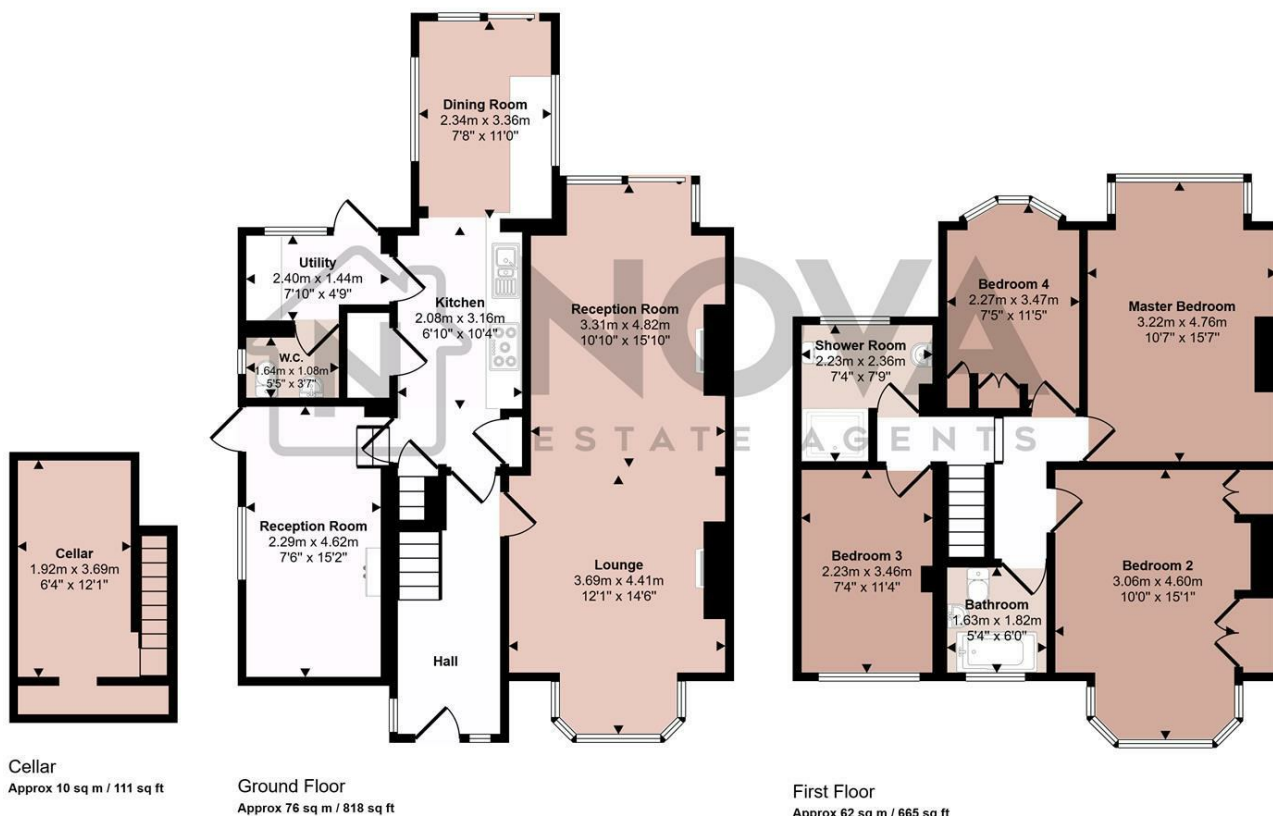

This floorplan is only for illustrative purposes and is not to scale. Measurements of rooms, doors, windows, and any items are approximate and no responsibility is taken for any error, omission or mis-statement. Icons of items such as bathroom suites are representations only and may not look like the real items. Made with Made Snappy 360.

