



## CANTERBURY ROAD, NW6

£650,000

An impressive two bedroom apartment set on the second floor of a contemporary development, offering approximately 725 sq ft. The property offers bright, well balanced living space with an open plan

Two Double Bedrooms  
Two Bathrooms  
Second Floor

Approx. 725sq ft  
Allocated Parking  
Communal Roof Terrace

# STEP INSIDE CANTERBURY ROAD

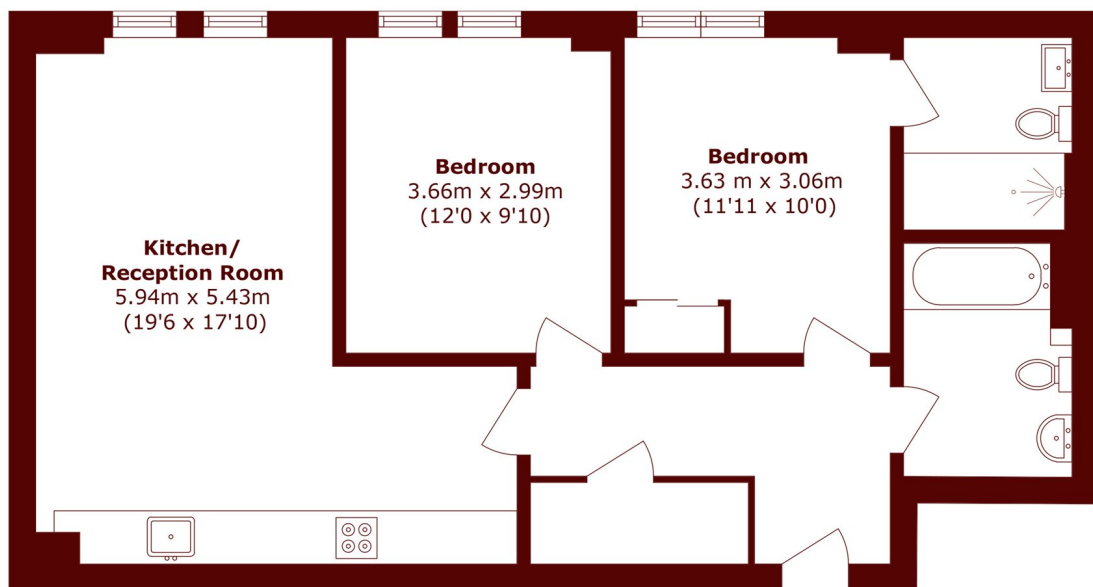

Total area (approx.): 67.4 sq. m (725.4 sq. ft)

Little Venice  
020 7993 3050

Energy Rating: We aim to make our particulars both accurate and reliable. However, they are not guaranteed; nor do they form part of an offer or contract. If you require clarification on any points then please contact us, especially if you're traveling some distance to view. Please note that appliances and heating systems have not been tested and therefore no warranties can be given as to their good working order

MARSH &  
PARSONS