



Westcombe Park Road, SE3

£325,000

Well appointed one bedroom ground floor retirement apartment situated in this sought after development in Westcombe Park. This well maintained block benefits from a lovely south-facing communal garden, with the apartment enjoying direct access to and overlooking these beautifully maintained gardens. Residents can also make use of a welcoming residents' lounge, where regular coffee mornings are held, a communal laundry room, and residents' parking. The apartment features a separate kitchen and spacious reception room. There is a double bedroom with ample space and a separate bathroom. Offered to the market with no onward chain.

In the heart of Westcombe Park, minutes from shops and amenities. Excellent location for bus routes to North Greenwich, Lewisham and Central London. Close to Greenwich park and Blackheath.

Features

- Well Appointed Retirement Flat
- Direct Access To Communal Gardens
- Stunning Grounds
- Excellent Location
- Over 60's Only
- No Chain

Westcombe Park Road, London, SE3

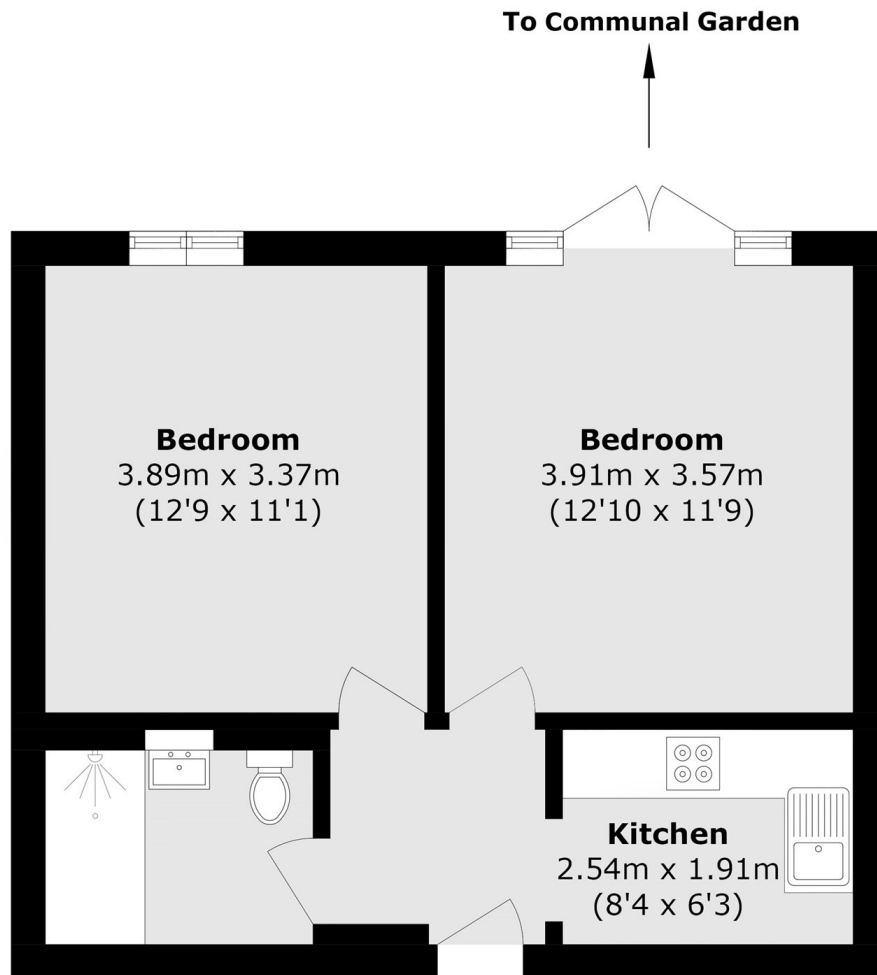

Total Area (approx.): 41.9 sq. m (451.0 sq. ft)