

*Franklyn  
James*



Albert Mews, E14 8EH

£900,000



Albert Mews, E14 8EH

£900,000

- End of terrace
- Off-street parking
- Private rear garden
- Close to DLR station
- Short riverside walk to Canary Wharf

EPC rating-  
Tax band- F



Franklyn James are delighted to present this end of terrace, four bedroom townhouse situated off Narrow Street. Offering approximately 1131 sq ft of internal living space, this freehold house includes a private rear garden and off-street parking. The ground floor comprises entrance hall with ground floor cloakroom, fitted kitchen, reception room leading to private rear garden. The first floor has two bedrooms (or a second reception) and the top floor has two further bedrooms, an ensuite to the master bedroom and a separate family bathroom.

## Albert Mews

Approx. Gross Internal Area 1131 Sq Ft - 105.07 Sq M

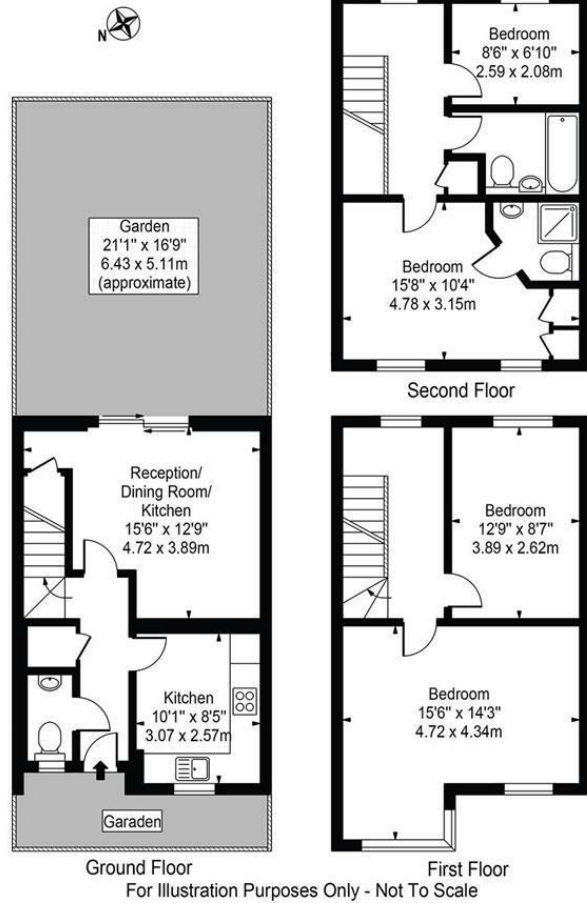

This floor plan should be used as a general outline for guidance only and does not constitute in whole or in part an offer or contract. Any intending purchaser or lessee should satisfy themselves by inspection, searches, enquiries and full survey as to the correctness of each statement. Any areas, measurements or distances quoted are approximate and should not be used to value a property or be the basis of any sale or let.

## Area Map

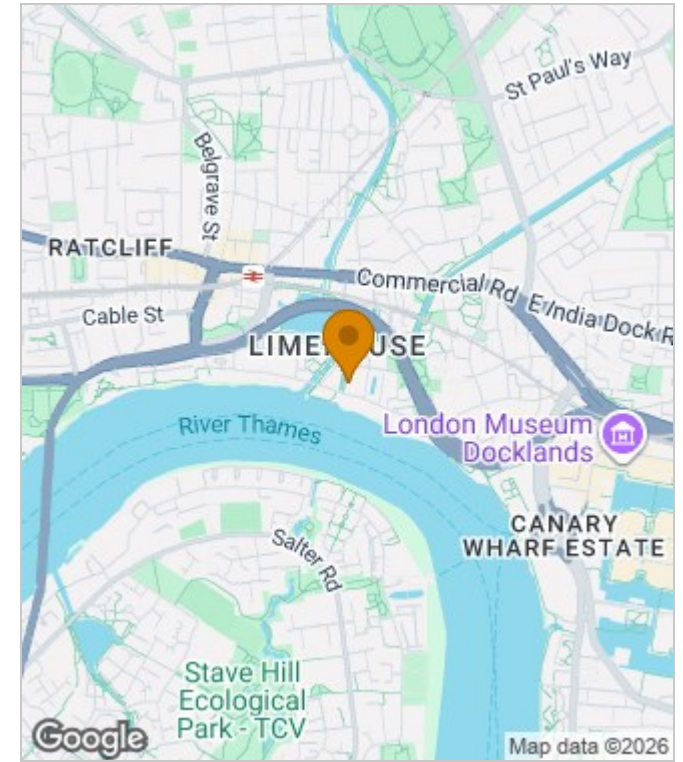

## Energy Performance Graph

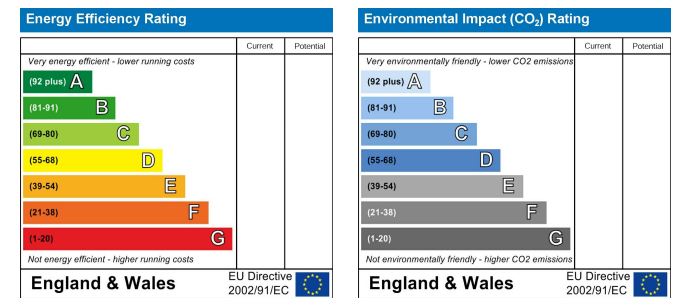

These particulars, whilst believed to be accurate are set out as a general outline only for guidance and do not constitute any part of an offer or contract. Intending purchasers should not rely on them as statements of representation of fact, but must satisfy themselves by inspection or otherwise as to their accuracy. No person in this firm's employment has the authority to make or give any representation or warranty in respect of the property.