





**POOLE
TOWNSEND**

Nethercroft, Levens, Kendal, LA8 8LU

£395,000

 3  3  1



- Modern Terraced House
- Double Garage / Games Room
- Beautiful Garden
- Sought After Village Location
- Tenure: Leasehold
- 3 Bedrooms
- Balcony To The Lounge Room
- Allocated Parking
- Breath Taking Views
- Council Tax Band: D



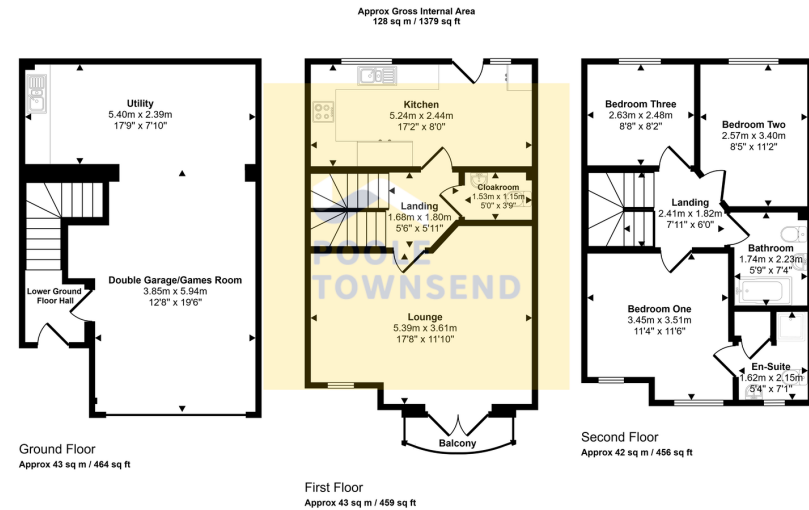

This floorplan is only for illustrative purposes and is not to scale. Measurements of rooms, doors, windows, and any items are approximate and no responsibility is taken for any error, omission or mis-statement. Icons of items such as bathroom suites are representations only and may not look like the real items. Made with Made Snappy 360.

Enjoy breath-taking open views over the Lyth Valley and distant Langdale Fells from this stylishly modernised and deceptively spacious family home. Arranged over two floors, the lower ground level features an integral double garage and utility, currently used as a large family games and cinema room. The ground floor offers a west-facing lounge with balcony, a cloakroom, and a contemporary kitchen/diner with glazed doors seamlessly connecting to the low-maintenance garden. Upstairs, three well-proportioned bedrooms include a master with ensuite, alongside a family bathroom. Outside, beautifully landscaped terraced gardens with colourful planting and decked seating areas provide the perfect space for relaxation and alfresco dining. Allocated parking and shared visitor spaces complete this exceptional home. A perfect blend of modern family living, versatility, and stunning countryside

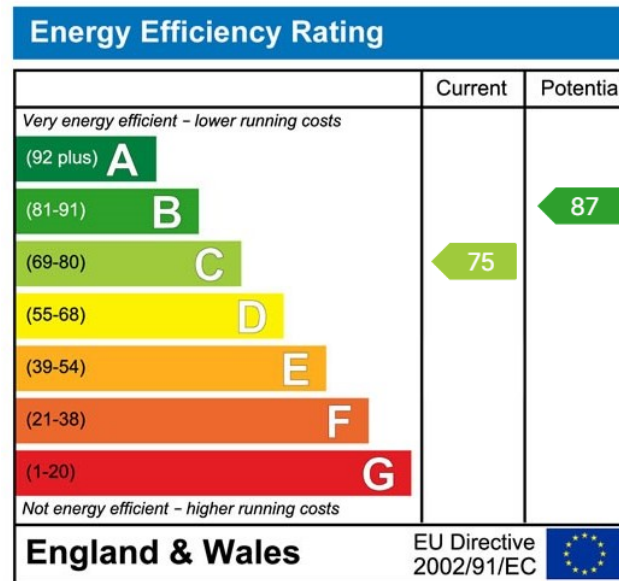

Visit us at
www.pooletownsend.co.uk
enquiries@pooletownsend.co.uk

We are open
 Monday – Friday 9.00 – 5.00
 Saturday 9.00 – 1.00

Barrow 01229 811811
 Ulverston 01229 588111
 Grange 015395 33316
 Kendal 01539 734455
 Milnthorpe 015395 62044