



Knightsbridge Court, Blackburn Street, Salford

Offers In Excess Of £165,000

Say hello to stylish city living at its finest! This bright and breezy dual-aspect corner apartment in the ever-popular Knightsbridge Court on Blackburn Street, Salford is bursting with charm and modern flair.

Perched on the second floor, this home is drenched in natural light, giving every room a fresh, uplifting feel. Inside, you'll find a generous reception space perfect for relaxing or entertaining, a sleek and cosy bedroom for unwinding, and a contemporary bathroom that adds a touch of everyday luxury. Cleverly designed, every inch of this apartment works hard while looking effortlessly good.

Step outside and you're right in the heart of it all, from coffee spots and casual dining to handy shops, everything you need is just around the corner. And with excellent transport links nearby, getting to Manchester city centre or beyond is quick and easy.

Whether you're starting out, downsizing, or simply looking for a vibrant place to call home, this apartment ticks all the boxes. Bright, modern, and perfectly located, it's ready and waiting for you to move in and make it yours!

No Parking & No Lift

LEASEHOLD



SECOND FLOOR
608 sq.ft. (56.5 sq.m.) approx.

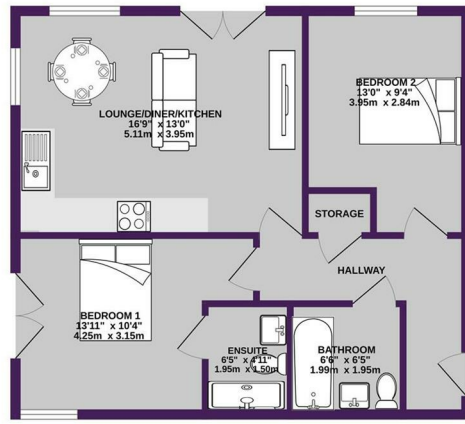

2 BED 2 BATH
TOTAL FLOOR AREA: 608 sq.ft. (56.5 sq.m.) approx.
© 2026 Ascend Property Services Ltd. All rights reserved. This floor plan is for information only and does not constitute an offer of any property. The actual floor plan may vary slightly from the one shown. The actual floor plan may vary slightly from the one shown. The actual floor plan may vary slightly from the one shown. The actual floor plan may vary slightly from the one shown.

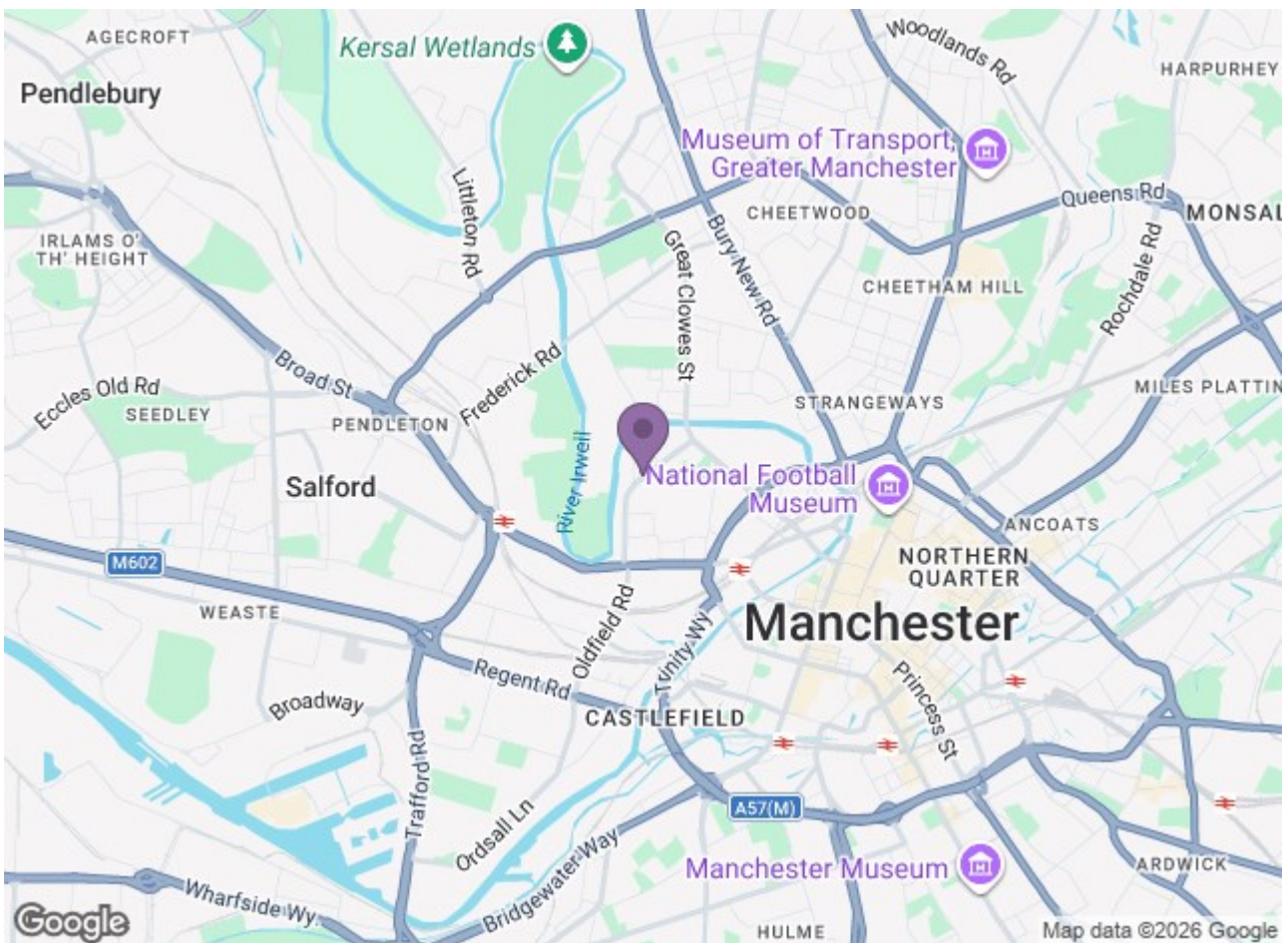

Energy Efficiency Rating		Environmental Impact (CO ₂) Rating	
Current	Potential	Current	Potential
83 / 83		G / G	

Ascend
Built on higher standards