



## SUGAR HOUSE, E1

£2,500 pcm

Lovingly restored & converted former Victorian-Era Sugar Warehouse | Characterful and quiet home in the heart of Aldgate & Tower Hill | Modern Interior & Spacious |



## ABOUT THE HOME

Sugar House is a lovingly restored & converted former Victorian-Era Sugar Warehouse and office building. The opulence just shows from the moment you walk through the impressive carved doors of this astounding building and admire the marble floors and grand staircase of the entrance hall on your way home. || This apartment is a one bed / one bath with an open plan kitchen / spacious living area. After a long day of work you may want to perhaps just relax and melt away into the luxurious sofa or the impressive bed, curled up with a hot mug of cocoa or take some time out on the balcony and the crisp evening air? || Sugar House is in the heart of London





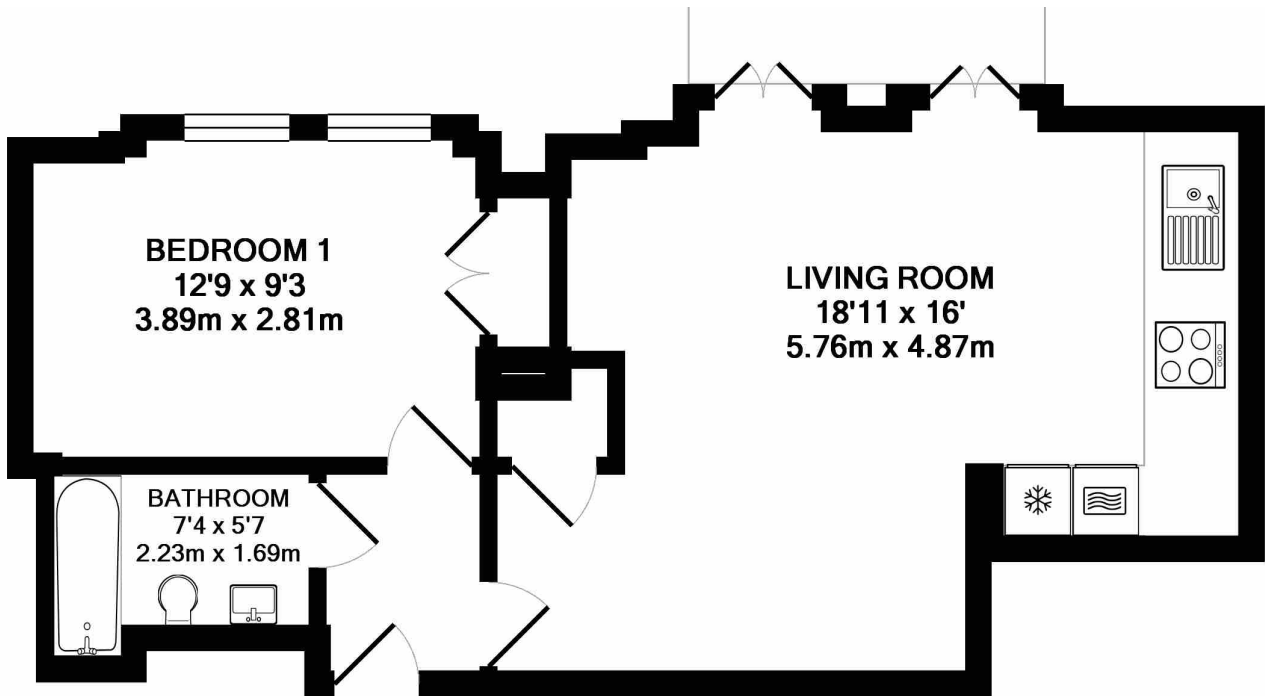

TOTAL APPROX. FLOOR AREA 469 SQ.FT. (43.6 SQ.M.)

Whilst every attempt has been made to ensure the accuracy of the floor plan contained here, measurements of doors, windows, rooms and any other items are approximate and no responsibility is taken for any error, omission, or mis-statement. This plan is for illustrative purposes only and should be used as such by any prospective purchaser. The services, systems and appliances shown have not been tested and no guarantee as to their operability or efficiency can be given

Made with Metropix ©2018



**LiFE RESIDENTIAL**

71 Drayton Park, London, N5

1BF

Sales: 020 3838 8666

Lettings: 020 7359 4488

Energy Rating: C. We aim to make our particulars both accurate and reliable. However they are not guaranteed; nor do they form part of an offer or contract. If you require clarification on any points then please contact us, especially if you're traveling some distance to view. Please note that appliances and heating systems have not been tested and therefore no warranties can be given as to their good working order.