



Albert Street | Amble | NE65 0LZ

**£180,000**

This beautifully refurbished end of terrace house in Amble offers three spacious bedrooms, two stylish reception rooms, a modern open-plan kitchen, and ample storage, making it an ideal, chain-free opportunity for first-time buyers or investors.

ROOK  
MATTHEWS  
SAYER



**FREEHOLD**

**STONE END-TERRACED HOUSE**

**THREE BEDROOMS**

**LOUNGE WITH FIREPLACE**

**FULLY REFURBISHED**

**OPEN PLAN DINING KITCHEN**

**GAS CENTRAL HEATING**

**NO CHAIN**

For any more information regarding the property please contact us today

#### **47 ALBERT STREET, AMBLE, NE65 0LZ**

Welcome to this immaculate end of terrace house, perfectly positioned in a sought-after location close to Amble's vibrant shopping street and Morrisons supermarket nearby. Recently fully refurbished and freshly decorated, this inviting home is sure to capture the hearts of first-time buyers and investors alike. With the added advantage of no onward chain, a smooth and speedy move is within your reach.

Step inside and you'll find a stylish reception room featuring a charming inglenook fireplace with a wood mantel incorporating a living flame effect gas stove — ideal for cosy evenings. The open-plan kitchen-dining room is a true highlight, thoughtfully designed with a Belfast sink, an induction hob, integral electric oven, and a bright dining space with a breakfast area, creating a welcoming spot to start your day.

Upstairs, discover three generously sized bedrooms, with the principal bedroom benefiting from A built-in wardrobe. The modern bathroom offers a luxurious rain shower along with excellent built-in storage, ensuring practicality as well as comfort.

Outside your door, enjoy excellent public transport links as well as wonderful walking and cycling routes along the coast, perfect for those with an active lifestyle. With the council tax band set to A, this property promises affordability without compromising on style or space.

If you're looking for a beautifully presented home in a prime location with lots of storage and distinctive features, this end of terrace house ticks every box. Arrange your viewing today and imagine the possibilities this splendid home could offer you.

#### **GROUND FLOOR**

##### **ENTRANCE HALL**

Double-glazed composite entrance door | Staircase to first floor | Door to living room

##### **LIVING ROOM 15'1 x 14'8**

UPVC double-glazed entrance door | Radiator | Inglenook with living flame effect gas stove fire | Coving to ceiling | Open to dining kitchen

##### **DINING KITCHEN 18'2 x 10'3**

Dining area: UPVC double-glazed windows | Radiator | Coving to ceiling

Kitchen: UPVC double-glazed window and external door | Coving to ceiling | Part-tiled walls | Tiled floor | Radiator | Fitted units incorporating; Porcelain Belfast sink, Induction hob & extractor hood, integral electric oven, space for fridge-freezer, space for washing machine

**T: 01665 510044**

**E: [alnwick@rmsestateagents.co.uk](mailto:alnwick@rmsestateagents.co.uk)**

**ROOK  
MATTHEWS  
SAYER**





## LANDING

Loft access hatch | Storage cupboard | Doors to bedrooms and bathroom

## BEDROOM ONE 10'6 at widest point x 14'10

UPVC double-glazed window | Radiator | Double fitted cupboard with hanging rail and shelf | Coving to ceiling

## BEDROOM TWO 10'10 x 10'5

UPVC double-glazed window | Radiator | Coving to ceiling

## BEDROOM THREE 7'11 x 11'2 max into door recess, 7' min

UPVC double-glazed window | Radiator | Storage cupboard | Coving to ceiling

## BATHROOM 6'11 x 7'3

Bath with main rainfall-head shower and separate hand-held attachment, glass shower screen, porcelain tiled surround | Fitted cabinets with integrated wash-hand basin & W.C. with concealed cistern | Antique style radiator with heated towel rail | Shaver point | UPVC double-glazed frosted window | Extractor fan | Coving to ceiling | Porcelain tiled floor

## EXTERNALLY

Rear yard - pedestrian gate access to small yard with wall boundary

Score	Energy rating	Current	Potential
92+	A		
81-91	B		84 B
69-80	C		
55-68	D	63 D	
39-54	E		
21-38	F		
1-20	G		

## PRIMARY SERVICES SUPPLY

Electricity: Mains

Water: Mains

Sewerage: Mains

Heating: Mains gas central heating

Broadband: None installed

Mobile Signal Coverage Blackspot: No known issues

Parking: On-street

## MINING

The North East region is famous for its rich mining heritage and therefore it will be beneficial to conduct a mining search. Confirmation should be sought from a conveyancer as to its effect on the property, if any.

## HOLIDAY LET

While the agent believes the property is suitable for use as a holiday let, the agent cannot warrant or promise that the seller has let it as a holiday letting nor that it meets all the relevant legislation. Interested parties should make their own enquiries including asking questions about the seller's letting of the property and its compliance with the holiday letting laws. If necessary, independent professional advice should be obtained prior to making any decisions to view or otherwise.

## TENURE

Freehold – It is understood that this property is freehold, but should you decide to proceed with the purchase of this property, the Tenure must be verified by your Legal Adviser

## COUNCIL TAX BAND: A

## EPC RATING: D

AL009237/DM/DM/17.09.2025/V1 – Amended Price 02.02.2026 TB



T: 01665 510044

E: [alnwick@rmsestateagents.co.uk](mailto:alnwick@rmsestateagents.co.uk)

ROOK  
MATTHEWS  
SAYER



Approx Gross Internal Area  
88 sq m / 952 sq ft

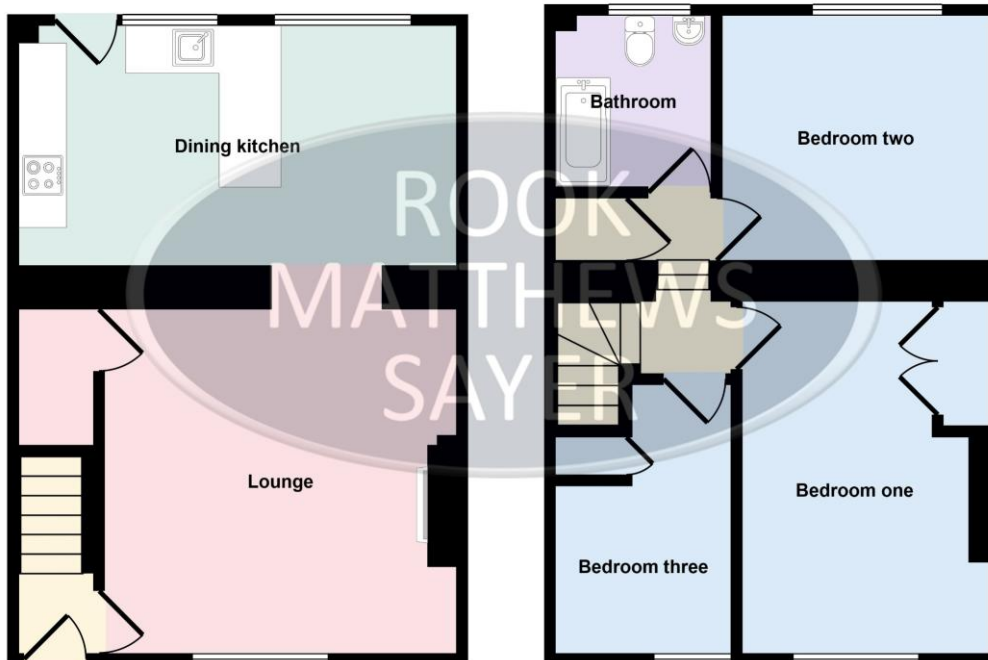

Ground Floor  
Approx 44 sq m / 470 sq ft

First Floor  
Approx 45 sq m / 482 sq ft

This floorplan is only for illustrative purposes and is not to scale. Measurements of rooms, doors, windows, and any items are approximate and no responsibility is taken for any error, omission or mis-statement. Icons of items such as bathroom suites are representations only and may not look like the real items. Made with Made Snappy 360.

AL009237 VERSION 1



**Important Note:** Rook Matthews Sayer (RMS) for themselves and for the vendors or lessors of this property, whose agents they are, give notice that these particulars are produced in good faith, are set out as a general guide only and do not constitute part or all of an offer or contract. The measurements indicated are supplied for guidance only and as such must be considered incorrect. Potential buyers are advised to recheck the measurements before committing to any expense. RMS has not tested any apparatus, equipment, fixtures, fittings or services and it is the buyer's interests to check the working condition of any appliances. RMS has not sought to verify the legal title of the property and the buyers must obtain verification from their solicitor. No persons in the employment of RMS has any authority to make or give any representation or warranty whatever in relation to this property.

**Money Laundering Regulations** – intending purchasers will be asked to produce original identification documentation at a later stage and we would ask for your co-operation in order that there will be no delay in agreeing the sale. We will also use some of your personal data to carry out electronic identity verification. This is not a credit check and will not affect your credit score.

