



Lupus Street  
London, SW1V

CHESTERTONS





Situated in the heart of Pimlico, this well-presented two-bedroom apartment offers an excellent opportunity to acquire a home in one of Central London's most sought-after residential locations.

The property comprises two double bedrooms, a bright and open plan comfortable reception room, a fitted kitchen, and a family bathroom. The apartment benefits from Share of Freehold and no onward chain.

Lupus Street is conveniently located for the shops, cafes and restaurants of Pimlico, the river Thames and nearby Battersea Park. The nearest transport can be found at Pimlico (Victoria underground line) and Victoria station (Victoria, Circle and District lines, Mainline station and Gatwick Express).

- Well-presented two-bedroom apartment situated in the heart of Pimlico
- Comprises two double bedrooms, a bright and spacious open-plan reception room
- Benefits from a Share of Freehold
- Offered to the market with no onward chain, enabling a straightforward purchase process.
- Ideally located close to the shops, cafés, and restaurants of Pimlico, River Thames and Battersea Park.
- Excellent transport links via Pimlico Underground Station

Asking Price £645,000

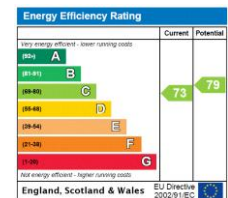

**Tenure:** Share of Freehold 75 years 7 months  
**Service Charge:** £3,062 Per Annum (Approximately)  
**Ground Rent:** No Ground Rent  
**Local Authority:** Westminster  
**Council Tax Band:** F

*Chestertons Westminster & Pimlico Sales*

105 Wilton Road  
 London  
 SW1V 1DZ  
 westminster@chestertons.co.uk  
 020 3040 8201  
 chestertons.co.uk

# Lupus Street, SW1V

Approximate Gross Internal Area  
50.74 sq m / 546 sq ft

( CH = Ceiling Heights )

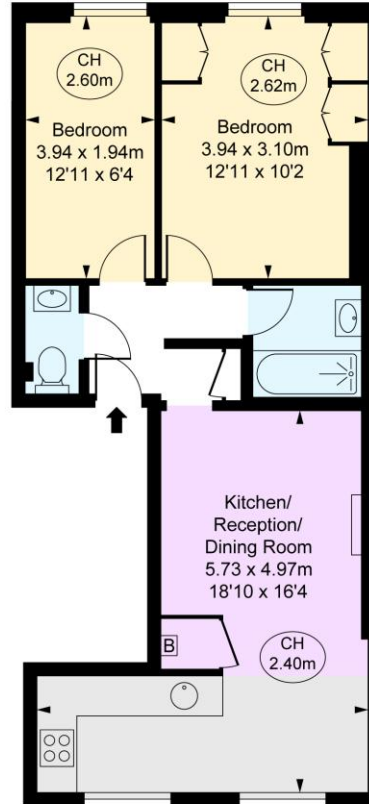

Second Floor



This plan is not to a given scale. A detailed layout plan to scale for valuation is available on request. All measurements and areas are within 1% tolerance and have been prepared in accordance with industry standards as defined in theRICS Code of Measuring Practice  
© Fulham Performance

Chesterton UK Services Limited trading as Chestertons for themselves and for the vendor of this property whose agents they are, give notice that (i) these particulars do not constitute any part of an offer or contract, (ii) all statements contained within these particulars are made without responsibility on the part of Chestertons or the vendor, (iii) whilst made in good faith, none of the statements contained within these particulars are to be relied upon as a statement or representation of fact, (iv) any intending purchasers must satisfy themselves by inspection or otherwise as to the correctness of each of the statements contained within these particulars, (v) the vendor does not make or give either Chestertons or any person in their employment any authority to make or give representation or warranty whatsoever in relation to this property. Wide angle lenses may be used. ©Copyright Chestertons | Chesterton UK Services Limited | Registered Office 5th Floor, The Lantern, 75 Hampstead Road, London, NW1 2PL Registered Company Number 05334580.



This paper is  
100% recyclable