



TAYLOR
MICHAEL
SALES & LETTINGS

3 Bed
Maisonette
located in

£2,150



TAYLOR
MICHAEL

New Church Road, Hove, BN3 4EE

Approximate Gross Internal Area = 117.4 sq m / 1264 sq ft



DIRECTIONS

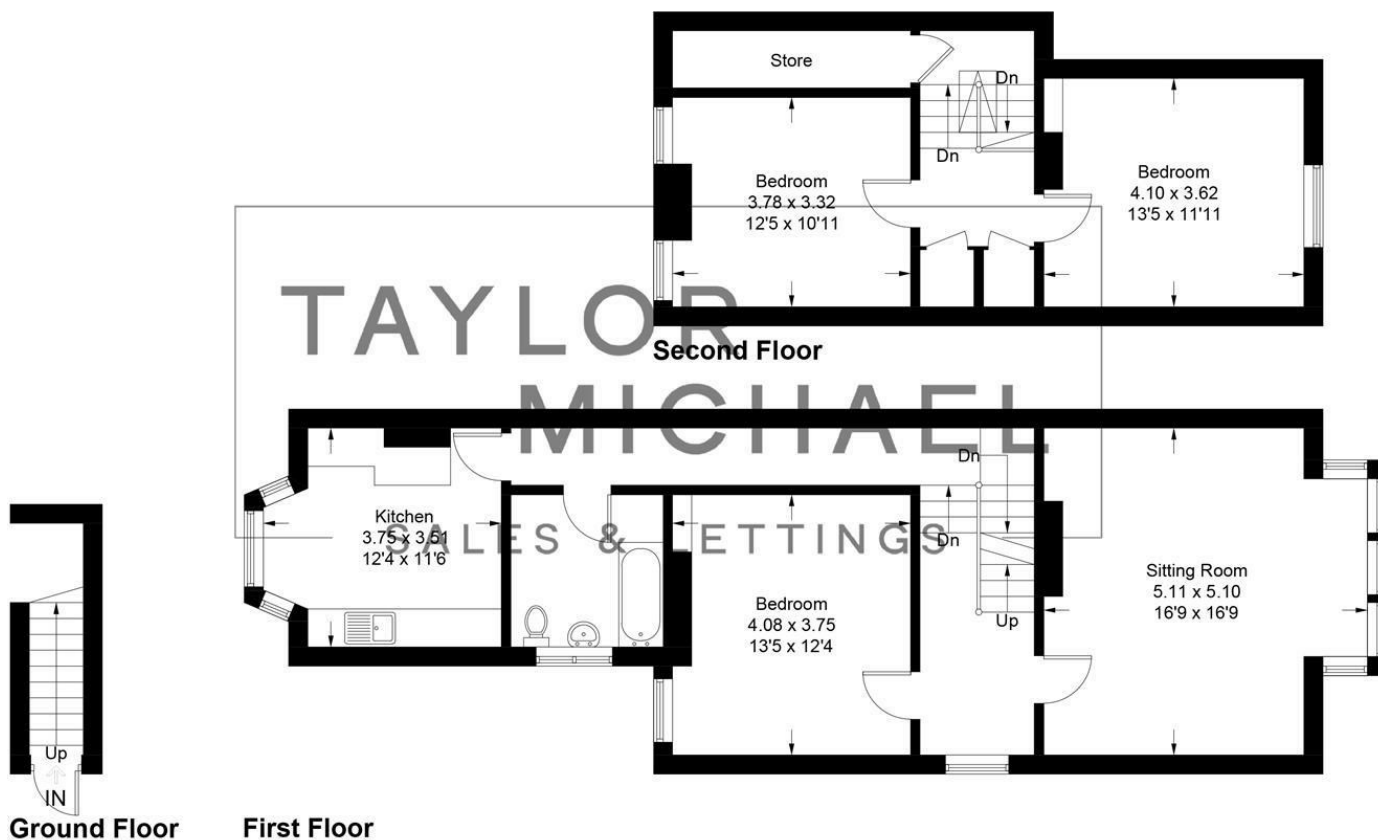

Illustration for identification purposes only, measurements are approximate, not to scale.
Imageplansurveys @ 2026

Energy Efficiency Rating		Current	Potential
Very energy efficient - lower running costs			
(92 plus)	A		
(81-91)	B		
(69-80)	C		79
(55-68)	D		
(39-54)	E	43	
(21-38)	F		
(1-20)	G		
Not energy efficient - higher running costs			
England & Wales		EU Directive 2002/91/EC	

CONTACT

62 Church Road
Hove
East Sussex
BN3 2FP

E: lettings@taylormichael.agency
T: 01273 600100
<https://taylormichael.agency/>

TAYLOR
MICHAEL