



Bryant Road | | Rochester | ME2 3EW

Asking price £325,000



Bryant Road |
Rochester | ME2 3EW
Asking price £325,000

A beautifully renovated three-bedroom period terraced home, finished to an exceptional standard and offered with no onward chain. The current owners have completed a comprehensive, high-quality refurbishment, including a new boiler, full electrical rewire, new double glazing, and new front and rear doors, creating a true turnkey property.

The home blends character and contemporary living, beginning with a striking entrance hallway featuring William Morris designer wallpaper. The front living room offers a cosy retreat with an open fireplace, while to the rear sits a bespoke, hand-built kitchen, hand-painted in Farrow & Ball 'Lichen', flowing into a practical utility room with space for multiple appliances. A stylish ground-floor bathroom with a large walk-in shower completes the level.

- Chain Free
- New Boiler and Windows throughout
- Loft Conversion
- 2 Bathrooms
- Basement Conversion
- Walking distance to nurseries and schools
- Ideal family home
- Walking distance to shops and Strood and Rochester Station
- Viewing recommended

Living Room

12'9" x 11'6" (3.88m x 3.50m)

Kitchen/Diner

14'1" x 10'10" (4.30m x 3.31m)

Utility Room

10'11" x 8'1" (3.32m x 2.46m)

Bedroom 1

14'6" x 11'1" (4.42m x 3.38m)

Bedroom 2

10'11" x 6'10" (3.32m x 2.08m)

Shower Room

8'1" x 8'1" (2.47m x 2.46m)

Bedroom 3

14'1" x 11'1" (4.30m x 3.37m)

Front Exterior

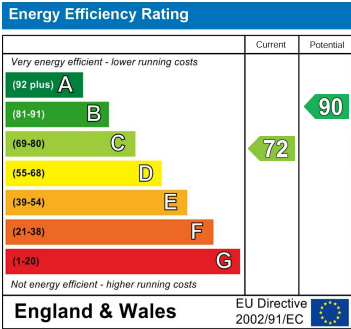
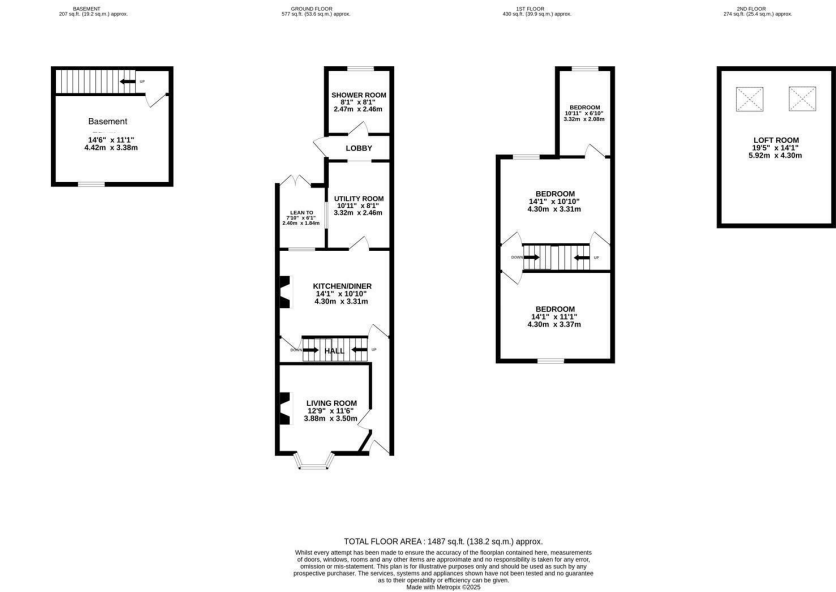

2B Crow Lane

Rochester

Kent

ME1 1RF

01634 829080

admin@machin-lane.co.uk

https://www.machin-lane.co.uk/