



**POOLE  
TOWNSEND**

# Holbeck Park Avenue, Barrow-in-furness, LA13 0RG

£185,000

🛏️ 2 🚿 1 🚗 1



- 2 Bed Detached Bungalow
- Close To Local Amenities
- No Onward Chain
- Driveway Parking
- Well-established Gardens To The Front & Rear
- A Spacious Lounge-Dining Room
- A Fitted Kitchen
- Two Double Bedrooms
- A Bright Glazed Garden Room Extension
- Ideal For Someone Looking To Modernise



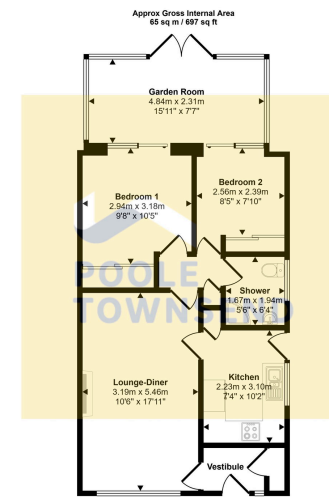

Floorplan

This floorplan is only for illustrative purposes and is not to scale. Measurements of rooms, doors, windows, and any items are approximate and no responsibility is taken for any error, omission or mis-statement. Icons of items such as bathroom suites are representations only and may not look like the real items. Made with Made Snappy 360.

Detached two-bedroom bungalow in the popular Holbeck area, ideally located on a local bus route and close to Yarlside Academy, the Crofters pub and a nearby children’s play area. The property enjoys attractive, well-established gardens to the front and rear, including lawned areas, mature trees, borders, greenhouse, shed, and a rear decked seating space, along with driveway parking. Inside, an entrance hall with cloaks cupboard leads to a spacious lounge-dining room overlooking the front garden, a fitted kitchen with dark oak-style units, integrated oven and hob, plumbing for washing machine and external access, and an inner hallway providing access to two double bedrooms both with fitted wardrobes. There is also a shower room with WC, basin and shower cubicle, and a bright glazed garden room extension opening onto the rear decking from both bedrooms. Requiring general modernisation and redecoration, the property offers excellent potential and is sold

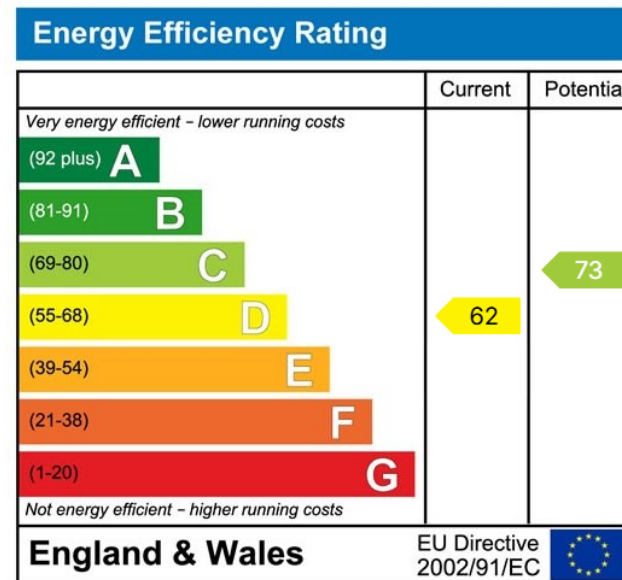

Visit us at  
[www.pooletownsend.co.uk](http://www.pooletownsend.co.uk)  
[enquiries@pooletownsend.co.uk](mailto:enquiries@pooletownsend.co.uk)

We are open  
 Monday – Friday 9.00 – 5.00  
 Saturday 9.00 – 1.00

Barrow 01229 811811  
 Ulverston 01229 588111  
 Grange 015395 33316  
 Kendal 01539 734455  
 Milnthorpe 015395 62044