



## Flat 2, 11 Hampshire Terrace

, Portsmouth, PO1 2QY

**£1,200 Per month**

Two Double Bedrooms | Available 7th August 2026 |  
Unfurnished | Residents Parking and Bike Store Available |  
Duplex Flat | Gas Central Heating | Southsea Location | Close  
to all Major Transport Links | Viewings from 14th July 2026.

- Two Double Bedrooms With Built In Storage
- Top Floor, Light Bright & Spacious, Duplex Flat
- UNFURNISHED with white goods included - AVAILABLE AUGUST 7th 2026
- Gas Central Heating
- Residents Parking and Bike Store Available
- Beautifully presented with original Georgian features
- Close to Seaside, Gunwharf Quays and all major transport links; Ferries, Trains, Buses & Motorway Links
- Plenty of Shops & Eateries Close By
- GRADE II LISTED BUILDING
- Viewings from 14th July 2026 due to tenants still in situ

Please contact our ROK Marsh Office on 02393233267  
if you wish to arrange a viewing appointment for this property or  
require further information.



# Floor Plan

# Area Map

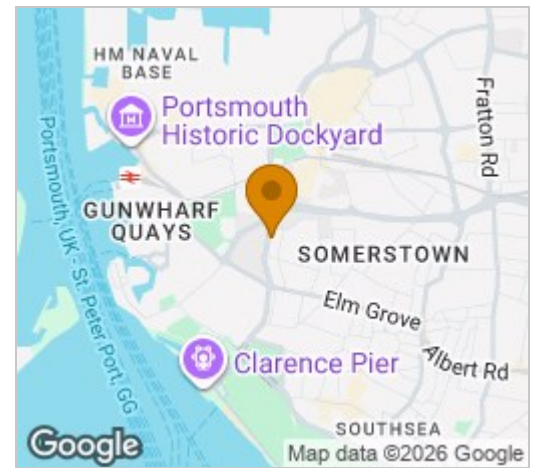
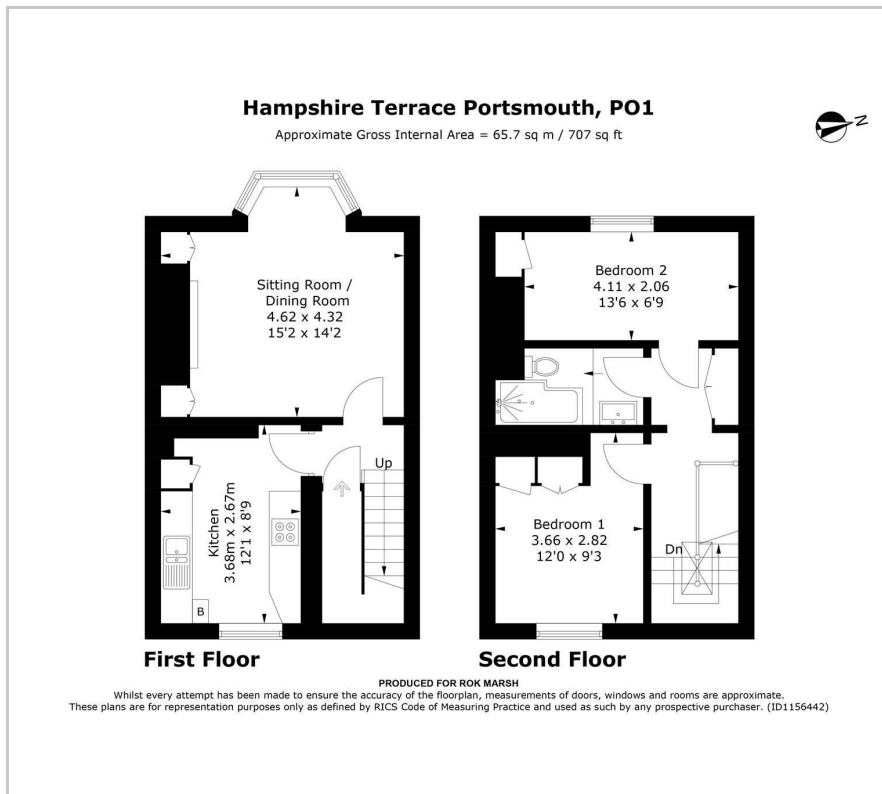

# Energy Efficiency Graph

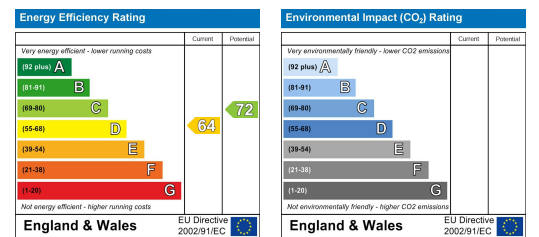

These particulars, whilst believed to be accurate are set out as a general outline only for guidance and do not constitute any part of an offer or contract. Intending purchasers should not rely on them as statements of representation of fact, but must satisfy themselves by inspection or otherwise as to their accuracy. No person in this firm's employment has the authority to make or give any representation or warranty in respect of the property.