

# TATES

020 7602 6020



## Balmoral House, Windsor Way, London W14 0UE

**£2,150 Per month**

- One Bedroom
- Modern Fitted Kitchen and Bathroom
- Furnished
- Brook Green
- Short walk to Hammersmith tube station
- Gated Development
- Available Early July
- 24 Hour Porter
- Close To Barons Court tube station
- Energy Efficiency Rating Current Band: B

Balmoral House,  
Windsor Way, W14  
Approx. Gross Internal Area  
565 Sq Ft - 52.49 Sq M

Garage  
Approx. Gross Internal Area  
129 Sq Ft - 11.98 Sq M

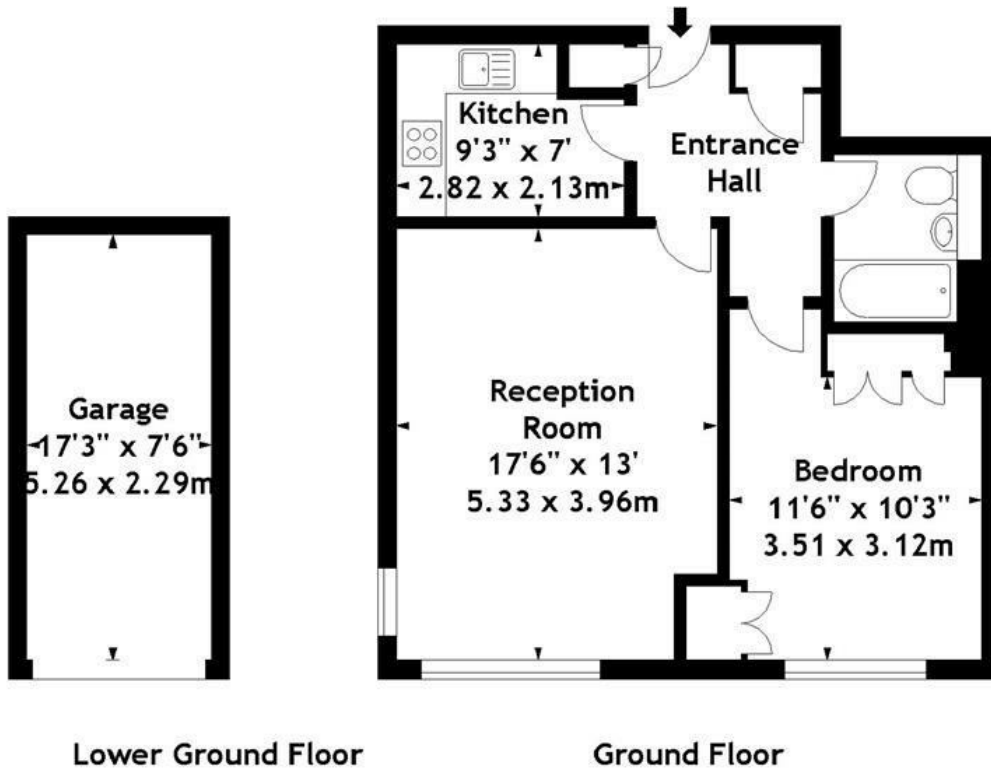

Measured in accordance with RICS guidelines. Every attempt is made to ensure accuracy, however all measurements are approximate. This floor plan is for illustrative purposes only and is not to scale.

© Datography UK Ltd 2008  
Photographs \* Floorplans \* Virtual Tours  
Tel: 08707 66 30 30 www.datography.com

Whilst these particulars are produced in good faith and are believed to be correct, no guarantee is given, nor any responsibility accepted, by Tates nor by any of its representatives, for their accuracy. The particulars do not constitute part of any offer or contract, and it is recommended that such things as measurements, condition, structure, services, appliances, fixtures and fittings and facilities are all independently assessed by the prospective purchaser or renter of the subject property prior to committing to any contract.

Energy Efficiency Rating		
	Current	Potential
Very energy efficient - lower running costs		
(92 plus) <b>A</b>		
(81-91) <b>B</b>		
(69-80) <b>C</b>	79	79
(55-68) <b>D</b>		
(39-54) <b>E</b>		
(21-38) <b>F</b>		
(1-20) <b>G</b>		
Not energy efficient - higher running costs		
England & Wales		EU Directive 2002/91/EC

135 Hammersmith Road, West Kensington, London W14 0QL    mail@tatesestates.co.uk    tatesestates.co.uk

Tates (Agents) Ltd. Registered in England and Wales No. 02356337  
Registered Office: Imperial House, 8 Keane Street, London WC2B 4AS

