



WESTCOMBE PARK ROAD, SE3

£365,000

One bedroom apartment

First floor

Immaculate condition

Share of freehold

Private balcony

Energy rating: e



ABOUT THE PROPERTY

Refurbished and immaculate first floor apartment including a share of freehold, residents only garden to the rear, and an en-bloc garage. The interior comprises a large dual aspect bedroom, a modern bathroom suite, spacious living room offering direct access to a private balcony and a good size kitchen, benefitting from some integrated appliances and a breakfast bar. Added features include wood flooring and an infrared heating system.

This property is well positioned for Blackheath standard, and also within walking distance to Maze Hill and Westcombe Park stations. Greenwich town centre, for the covered market, the royal park, Greenwich pier and the Cutty Sark DLR station are a short bus ride away.



STEP INSIDE WESTCOMBE PARK ROAD

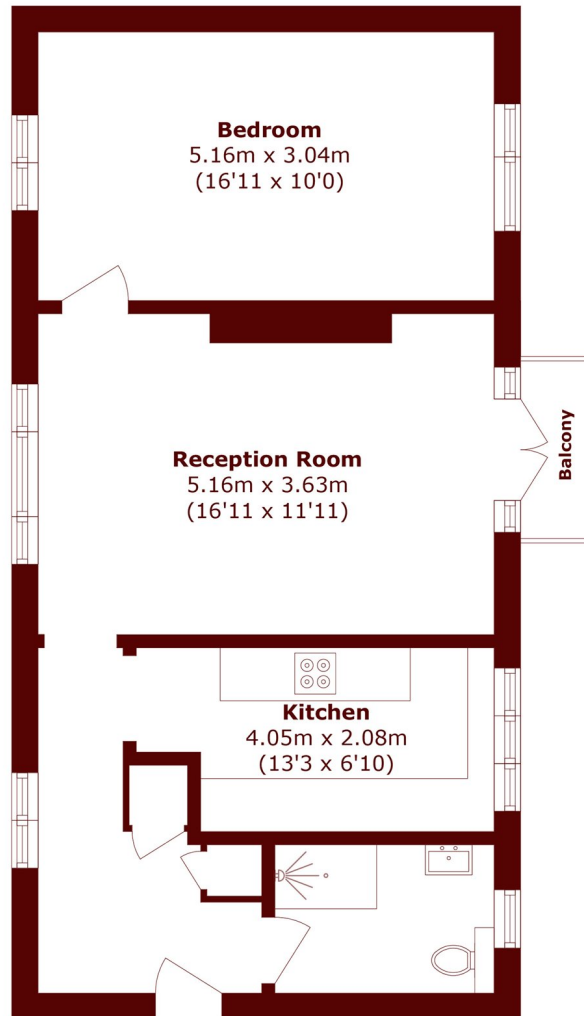

Total area (approx.): 56.1 sq. m (603.8 sq. ft)

Balcony area (approx.): 1.7 sq. m (18.2 sq. ft)

Greenwich
020 8312 8312

Energy Rating: E We aim to make our particulars both accurate and reliable. However, they are not guaranteed; nor do they form part of an offer or contract. If you require clarification on any points then please contact us, especially if you're traveling some distance to view. Please note that appliances and heating systems have not been tested and therefore no warranties can be given as to their good working order

**MARSH &
PARSONS**