



**Connells**

Sunset View Old Lyndhurst Road  
Cadnam Southampton



# Sunset View Old Lyndhurst Road Cadnam Southampton SO40 2NL

for sale offers over  
**£550,000**



## Property Description

Sunset View is a charming and well-appointed detached home situated in the sought-after village of Cadnam. The welcoming entrance hall features herringbone LVT flooring, a cloakroom, and under-stairs storage. The lounge boasts a wood burner, dual aspect windows with shutters, and elegant flooring. A modern kitchen offers granite worktops, integrated appliances, and direct garden access. Upstairs, three bedrooms include built-in storage and contemporary finishes, while the bathroom provides a freestanding bath and walk-in shower. Outside, the front offers a block-paved driveway, lawn, and garage access. The rear garden enjoys a sunny south-westerly aspect with lawn, patio, mature borders, and side access. This home blends modern style with village living, ideal for families and commuters alike.

## Entrance Hall

Welcoming space with herringbone LVT wood flooring, UPVC front door with obscured double-glazed side window, carpeted stairs rising to the first floor, and under-stairs storage. Provides access to the cloakroom and principal reception areas.

## Cloakroom

Fitted with WC and hand wash basin, localised tiled splashbacks, oak veneered door, obscured side window, and practical layout for guests.

## Living Room

12' 7" x 14' 4" ( 3.84m x 4.37m )

A bright dual-aspect reception room with double-glazed windows to front and side, both with fitted shutters. Stylish herringbone LVT flooring, feature wood burner, TV point, inset lighting, radiator, and a glazed oak-veneered door leading to the hall.

## Kitchen

21' x 8' 6" ( 6.40m x 2.59m )

Modern in design with a wide range of wall, base, and drawer units, granite work surfaces, and herringbone LVT flooring. Integrated double oven, four-ring induction hob with extractor, inset sink with mixer tap, and tall radiator. Patio doors open to the garden, with additional windows to side and rear for maximum light.

## Landing

Carpeted, with built-in cupboards, side window, and loft access.

## Principle Bedroom

12' 6" x 13' 9" ( 3.81m x 4.19m )

Generous double with front-facing double-glazed window and shutters, carpeted flooring, radiator, and inset lighting.

## Bedroom Two

11' 3" x 8' 6" ( 3.43m x 2.59m )

Rear-facing double with double-glazed

window, wood laminate flooring, and radiator.

**Bedroom Three**

9' 7" x 7' 1" max ( 2.92m x 2.16m max )

Front-facing with built-in storage, wood laminate flooring, double-glazed window with shutters, and inset lighting.

**Bathroom**

11' 5" x 6' 2" ( 3.48m x 1.88m )

Luxurious suite with freestanding bath, double walk-in shower, vanity unit with inset sink, wood laminate flooring, localised tiling, and obscured rear window.

**Outside**

**Front Garden**

Block-paved driveway for multiple vehicles, lawn with mature borders, and access to the garage.

**Rear Garden**

South-westerly facing and mainly laid to lawn with mature shrubs, paved patio, pathway, and side access to the front.

**Garage**

18' 2" x 9' 6" ( 5.54m x 2.90m )

Up-and-over door, lighting, and power.

**Location**

Cadnam is a friendly New Forest village with

excellent amenities and swift road links via the M27 to Southampton, Winchester, and Bournemouth. Families benefit from nearby schools including Copythorne C of E Infant School (Ofsted "Good") and Bartley C of E Junior School ("Good"), with popular secondary options in Totton and Romsey. The area offers a strong community spirit, local pubs, village shops, and easy access to miles of scenic woodland walks. The New Forest National Park is on the doorstep, providing cycling, riding, and outdoor activities, while larger supermarkets and retail parks are within a short drive.

**Agents Notes**

The property has been maintained to a high standard and offers an ideal balance between stylish interiors and practical family living. Cadnam provides an excellent base for commuters and outdoor enthusiasts alike, with the New Forest on the doorstep and superb transport links nearby. Viewing is highly recommended to appreciate the space, light, and location on offer.









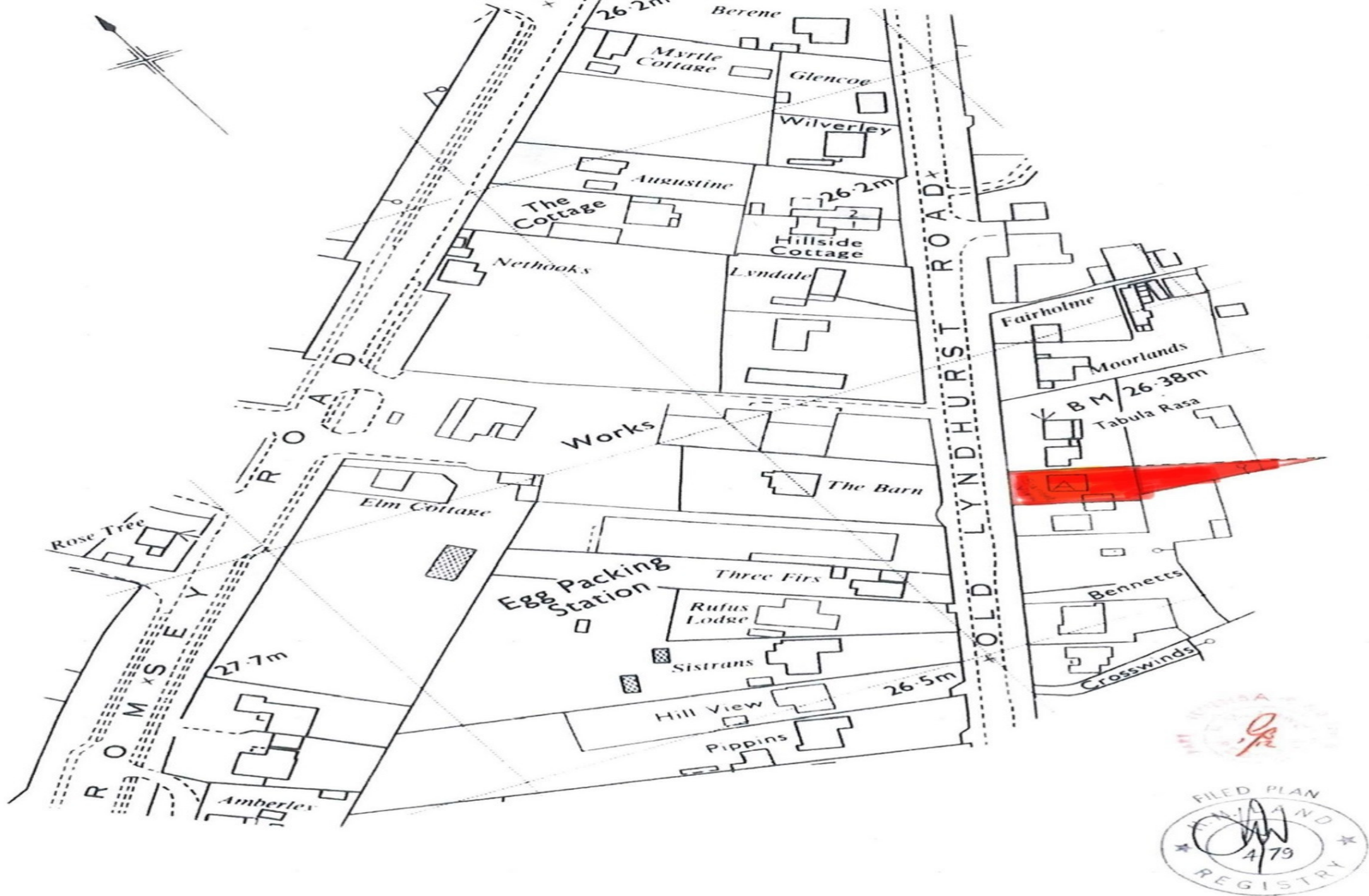

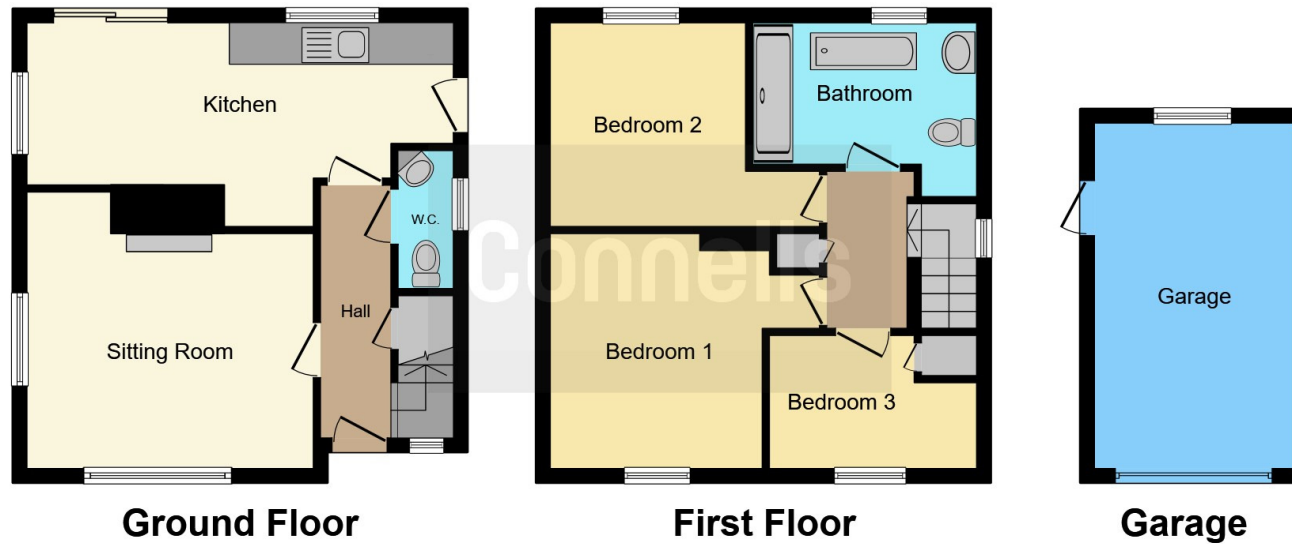

This floor plan is for illustrative purposes only. It is not drawn to scale. Any measurements, floor areas (including any total floor area), openings and orientation are approximate. No details are guaranteed, they cannot be relied upon for any purpose and they do not form part of any agreement. No liability is taken for any error, omission or misstatement. A party must rely upon its own inspection(s). Powered by [www.focalagent.com](http://www.focalagent.com)

To view this property please contact Connells on

**T 01794 830 833**  
**E [romsey@connells.co.uk](mailto:romsey@connells.co.uk)**

13a The Hundred  
 ROMSEY SO51 8GD

EPC Rating: D Council Tax  
 Band: E

Tenure: Freehold

**view this property online [connells.co.uk/Property/ROM306758](http://connells.co.uk/Property/ROM306758)**



1. MONEY LAUNDERING REGULATIONS Intending purchasers will be asked to produce identification documentation at a later stage and we would ask for your co-operation in order that there will be no delay in agreeing the sale. 2. These particulars do not constitute part or all of an offer or contract. 3. The measurements indicated are supplied for guidance only and as such must be considered incorrect. Potential buyers are advised to recheck measurements before committing to any expense. 4. We have not tested any apparatus, equipment, fixtures, fittings or services and it is in the buyers interest to check the working condition of any appliances.

Connells Residential is registered in England and Wales under company number 1489613, Registered Office is Cumbria House, 16-20 Hockliffe Street, Leighton Buzzard, Bedfordshire, LU7 1GN. VAT Registration Number is 500 2481 05.

**See all our properties at [www.connells.co.uk](http://www.connells.co.uk) | [www.rightmove.co.uk](http://www.rightmove.co.uk) | [www.zoopla.co.uk](http://www.zoopla.co.uk)**

Property Ref: ROM306758 - 0012