

**Bellefields Road, Brixton, SW9**

2 bedroom maisonette for sale

**£600,000**

Share of Freehold

## Property Details

A striking two double bedroom split-level maisonette with a private roof terrace and its own entrance, set within an attractive Victorian property in the heart of Brixton's sought-after Low Traffic Neighbourhood. Thoughtfully designed to a high standard, this stylish home blends contemporary design with period charm. Stone steps lead to a private raised ground floor entrance, opening into a welcoming hallway. The stairwell ascends gracefully, enhanced by glass balustrades and natural light from multiple landings. The first floor hosts a bright reception with sash windows, high ceilings, and wooden flooring. Glass doors lead into a modern kitchen-diner with colourful tiling and sleek units, enhanced by a stunning glass feature wall. A private roof terrace offers an ideal al-fresco retreat. The top floor comprises two generous double bedrooms with fitted storage and charming views, plus hallway and loft storage. This elegant home offers exceptional light, space, and privacy.

## Features

- Two double bedrooms
- Roof terrace
- Victorian maisonette
- Own private entrance
- Stylish split-level flat
- Over 850 square feet
- Sought-after location
- Close to all that vibrant Brixton has to offer
- Victoria line at Brixton tube a four-minute stroll
- Chain-free. Share of freehold.

Council tax band D    EPC rating D (66)





Bellefields Road, Brixton, SW9

**Bellefields Road, SW9**  
**2 Bedroom Flat**

APPROXIMATE GROSS INTERNAL AREA: **858 SQ FT / 79.7 SQ M**

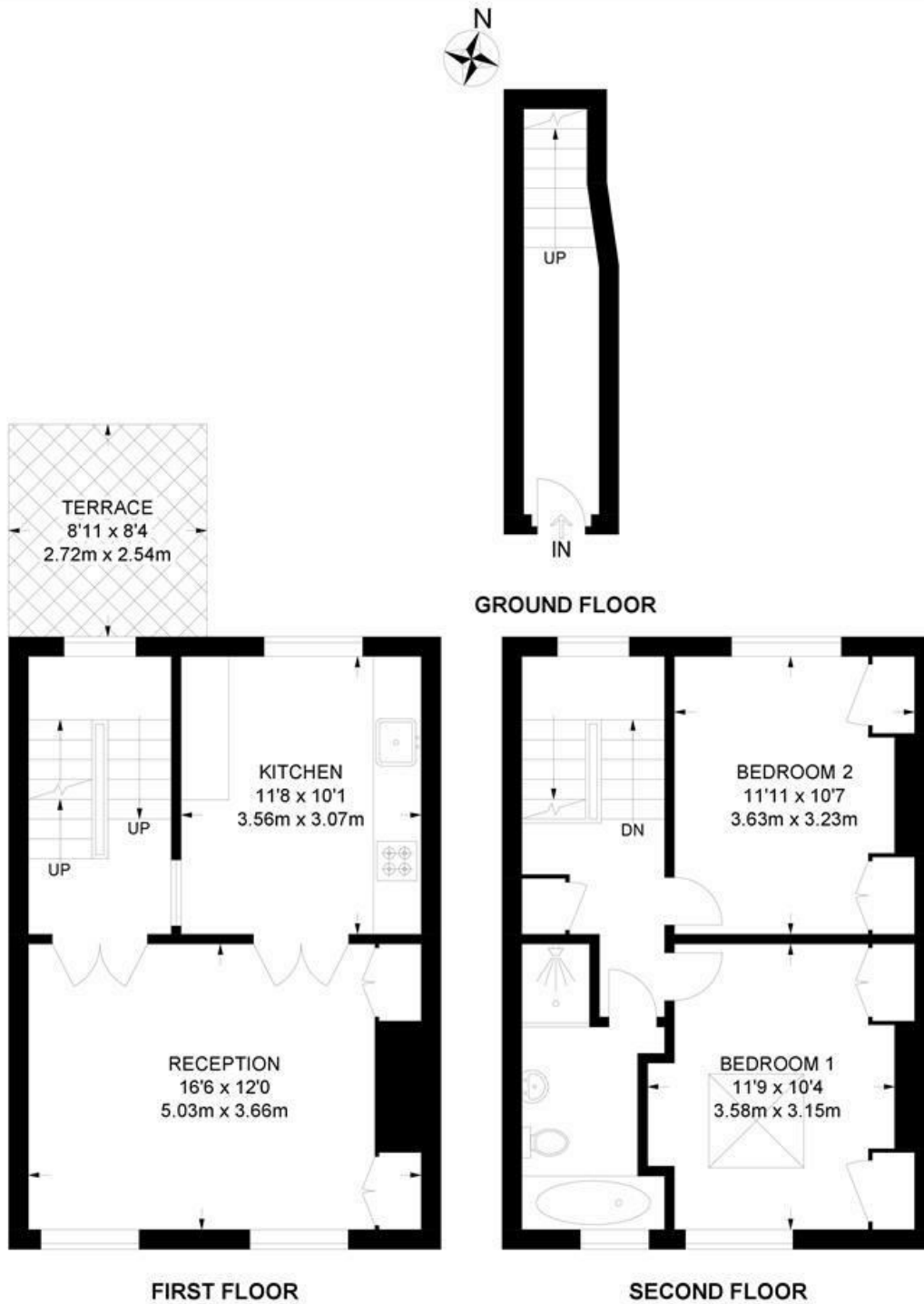

While we try our very best, floor plans are produced as a guide only and we take no responsibility for the precise accuracy with which any property is represented.

Bellefields Road, Brixton, SW9

