

TILSON GARDENS, SW2

£2,750 PCM

- Three Double Bedrooms
- One Reception
- Modern Kitchen
- Ground Floor Flat
- 0.8 Miles From Clapham South
- Parr Furnished





ABOUT THE HOME

Modern three bedroom ground floor flat ideally located between Brixton and Clapham comprising open plan reception/dining room, three double bedrooms, fitted kitchen and bathroom with shower over bath and separate WC.

Tilson Gardens is located 0.8 miles from Clapham South underground station providing access to the Northern Line.





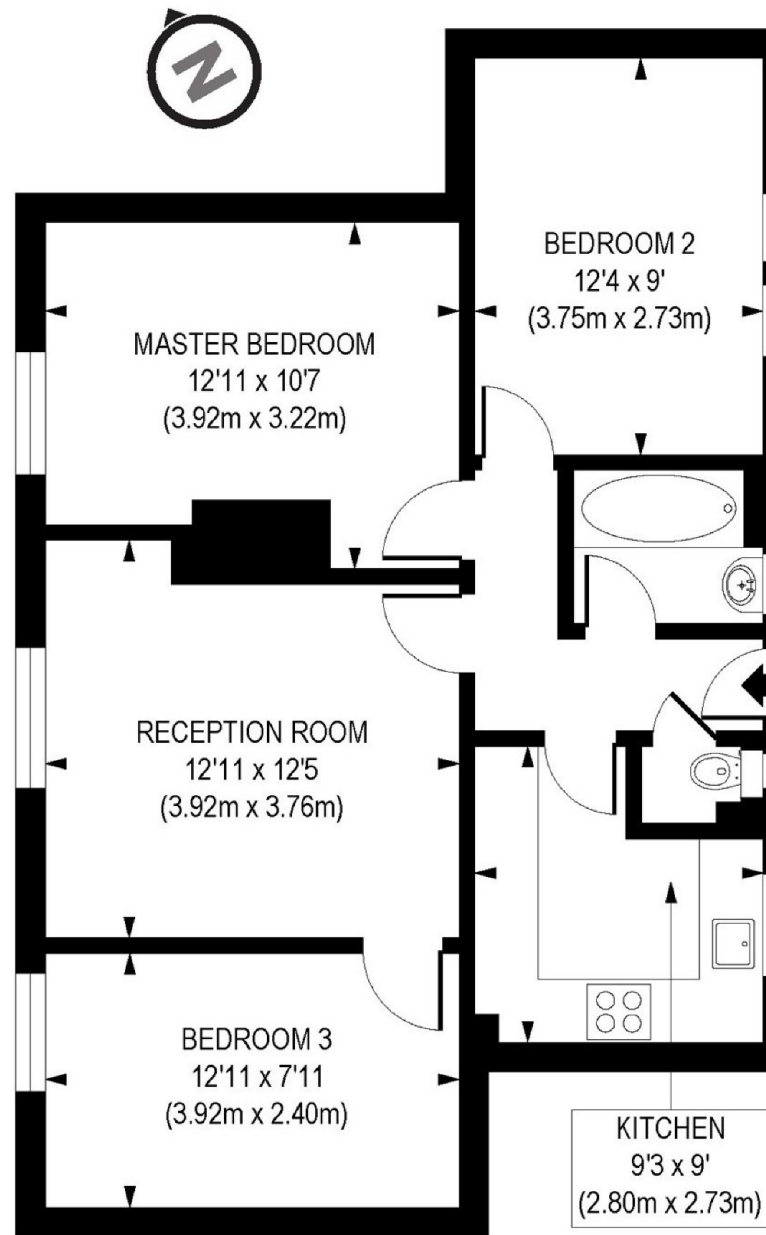

Floorplan is for illustrative purposes only and is not to scale.
Every attempt has been made to ensure the accuracy of the floorplan shown, however all measurements, fixtures, fittings and data shown are an approximate interpretation for illustrative purposes only.
Liability for errors, omissions or mis-statement through negligence or otherwise is hereby excluded.

JACKSONS CLAPHAM

73 Abbeville Road, London,
SW4 9JN
Sales: 020 8487 3177
Lettings: 020 8487 3178

Energy Rating: B We aim to make our particulars both accurate and reliable. However they are not guaranteed; nor do they form part of an offer or contract. If you require clarification on any points then please contact us, especially if you're traveling some distance to view. Please note that appliances and heating systems have not been tested and therefore no warranties can be given as to their good working order.