



SHELGATE ROAD, SW11

£650,000

Two Double Bedrooms
Victorian
Large Private Garden
Extension Potential
Excellent Condition
Share Of Freehold

@marshandparsons
marshandparsons.co.uk

MARSH &
PARSONS



ABOUT THE PROPERTY

This two double bedroom apartment, centrally positioned Between the Commons, has undergone extensive refurbishment throughout, with potential to extend STPP, this flat benefits from a large private south facing garden and a share of freehold.

Shelgate Road is perfectly located to benefit from all of the local amenities of Northcote Road. There is a fantastic choice of local bars, cafés and restaurants at your doorstep, whilst Clapham Junction station is just a short walk away, providing easy access in and outside of London.



STEP INSIDE SHELGATE ROAD

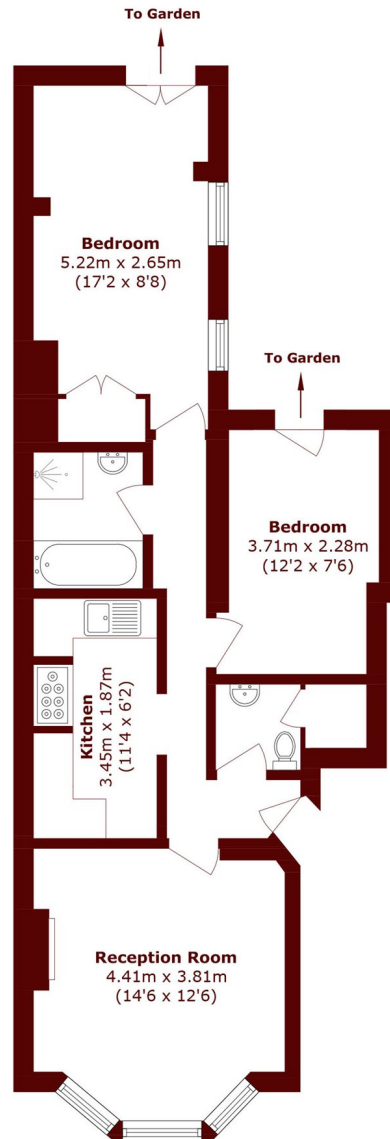

Total (approx.): 59.0 sq. m (635.0 sq. ft)

Battersea
020 7326 9920

Energy Rating: C We aim to make our particulars both accurate and reliable. However, they are not guaranteed; nor do they form part of an offer or contract. If you require clarification on any points then please contact us, especially if you're traveling some distance to view. Please note that appliances and heating systems have not been tested and therefore no warranties can be given as to their good working order

**MARSH &
PARSONS**