

Hampshire Road

Derby, DE21 4EG

John German



Hampshire Road

Derby, DE21 4EG

£110,000

Mid town house with two double bedrooms located on a main bus route making it a great location for commuters perfect for first time buyers or investors, with scope for cosmetic improvement.

NO UPWARD CHAIN

Entrance to the property is via the front entrance lobby with stairs rising to the first floor and door into the lounge. The nicely proportioned lounge has a uPVC double glazed picture window to the front and a door leading to the kitchen/diner.

The kitchen area is fitted with a range of matching wall and base units incorporating a sink with drainer and an oven and hob with hood. There is a uPVC double glazed window to the rear elevation and a uPVC door leading to the rear garden. There is space at the opposite end of the room for dining with a small breakfast bar and a built-in understairs cupboard.

On the first floor a central landing has doors leading off to the bedrooms and the bathroom. The bathroom is fitted with a full three piece suite comprising low flush WC, wash hand basin and panelled bath with shower over. There is a uPVC window to the rear elevation.

The main bedroom is a great size with two uPVC double windows to the front and a small built in storage cupboard. Bedroom two has a uPVC double glazed window to the rear.

Outside, steps lead up from pavement level to a sloping lawned front garden with a shared passage to the side leading to gated access to the rear garden which has steps up to a lawn with a further raised garden area at the rear.

Tenure: Freehold (purchasers are advised to satisfy themselves as to the tenure via their legal representative).

Please note: It is quite common for some properties to have a Ring doorbell and internal recording devices.

Property construction: Traditional

Parking: On road

Electricity supply: Mains

Water supply: Mains

Sewerage: Mains

Heating: Mains gas

(Purchasers are advised to satisfy themselves as to their suitability).

Broadband type: See Ofcom link for speed: <https://checker.ofcom.org.uk/>

Mobile signal/coverage: See Ofcom link <https://checker.ofcom.org.uk/>

Local Authority/Tax Band: Derby City Council / Tax Band A

Useful Websites: www.gov.uk/government/organisations/environment-agency

Our Ref: JGA/15052026

The property information provided by John German Estate Agents Ltd is based on enquiries made of the vendor and from information available in the public domain. If there is any point on which you require further clarification, please contact the office and we will be pleased to check the information for you, particularly if contemplating travelling some distance to view the property. Please note if your enquiry is of a legal or structural nature, we advise you to seek advice from a qualified professional in their relevant field.

We are required by law to comply fully with The Money Laundering Regulations 2017 and as such need to complete AMLID verification and proof / source of funds checks on all buyers and, where relevant, cash donors once an offer is accepted on a property. We use the Checkboard app to complete the necessary checks, this is not a credit check and therefore will have no effect on your credit history. With effect from 1st March 2025 a non-refundable compliance fee of £30.00 inc. VAT per buyer / donor will be required to be paid in advance when an offer is agreed and prior to a sales memorandum being issued.





GROUND FLOOR

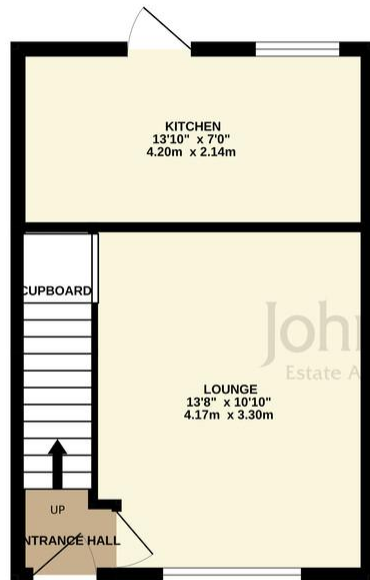

1ST FLOOR

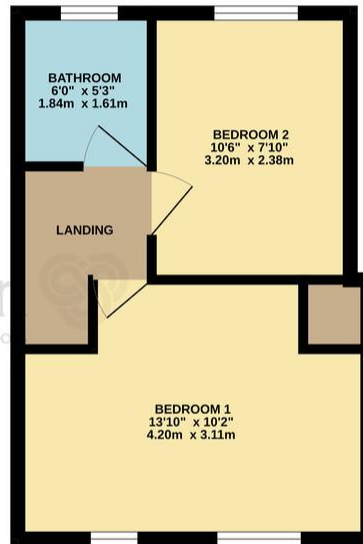

John German
Estate Agents & Chartered Surveyors

Whilst every attempt has been made to ensure the accuracy of the floorplan contained here, measurements of doors, windows, rooms and any other items are approximate and no responsibility is taken for any error, omission or mis-statement. This plan is for illustrative purposes only and should be used as such by any prospective purchaser. The services, systems and appliances shown have not been tested and no guarantee as to their operability or efficiency can be given.
Made with Metropix ©2020

Agents' Notes

These particulars do not constitute an offer or a contract neither do they form part of an offer or contract. The vendor does not make or give and Messrs. John German nor any person employed has any authority to make or give any representation or warranty, written or oral, in relation to this property. Whilst we endeavour to make our sales details accurate and reliable, if there is any point which is of particular importance to you, please contact the office and we will be pleased to check the information for you, particularly if contemplating travelling some distance to view the property. None of the services or appliances to the property have been tested and any prospective purchasers should satisfy themselves as to their adequacy prior to committing themselves to purchase.

Referral Fees

Mortgage Services - We routinely refer all clients to APR Money Limited. It is your decision whether you choose to deal with APR Money Limited. In making that decision, you should know that we receive on average £60 per referral from APR Money Limited.

Conveyancing Services - If we refer clients to recommended conveyancers, it is your decision whether you choose to deal with this conveyancer. In making that decision, you should know that we receive on average £150 per referral.

Survey Services - If we refer clients to recommended surveyors, it is your decision whether you choose to deal with this surveyor. In making that decision, you should know that we receive up to £90 per referral.

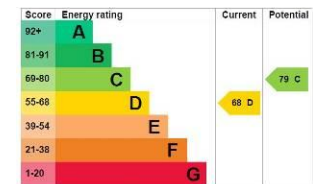

John German

Suite 3, The Mill, Lodge Lane, Derby, Derbyshire, DE13HB

01332 943818

derby@johngerman.co.uk

Ashbourne | Ashby de la Zouch | Barton under Needwood
Burton upon Trent | Derby | East Leake | Lichfield
Loughborough | Stafford | Uttoxeter

JohnGerman.co.uk Sales and Lettings Agent

