



**Premier
Properties**
Perth



The Range Heughfield Road, Perth, PH2 9BH Offers Over £500,000

 4  2  nu  C

The layout of the property is thoughtfully designed throughout, as you enter, you are welcomed into a bright and spacious living room, which follows through into the dining room, a great space for those who love to host! The well-appointed kitchen provides ample room for culinary adventures, whilst also having access to the adjoining dining area. There are two generously sized bathrooms allowing daily tasks to be at ease.

There is a separate family room, with access out to the front of the property, a perfect space for larger families. With four generously sized bedrooms and one further benefiting from an en suite, there is plenty of space for everyone to enjoy their own sanctuary. The property boasts a study, great for those who work from home, a utility area and a W.C completing the home.

The Property has extensive garden grounds, offering a tranquil space to unwind or enjoy outdoor activities. There is a single garage providing storage for larger items and gives direct access to the property, there is also ample off street parking for several vehicles.

The bungalow's single-storey layout not only enhances accessibility but also creates a seamless flow throughout the home. The location is particularly appealing, with the picturesque views across the village of Bridge of Earn, providing a friendly community atmosphere, along with local amenities and easy access to Perth city centre.

- Detached bungalow
- 4 bedrooms
- Off street parking
- Private front and rear gardens
- Gas central heating
- Close to local schooling
- Close to local amenities
- Easy access to transport links
- Ideal family home
- Viewing recommended

Viewing is recommended to see what with property truly has to offer.

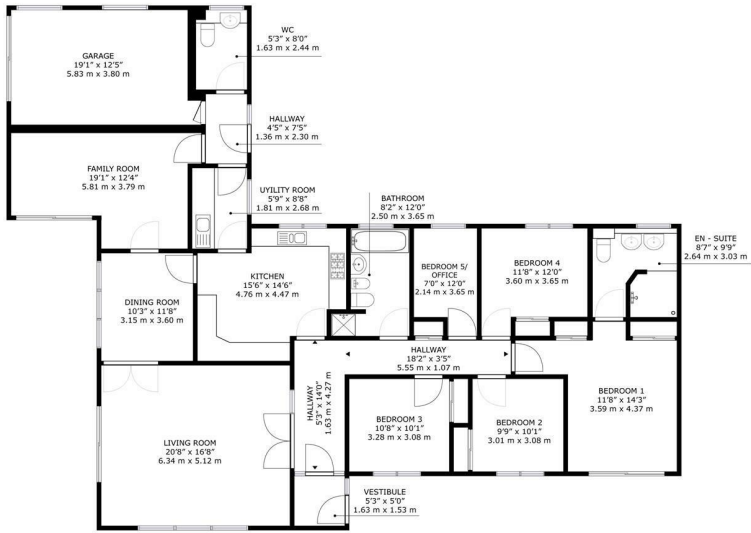

The Range, Heughfield Road, Bridge Of Earn, PH2 9BH
 GROSS INTERNAL AREA
 TOTAL: 2172 sq.ft, 201.7 m²
SIZES AND DIMENSIONS ARE APPROXIMATE, ACTUAL MAY VARY.

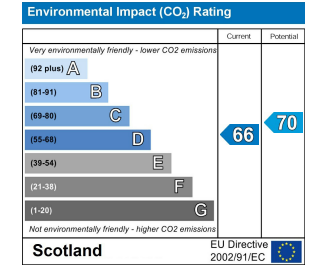
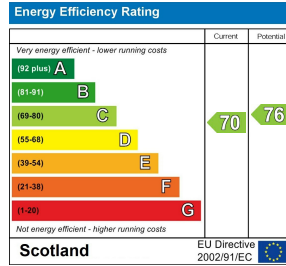

These particulars, whilst believed to be accurate are set out as a general outline only for guidance and do not constitute any part of an offer or contract. Intending purchasers should not rely on them as statements of representation of fact, but must satisfy themselves by inspection or otherwise as to their accuracy. No person in this firm's employment has the authority to make or give any representation or warranty in respect of the property.