



Belsize Avenue NW3

Parkheath  
*Sold on Service*





## Belsize Avenue, NW3

### Asking Price £875,000

### Share of Freehold

- A stunning, spacious newly refurbished apartment, finished to an exacting standard
- Gorgeous views of the communal gardens and beyond
- 2 double bedroom, 2 bathroom apartment, over 900 sq ft on the 3rd floor
- Set in this highly regarded 1930's mansion block with lift, portage and communal gardens
- Newly installed Fensa certificated windows
- Magnificent 16ft bay fronted reception and Fully equipped 11ft contemporary kitchen
- 2 double bedrooms with built-in wardrobes
- Share of freehold
- Please note that some of the photographs have been virtually staged
- Situated moments from all Belsize Park amenities

Belsize Park/Hampstead  
208 Haverstock Hill  
NW3 2AG  
Sales 020 7431 1234  
Lettings 020 7431 3104  
[nw3@parkheath.com](mailto:nw3@parkheath.com)

South/West Hampstead  
192 West End Lane  
NW6 1SG  
Sales & Lettings  
Tel 020 7794 7111  
[192@parkheath.com](mailto:192@parkheath.com)

Kensal Rise  
54-56 Chamberlayne Rd  
NW10 3JH  
Tel 020 8960 4845  
[kensal@parkheath.com](mailto:kensal@parkheath.com)

Property Management  
192 West End Lane  
NW6 1SG  
020 7433 6174  
[pm@parkheath.com](mailto:pm@parkheath.com)

**Parkheath**  
*Sold on Service*

**Camden Tax band E**

[www.parkheath.com](http://www.parkheath.com)

## Hillfield Court, Belsize Avenue, London NW3

Approximate Gross Internal Floor Area = 84.3 sq m / 908 sq ft

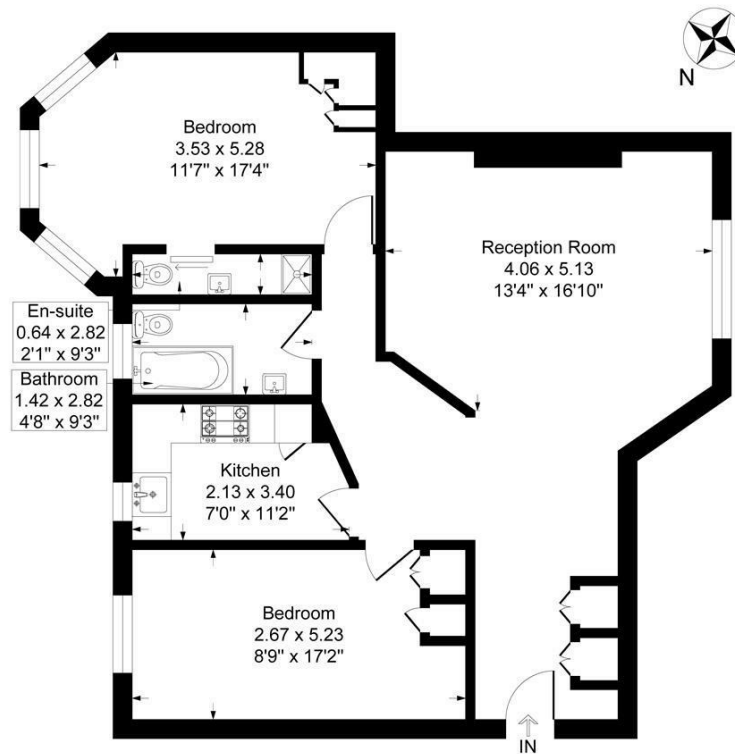

Third Floor

Illustration for identification purposes only, measurements are approximate, not to scale.

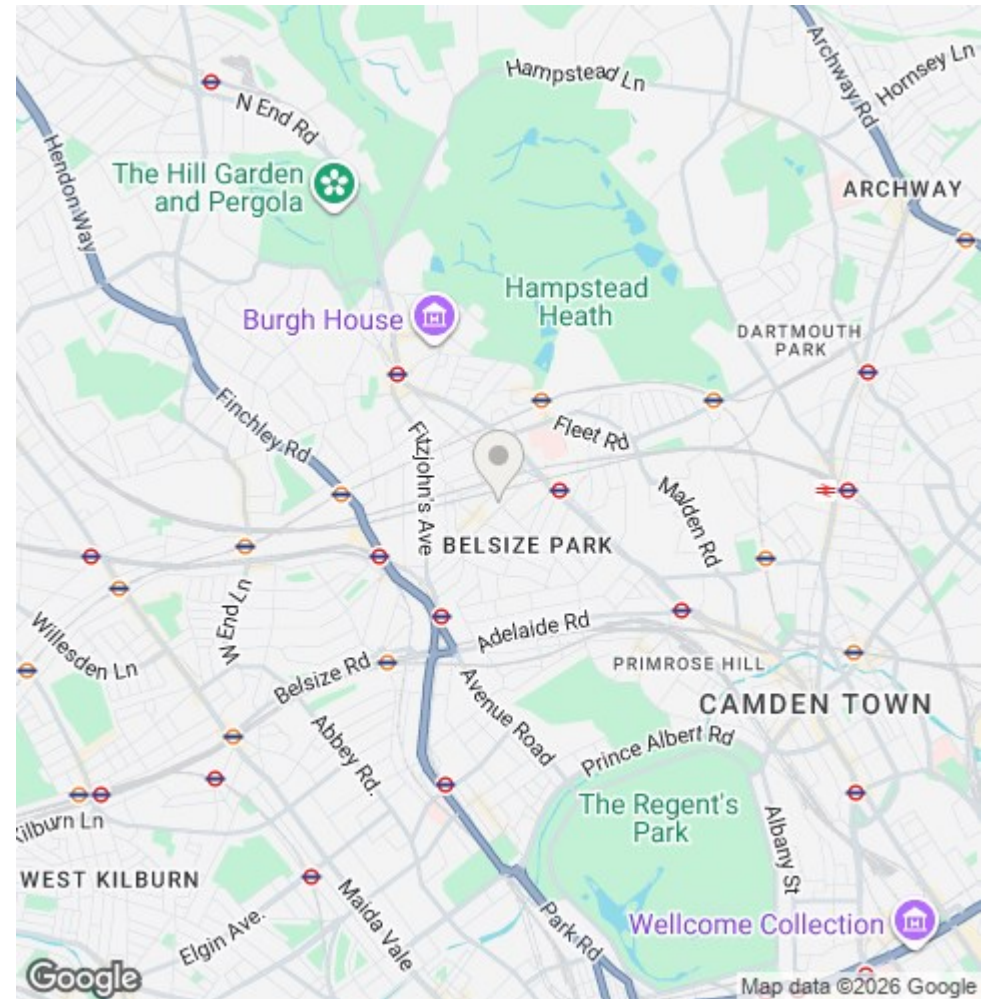

The particulars do not constitute part of an offer or contract. The particulars, including text, photographs and plans, are for the guidance only of prospective purchasers/tenants and must not be relied upon as statements of fact. The descriptions provided therein represent the opinion of the author and whilst given in good faith should not be construed as statements of fact. Nothing in these particulars shall be deemed a statement that the property is in good condition or otherwise or that any services or facilities are in good working order. All measurements are approximate