



Evelyn Walk, N1

£3,400 Per calendar month

A well presented three bedroom property in Hoxton. This property is split over two levels, has a large living area with separate kitchen and also a private garden.

Evelyn Court is within easy reach of Shoreditch Park and walking distance to Hoxton Overground Station.

Features

- Three Bedrooms
- One Bathroom
- Separate Kitchen
- Duplex Maisonette
- Private Garden
- Wooden Flooring

Evelyn Walk, London, N1

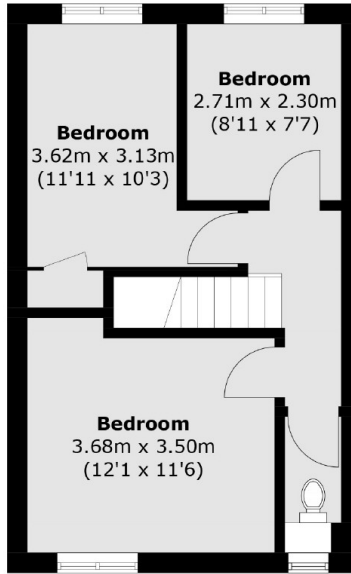

First Floor

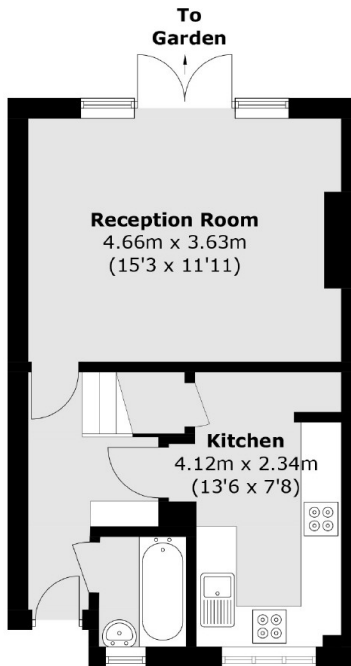

Ground Floor

Total area (approx.): 73.2 sq. m (787.9 sq. ft)