



14 Muirfield
Swindon

£297,500
mcfarlane
property.com



14 Muirfield

Swindon

Step inside this MODERN MID TERRACE TOWNHOUSE in the heart of Redhouse, offering FLEXIBLE LIVING across three floors. This inviting home boasts THREE DOUBLE BEDROOMS, including a MASTER BEDROOM WITH ENSUITE, making it perfect for families or those who love extra space.

The ground floor features a modern KITCHEN and a SEPARATE DINING ROOM, ideal for entertaining or relaxed family meals. Upstairs, you'll find a SPACIOUS FIRST FLOOR LIVING ROOM flooded with natural light, providing a comfortable setting for relaxation. With NO ONWARD CHAIN, this property is ready for you to move straight in and make it your own.

Step outside to discover an ENCLOSED REAR GARDEN, perfect for summer barbeques, gardening or letting children play safely. The property also benefits from a GARAGE WITH PARKING, offering plenty of space for your car and additional storage. Whether you're looking for a peaceful outdoor retreat or a practical space for family life, this home has it all. Enjoy the convenience of a central location with local amenities within walking distance, combined with the privacy and security of your own outdoor haven.

Don't miss your chance to view this FANTASTIC TOWNHOUSE - book your viewing today.

- MID TERRACE TOWNHOUSE
- THREE DOUBLE BEDROOMS





Ground Floor

Approx. 36.4 sq. metres (391.7 sq. feet)

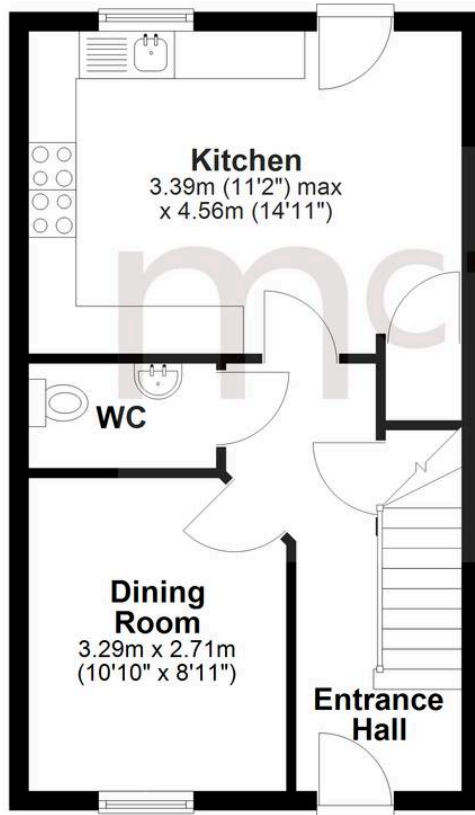

First Floor

Approx. 36.4 sq. metres (391.7 sq. feet)

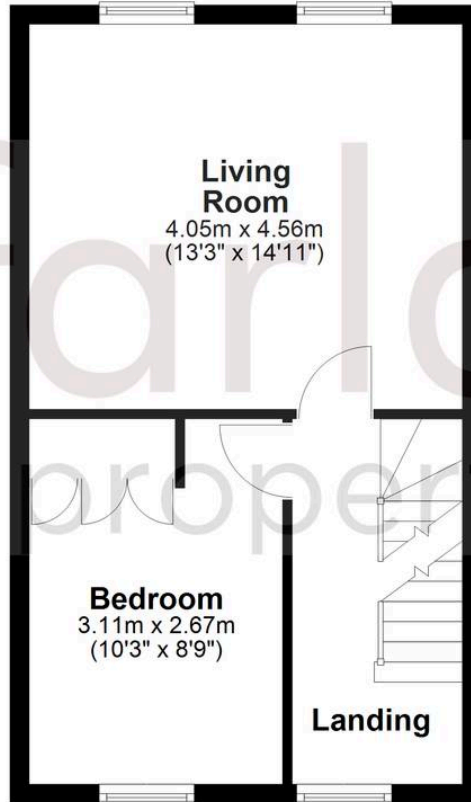

Second Floor

Approx. 36.4 sq. metres (391.7 sq. feet)

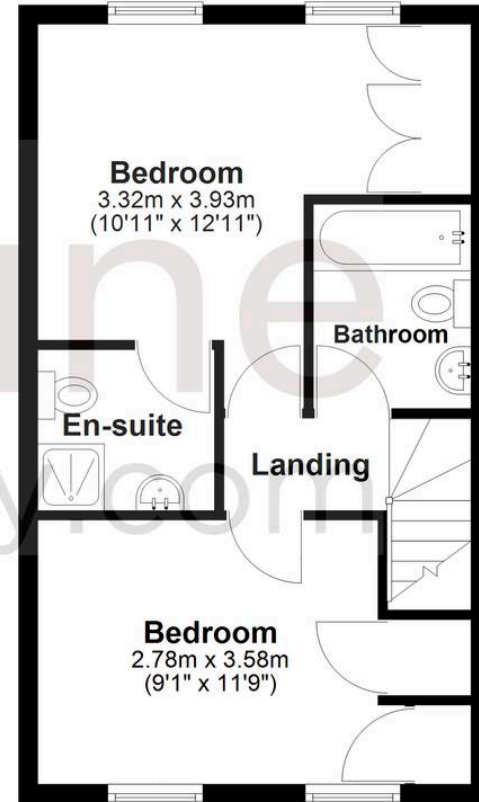

Total area: approx. 109.2 sq. metres (1175.2 sq. feet)

McFarlane Sales & Lettings

North Swindon, Redhouse Village Centre, Swindon - SN25 2FW

01793 296600 • swindon@mcfarlaneproperty.com • www.mcfarlaneproperty.com/