



Elmworth Grove, SE21 | £343,000

02087028111

dulwichvillage@pedderproperty.com

pedder
We live local



In General

- An attractive first floor purpose built apartment
- Two double bedrooms
- Lounge /dining room
- Fitted kitchen
- Bathroom
- Rear balcony accessed from the lounge
- Well presented throughtout
- Popular location close to transport links

In Detail

An attractive first floor purpose built apartment for sale situated in this popular residential development set back from Rosendale Road in Dulwich.

The property offers spacious and well presented accommodation comprising two double bedrooms, lounge/dining room with access to a private rear balcony, fitted kitchen and modern bathroom. Externally there are well kept communal gardens.

Cormorant Court is well located within easy reach of West Dulwich and Dulwich Village with their numerous independent shops, cafes and restaurants. The property is within walking distance of several beautiful green spaces including Dulwich Park, Dulwich & Sydenham Hill Woods, Belair Park and Brockwell Park. Excellent rail links to central London are from nearby West Dulwich (Victoria/ Blackfriars) and Tulse Hill (London Bridge/Blackfriars).

EPC: C | Council Tax Band: B | Lease: 125 years | GR: £10 pa | SC: £2,547.94 pa | BI: Incl in SC



Floorplan

Cormorant Court, SE21

Approximate Gross Internal Area
64.5 sq m / 694 sq ft

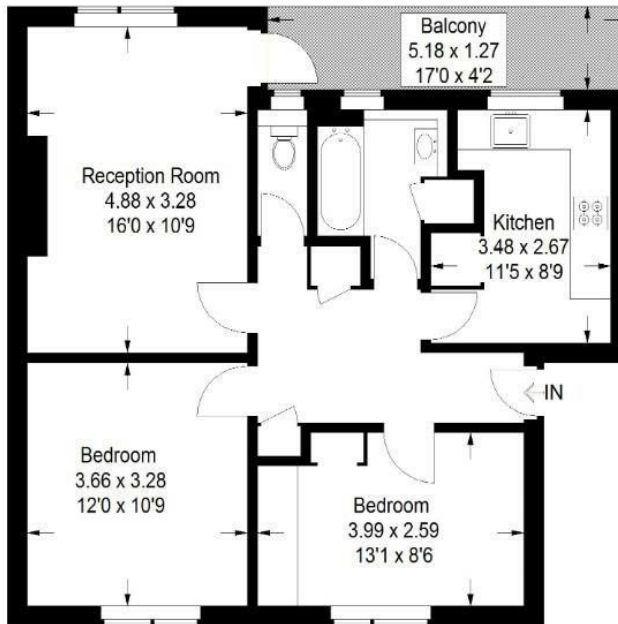

First Floor

Copyright www.pedderproperty.com © 2026
These plans are for representation purposes only as defined by RICS - Code of Measuring Practice. Not drawn to Scale. Windows and door openings are approximate. Please check all dimensions, shapes and compass bearings before making any decisions reliant upon them.

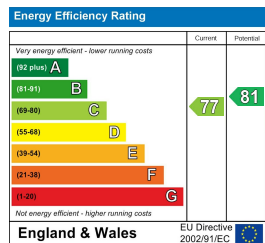

Pedder Property Ltd trading as Pedder for themselves and for the vendor/landlord of this property whose agents they are, give notice that (1) these particulars do not constitute any part of an offer or contract, (2) all statements contained within these particulars are made without responsibility on the part of Pedder or the vendor/landlord, (3) whilst made in good faith, none of the statements contained within these particulars are to be relied upon as a statement of representation or fact, (4) any intending purchaser/tenant must satisfy him/herself by inspection or otherwise as to the correctness of each of the statements contained within these particulars, (5) the vendor/landlord does not make or give either Pedder or any person in their employment any authority to make or give representation or warranty whatsoever in relation to this property.