



## Ringmer Gardens, N19

£350,000

A well-presented one bedroom flat with a spacious reception room, a separate kitchen and a south facing garden. The property offers generous living space throughout, and lots of natural light.

Located within easy reach of Upper Holloway and Finsbury Park, offering a great selection of local amenities along with excellent transport links, including Overground, Northern line and National Rail services.

### Features

- Large Double Bedroom
- Ground Floor Flat
- South Facing Garden
- Open Plan Kitchen
- Ample Storage
- Private Entrance

# Ringmer Gardens, London, N19

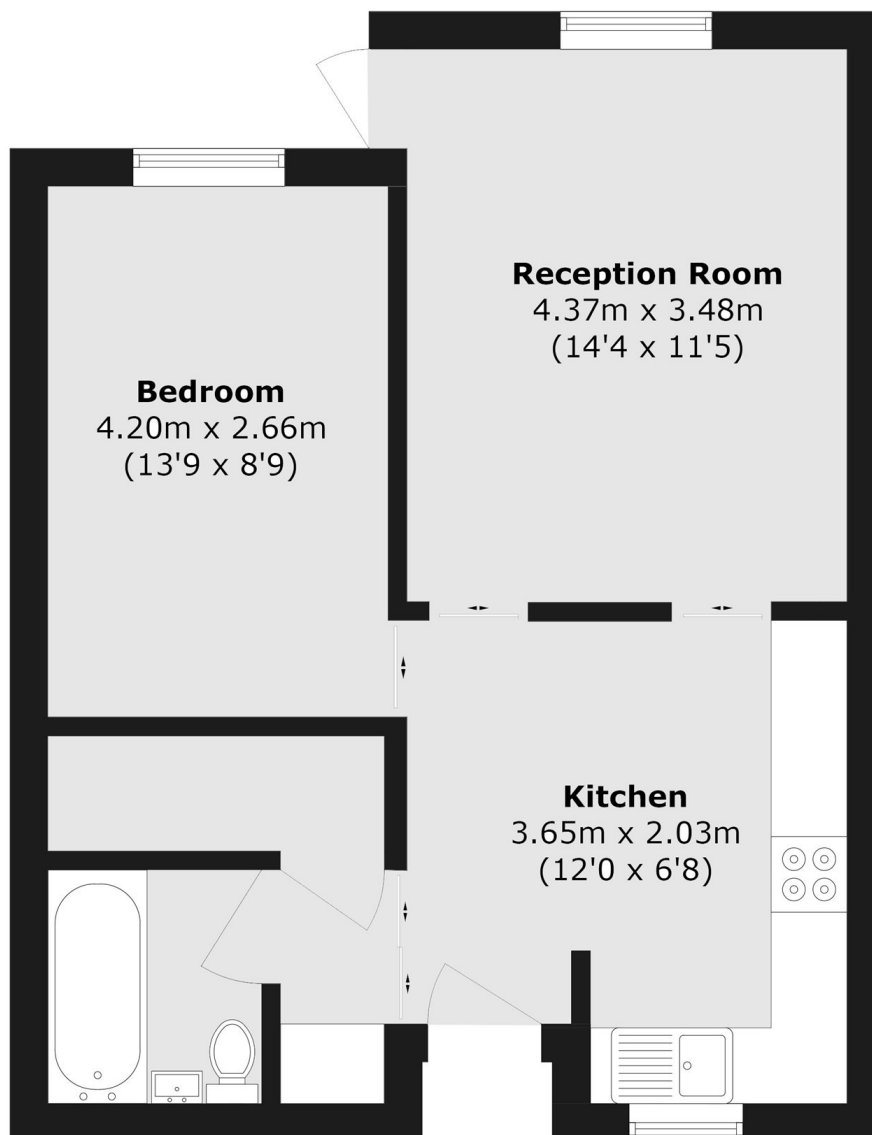

Total area (approx.): 47.9 sq. m (515.5 sq. ft)