



King & Queen Wharf, SE16

£650,000

Situated moments from the river, this two double bedroom flat is immaculately presented and boasts a large open plan kitchen/living space, utility room & private terrace. The development offers concierge and leisure facilities including a swimming pool, hot tub & sauna.

Located just 0.6 miles from Rotherhithe station and 0.8 miles from Canada Water. Blenheim Court is surrounded by shops, cafés and riverside pubs and restaurants.

Features

- Two Double Bedrooms
- Two Bathrooms
- Fantastic Condition
- Private Terrace
- Gym & Concierge Facilities
- Riverside Location

King & Queen Wharf, London, SE16

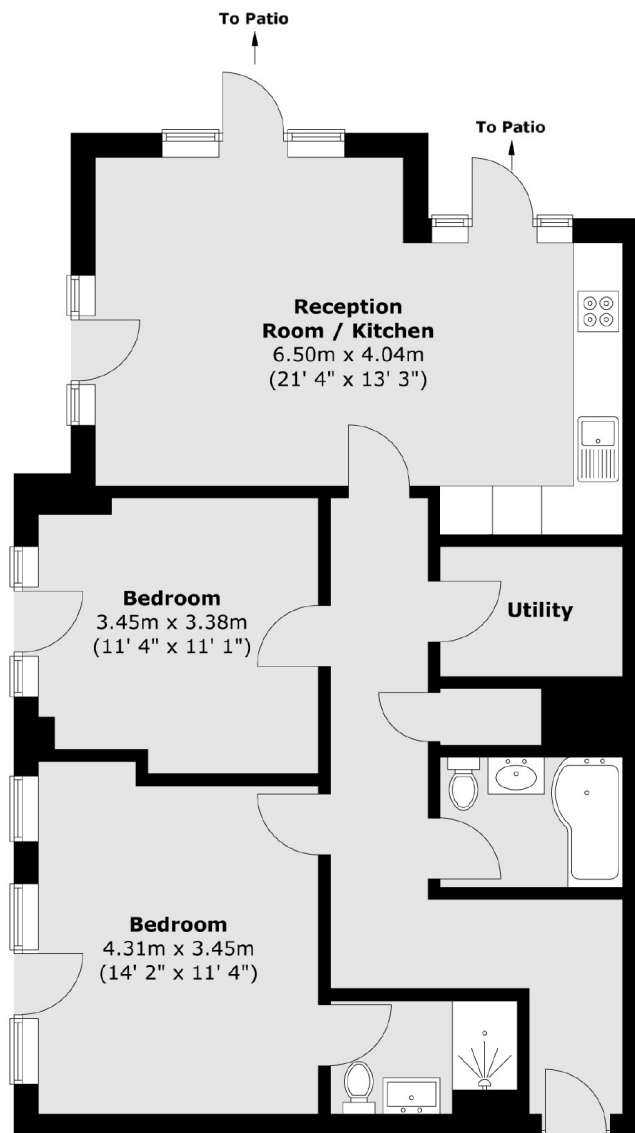

Total area (approx.) : 80.1 sq. m (862 sq. ft)