



# CARVERS

SALES & LETTINGS

Hatfield Road  
Newton Aycliffe, DL5 5PW  
Offers over £72,000

House - Terraced



For sale by Modern Method of Auction: Starting Bid Price £76,000 plus Reservation Fee.  
**\*\*DRIVEWAY\*\*** A 3 BEDROOM mid-terrace property occupying a lovely position close to local schooling and Newton Aycliffe Town Centre. Equipped with gas central heating to radiators and uPVC double glazing the property features an open plan fitted kitchen/dining room, rear entrance porch, dual aspect living room with French doors and three bedrooms to the first floor with family bathroom/WC. Externally there is a driveway to the front with enclosed garden to the rear.



### The Modern Method of Auction

This property is for sale by Modern Method of Auction allowing the buyer and seller to complete within a 56 Day Reservation Period. Interested parties' personal data will be shared with the Auctioneer (iamsold Ltd). If considering a mortgage, inspect and consider the property carefully with your lender before bidding. A Buyer Information Pack is provided, which you must view before bidding. The buyer is responsible for the Pack fee. For the most recent information on the Buyer Information Pack fee, please contact the iamsold team. The buyer signs a Reservation Agreement and makes payment of a Non-Refundable Reservation Fee of 4.5% of the purchase price inc VAT, subject to a minimum of £6,600 inc. VAT. This Fee is paid to reserve the property to the buyer during the Reservation Period and is paid in addition to the purchase price. The Fee is considered within calculations for stamp duty. Services may be recommended by the Agent/Auctioneer in which they will receive payment from the service provider if the service is taken. Payment varies but will be no more than £960 inc. VAT. These services are optional.

### Agents Notes

Tenure:- Freehold

Mains gas, (central heating to radiators), electricity & drainage

uPVC double glazing throughout

Council Tax:- Band A

Local Authority:- Durham County Council

### Buyer(s) Identification Checks

Should a purchaser(s) have an offer accepted on a property marketed by Carver Residential they will need to undertake an identification check. This is done to meet our obligation under Anti Money Laundering Regulations (AML) and is a legal requirement. We use a specialist third party service to verify your identity, this is not a credit check and will have no effect on credit history. The cost of these checks is £36 inc. VAT per buyer, which is paid in advance, when an offer is agreed and prior to a sales memorandum being issued. This charge is non-refundable.

### Property Size

Please note the property size is taken from the Energy Performance Certificate and may not take into account all rooms from the floorplan (due to unheated space not being calculated e.g. conservatory and/or garage)



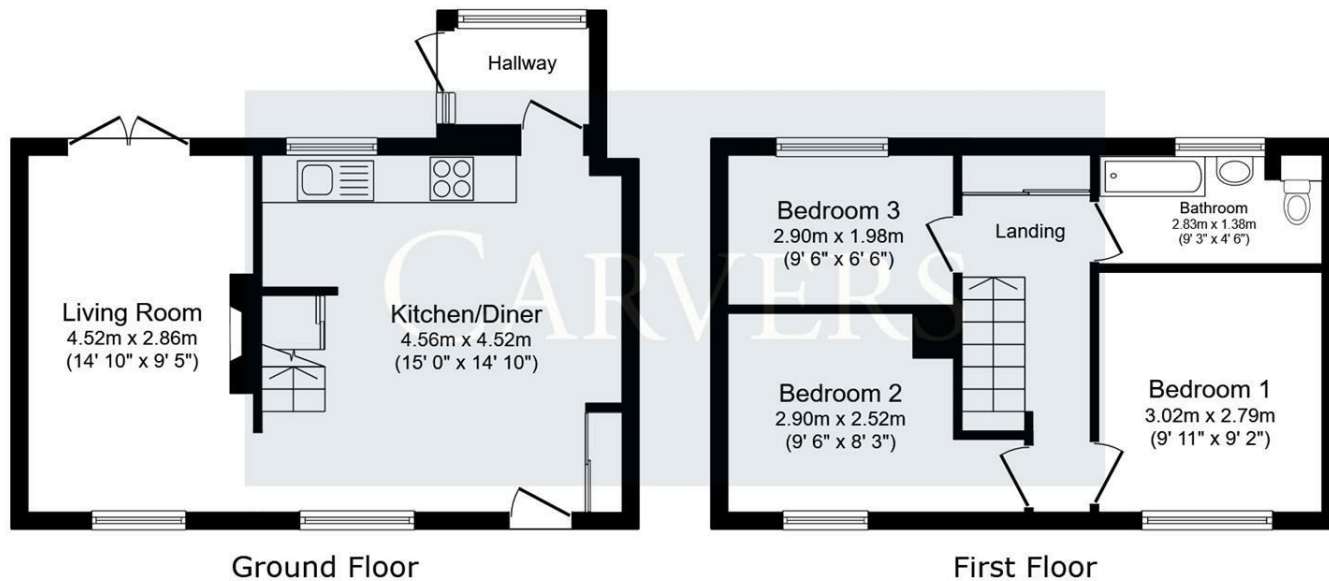

Energy Efficiency Rating		
	Current	Potential
Very energy efficient - lower running costs		
(92 plus) <b>A</b>		
(81-91) <b>B</b>		
(69-80) <b>C</b>		
(55-68) <b>D</b>		
(39-54) <b>E</b>		
(21-38) <b>F</b>		
(1-20) <b>G</b>		
Not energy efficient - higher running costs		
	71	78
<b>England &amp; Wales</b>	EU Directive 2002/91/EC	

Property size taken from EPC  
731.00 sq ft

This floor plan is for illustrative purposes only. It is not drawn to scale. Any measurements, floor areas (including any total floor area), openings and orientations are approximate. No details are guaranteed, they cannot be relied upon for any purpose and do not form any part of any agreement. No liability is taken for any error, omission or misstatement. A party must rely upon its own inspection(s). Powered by www.Propertybox.io

**Searching 1,000s of mortgages**  
 Access to 12,000+ products from 90+ lenders across the UK.  
 Call: 01325 370341 Visit: Any of our offices  
 Web: [mortgageadvicebureau.com/carvers](http://mortgageadvicebureau.com/carvers)

Your home may be repossessed if you do not keep up repayments on your mortgage.  
 There may be a fee for mortgage advice. The actual amount you pay will depend upon your circumstances.  
 The fee is up to 1% but a typical fee is 0.3% of the amount borrowed.

These particulars do not constitute any part of an offer or contract. None of the statements contained in these particulars are to be relied on as statements or representations of fact and any intending purchaser must satisfy themselves by inspection or otherwise to the correctness of each of the statements contained in these particulars. The vendor does not make or give, and neither Carvers nor any person in their employment has any authority to make or give any representation or warranty whatever in relation to this property.