



Higher Broad Oak Road, West Hill, Ottery St. Mary, EX11 1XD

Guide Price £525,000

🛏️ 2 🚿 2 🚗 2



Emberlea is a mature detached bungalow situated in a pleasant and sunny plot within walking distance of the village amenities including convenience store, church, and an outstanding primary school. Major roads are also easily accessible providing swift access to the cathedral city of Exeter, M5 and the coast. The bungalow also benefits from being within the renowned Kings School catchment area.

The accommodation itself is light, airy and includes an entrance porch which opens into the hallway, laid with engineered oak flooring. The kitchen has been fitted with a range of storage cupboards and drawers with complimenting work surfaces, inset sink and attractively tiled surrounds. There are modern integral appliances including a fridge, electric oven, ceramic hob as well as a space for a slimline dishwasher. The utility room provides further matching storage cupboards, worksurfaces and space for additional appliances such as washing machine and a tumble dryer.

The spacious triple aspect sitting room provides plenty of space for furniture and a recessed woodburning stove with a slate hearth provides a pleasant focal point. French doors open into the conservatory which provides further seating space and enjoys a wonderful aspect of the garden. Also from the sitting room double doors lead to the the dining room which provides ample space for a good sized dining table and chairs.

At the opposite end of the bungalow are two good sized double bedrooms with the largest benefitting from a spacious ensuite fitted with a white suite including a bath and a large shower cubicle. From the the hallway is a separate bathroom which has also fitted been fitted with a white suite. The loft space which is accessed from the hallway provides an excellent opportunity to be converted into further accommodation subject to the necessary planning permissions and consents. The bungalow has been fitted with uPVC double glazed windows and doors and benefits from gas fired central heating.

To the outside the property is approached by a good sized driveway which provides off road parking space for several cars in front of the garage which has power and lighting. The garden is mainly laid to lawn interspersed by a variety of shrubs, plants and fruit trees providing a variety of colour and interest all year round. There is paved patio and garden enjoys an excellent degree of sunlight.



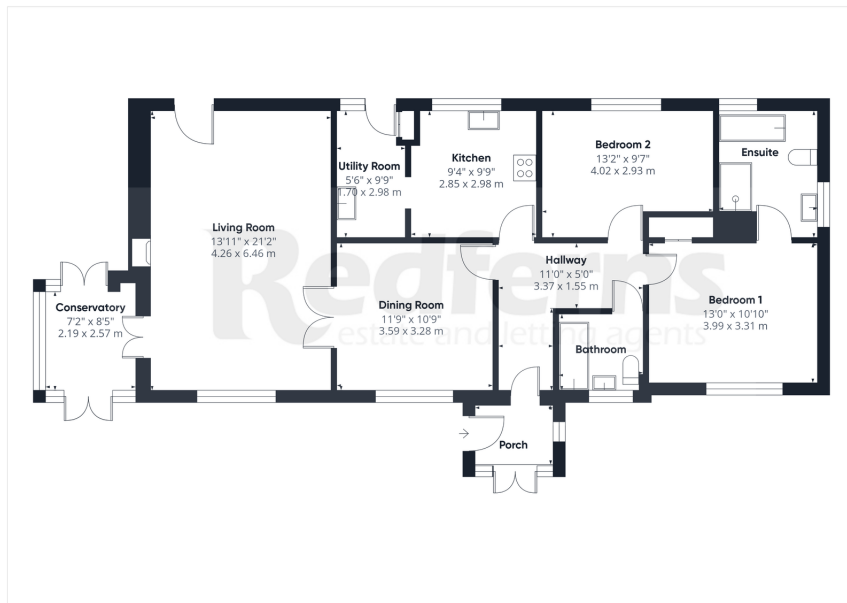

- Spacious detached bungalow
- Entrance porch, hallway, conservatory and sitting room with woodburning stove
- Separate dining room with space for a good sized table
- Separate bathroom, gas fired central heating, uPVC double glazing
- Well stocked garden prodominantly laid to lawn
- Situated close to the centre of the sought after village of West Hill
- Kitchen with modern integral appliances and a utility room
- Two spacious double bedrooms (largest with ensuite shower room)
- Driveway providing parking for several vehicles in front of the garage
- No onward chain



Ottery St. Mary | 01404 814 306
 Exeter | 01392 984 511
 Sidmouth | 01395 512 544

www.redfernsproperty.co.uk | sales@redfernsproperty.co.uk

