



## Millharbour, E14

£600 Per week

A large two bedroom apartment located in the Millharbour development. Features include an open plan reception room, private balcony, concierge and allocated underground parking.

Millharbour is 0.8 miles from Canary Wharf Jubilee Line and 0.2 miles from South Quay DLR Station which both provide good links to the City.

### Features

- Two Bedrooms
- Two Bathrooms
- Ninth Floor
- Balcony
- Furnished
- Underground Parking

# Millharbour, London, E14

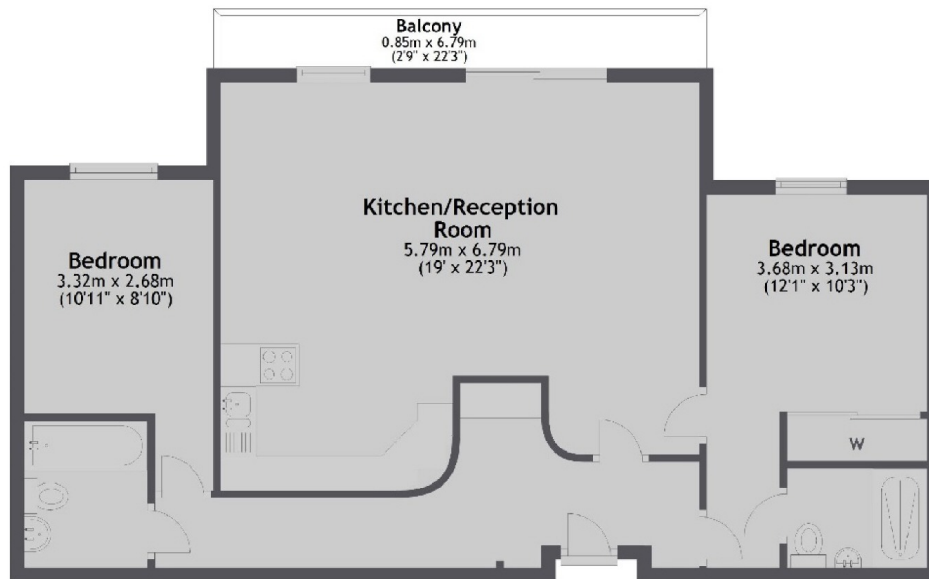

Main area: Approx. 78.4 sq. metres (844.2 sq. feet)  
Plus balconies, approx. 6.2 sq. metres (66.2 sq. feet)

## Dexters

Canary Wharf  
39 Westferry Road  
London  
E14 8JH  
Lettings  
0207 517 1190

Energy Rating: B. We aim to make our particulars both accurate and reliable. However they are not guaranteed; nor do they form part of an offer or contract. If you require clarification on any points then please contact us, especially if you're traveling some distance to view. Please note that appliances and heating systems have not been tested and therefore no warranties can be given as to their good working order.

 **RICS** | Regulated  
Estate Agent  
and Letting Agent

[dexters.co.uk](https://dexters.co.uk)