



**2 Bed  
House - Mid Terrace  
located in**

**£725 Per month**



GROUND FLOOR  
268 sq.ft. (24.9 sq.m.) approx.

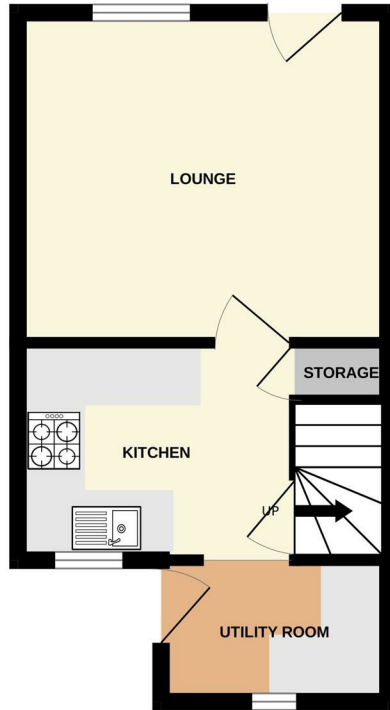

1ST FLOOR  
231 sq.ft. (21.5 sq.m.) approx.

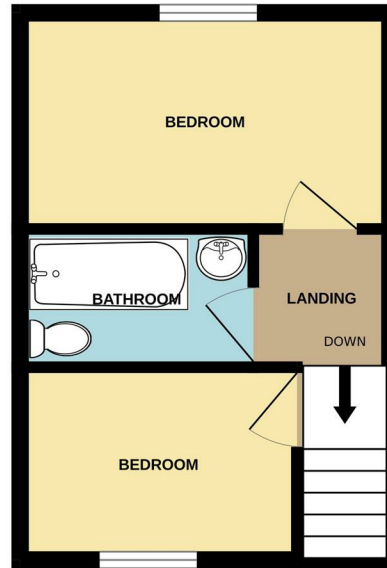

TOTAL FLOOR AREA: 499 sq.ft. (46.3 sq.m.) approx.

Whilst every attempt has been made to ensure the accuracy of the floorplan contained here, measurements of doors, windows, rooms and any other items are approximate and no responsibility is taken for any error, omission or mis-statement. This plan is for illustrative purposes only and should be used as such by any prospective purchaser. The services, systems and appliances shown have not been tested and no guarantee as to their operability or efficiency can be given.  
Made with Metropix ©2025

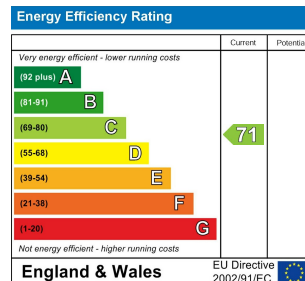

## DIRECTIONS

## CONTACT

Unit 6  
Century 2 Business Centre 3 Dearne  
Lane  
Manvers  
Rotherham

E: [info@burrowsresidential.co.uk](mailto:info@burrowsresidential.co.uk)  
T: 07507 905644

