



**13, St Julians Mews, Williams Way, Shrewsbury, SY1 1AD**  
£1,050 Per Month



13, St Julians Mews, Williams Way, Shrewsbury, SY1 1AD

**£1,050 Per Month**

VIRTUAL TOUR AVAILABLE: A spacious and well presented ground floor apartment, situated within this popular modern development, walking distance from the town centre, benefitting from allocated parking and communal gardens.

Available: Immediately

## Description

Comprising: Entrance hall, spacious living/dining room, new kitchen/breakfast room including oven & gas hob, master bedroom with ensuite shower room and Juliet balcony, further double bedroom, bathroom including shower, gated allocated parking, communal garden area. EPC C



Unfurnished

Council Tax Band: B

Available: 15th June 2026

EPC: C

## Floor Plans

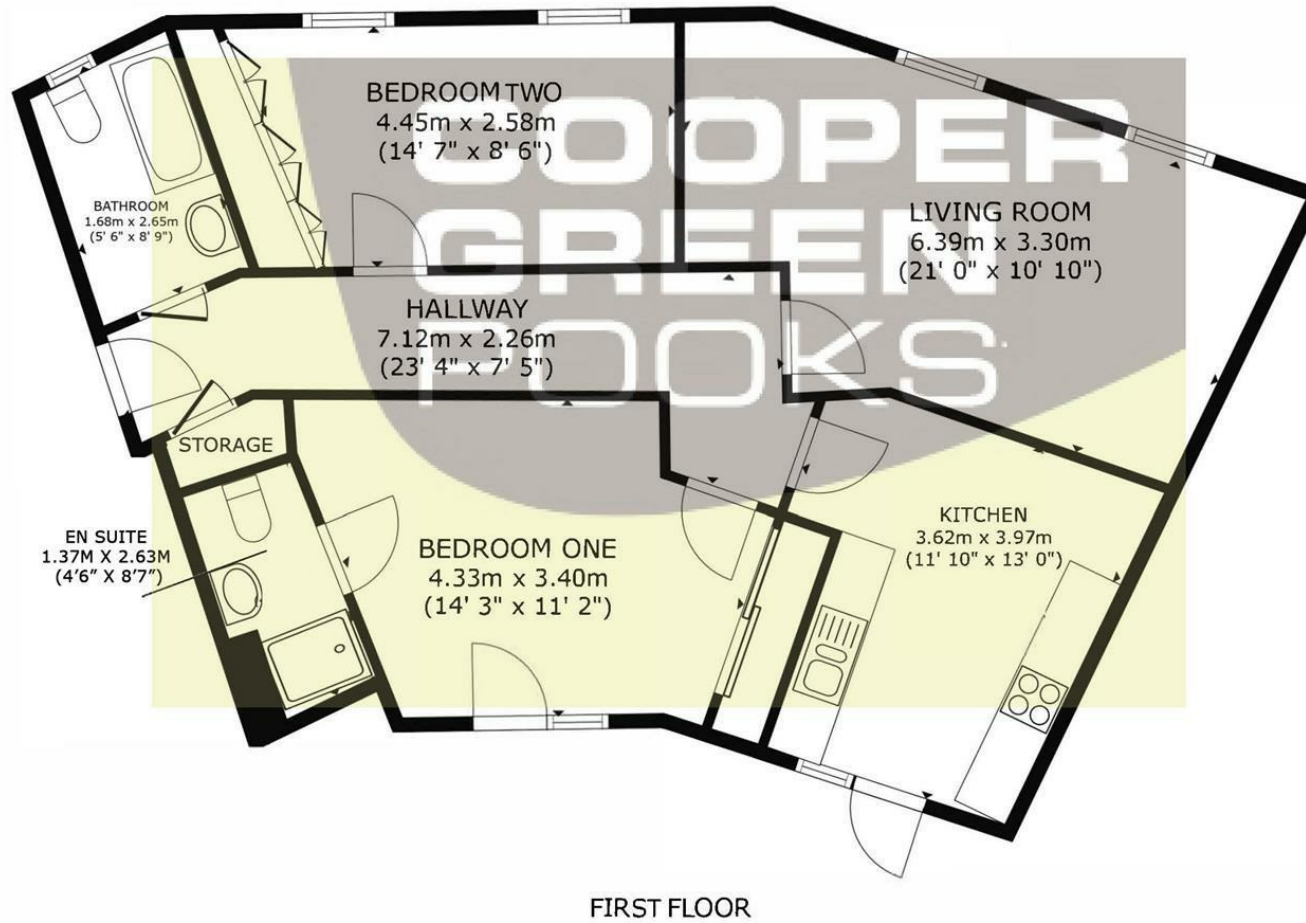

GROSS INTERNAL AREA  
FLOOR PLAN 82.6 m<sup>2</sup> (889 sq.ft.)  
TOTAL : 82.6 m<sup>2</sup> (889 sq.ft.)  
SIZES AND DIMENSIONS ARE APPROXIMATE, ACTUAL MAY VARY.

These particulars, whilst believed to be accurate are set out as a general outline only for guidance and do not constitute any part of an offer or contract. Intending purchasers should not rely on them as statements of representation of fact, but must satisfy themselves by inspection or otherwise as to their accuracy. No person in this firm's employment has the authority to make or give any representation or warranty in respect of the property.