

16 Newton Place - Asking Price £230,000

Haverhill CB9 0AZ

shires

Estate & Letting Agents



"Consistently providing outstanding service to our clients"

Asking Price £230,000

The Property

This exciting three bedroom is situated in the charming area of Newton Place, Haverhill, this delightful terraced house presents an excellent opportunity for families and first-time buyers alike. The property boasts a well-proportioned reception room, perfect for entertaining guests or enjoying quiet evenings with loved ones.

With three inviting bedrooms, there is space for rest and relaxation, making it an ideal home for those seeking comfort and convenience. The single bathroom is thoughtfully designed to cater to the needs of a busy household.

Haverhill is known for its friendly community and offers a range of local amenities, including shops, schools, and parks, all within easy reach. This property is not just a house; it is a place where memories can be made and cherished.

If you are looking for a home that combines practicality with a welcoming atmosphere, this terraced house in Newton Place is certainly worth considering.

Features

- **THREE BEDROOM PROPERTY**
- **WALKING DISTANCE TO TOWN**
- **MODERN KITCHEN**
- **AVAILABLE TO VIEW NOW**
- **LOCAL SCHOOLS NEARBY**
- **POPULAR CHALKSTONE ESTATE**
- **FAMILY HOME**
- **TERRACED HOUSE**
- **VIEW TO AVOID MISSING OUT**
- **FIRST TIME BUYER PROPERTY**





These sales particulars have been produced as a general guide only and we would draw to your attention that we have not carried out a detailed Survey of the property nor have we tested services, appliances or specific fittings. Whilst measurements and statements given within the details are provided in good faith, their accuracy should not be relied upon. If there are any points about which you may be uncertain or would like further clarification, we would suggest that you telephone this office and speak to our staff who will endeavour to assist you.

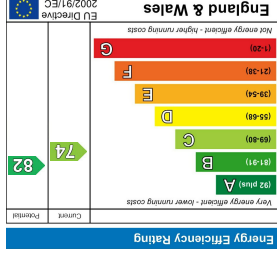

Whilst every attempt has been made to ensure the accuracy of the floorplan contained here, measurements of doors, windows, rooms and any other items are approximate and no responsibility is taken for any error, omission or mis-statement. This plan is for illustrative purposes only and should be used as such by any prospective purchaser. The services, systems and appliances shown have not been tested and no guarantee as to their operability or efficiency can be given.

 Made with Metropix ©2026

TOTAL FLOOR AREA : 99.0 sq.m. (1066 sq.ft.) approx.



GROUND FLOOR
51.5 sq.m. (554 sq.ft.) approx.

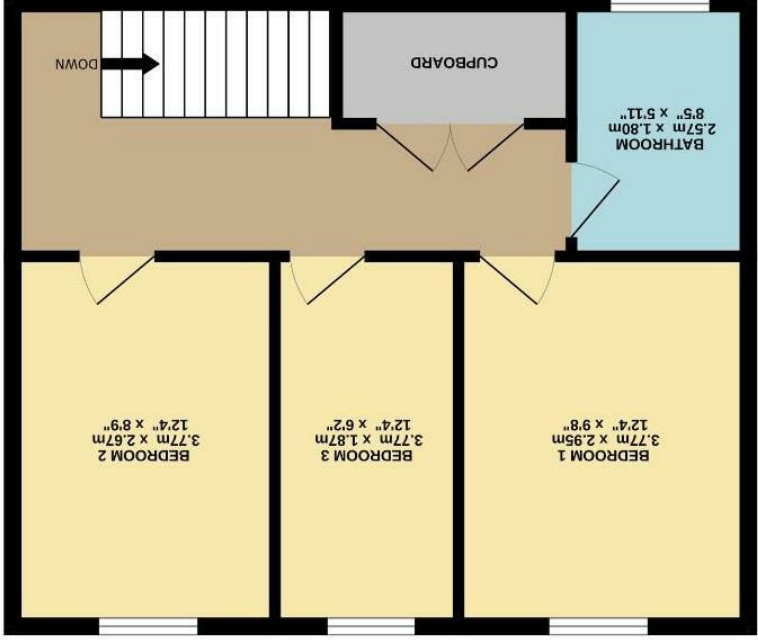

1ST FLOOR
47.5 sq.m. (512 sq.ft.) approx.

12 High Street, Haverhill, Suffolk, CB8 8AR
 T: 01440 707976
 E: haverhill@shiresstateagents.co.uk