

# HUNTERS<sup>®</sup>

HERE TO GET *you* THERE



## Stourhead House

Tachbrook Street, London, SW1V 2QP

£3,595 Per Month

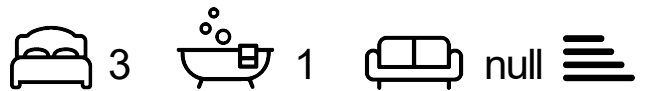

\*\*\*OPEN HOUSE VIEWINGS 16TH MAY\*\*\*

\*\*\*HOT WATER AND HEATING INCLUDED\*\*\*

Ideal for 3 students/shares (HMO)

This charming three bedroom split level property boasts a generous floor plan with ample space for comfortable living. The kitchen is equipped with modern appliances and plenty of storage. Each of the three bedrooms is well-proportioned and offers a peaceful sanctuary for rest and relaxation. The highlight of this flat is the private garden, a tranquil oasis where you can unwind and enjoy outdoor.

Located in the desirable neighborhood of Pimlico, you'll have easy access to amenities, parks, and transportation options. It's a fantastic opportunity to rent a beautiful home in a prime location with Pimlico tube station a stones throw away!

STUDENTS WELCOME.



## Area Map



## Floor Plans

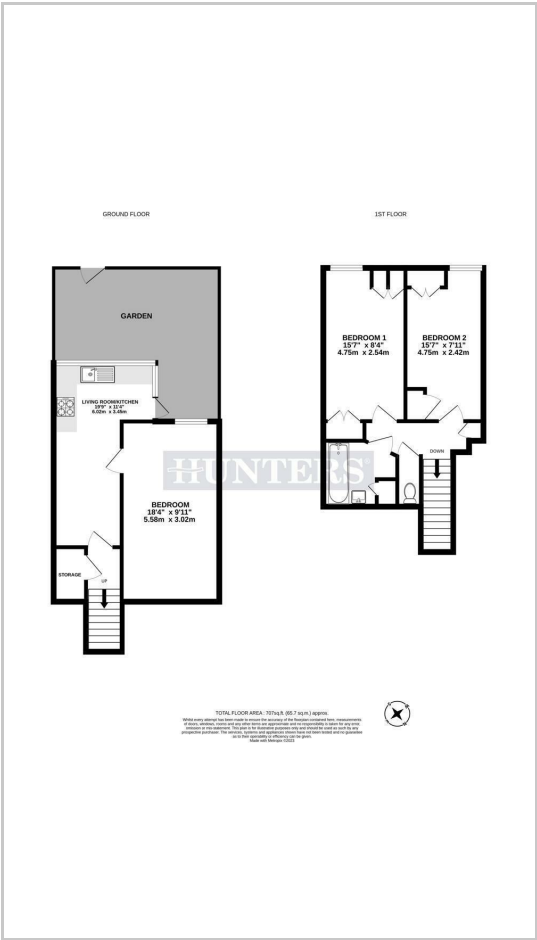

## Energy Efficiency Graph

Energy Efficiency Rating	Current	Potential	Environmental Impact (CO <sub>2</sub> ) Rating	Current	Potential
Very energy efficient - lower running costs			Very environmentally friendly - lower CO <sub>2</sub> emissions		
(92 plus) <b>A</b>			(82 plus) <b>A</b>		
(81-91) <b>B</b>			(81-91) <b>B</b>		
(69-80) <b>C</b>			(69-80) <b>C</b>		
(55-68) <b>D</b>			(55-68) <b>D</b>		
(39-54) <b>E</b>			(39-54) <b>E</b>		
(21-38) <b>F</b>			(21-38) <b>F</b>		
(1-20) <b>G</b>			(1-20) <b>G</b>		
Not energy efficient - higher running costs			Not environmentally friendly - higher CO <sub>2</sub> emissions		
<b>England &amp; Wales</b>	EU Directive 2002/91/EC		<b>England &amp; Wales</b>	EU Directive 2002/91/EC	

These particulars are intended to give a fair and reliable description of the property but no responsibility for any inaccuracy or error can be accepted and do not constitute an offer or contract. We have not tested any services or appliances (including central heating if fitted) referred to in these particulars and the purchasers are advised to satisfy themselves as to the working order and condition. If a property is unoccupied at any time there may be reconnection charges for any switched off/disconnected or drained services or appliances - All measurements are approximate. **THINKING OF SELLING?** If you are thinking of selling your home or just curious to discover the value of your property, Hunters would be pleased to provide free, no obligation sales and marketing advice. Even if your home is outside the area covered by our local offices we can arrange a Market Appraisal through our national network of Hunters estate agents.