



Edith Row, SW6

£1,384 Per week

A stunning and contemporary apartment situated off the Kings Road. Boasting modern fixtures and fittings throughout the property offers a large open plan reception room leading onto two balconies, three double bedrooms and three bathrooms.

Edith Row is perfectly located off the popular Kings Road with the transport links of Fulham Broadway close by.

Features

- Modern Development
- Private Balcony
- Parquet Wood Flooring
- Three Bathrooms
- Concierge
- Kings Road

Edith Row, London, SW6

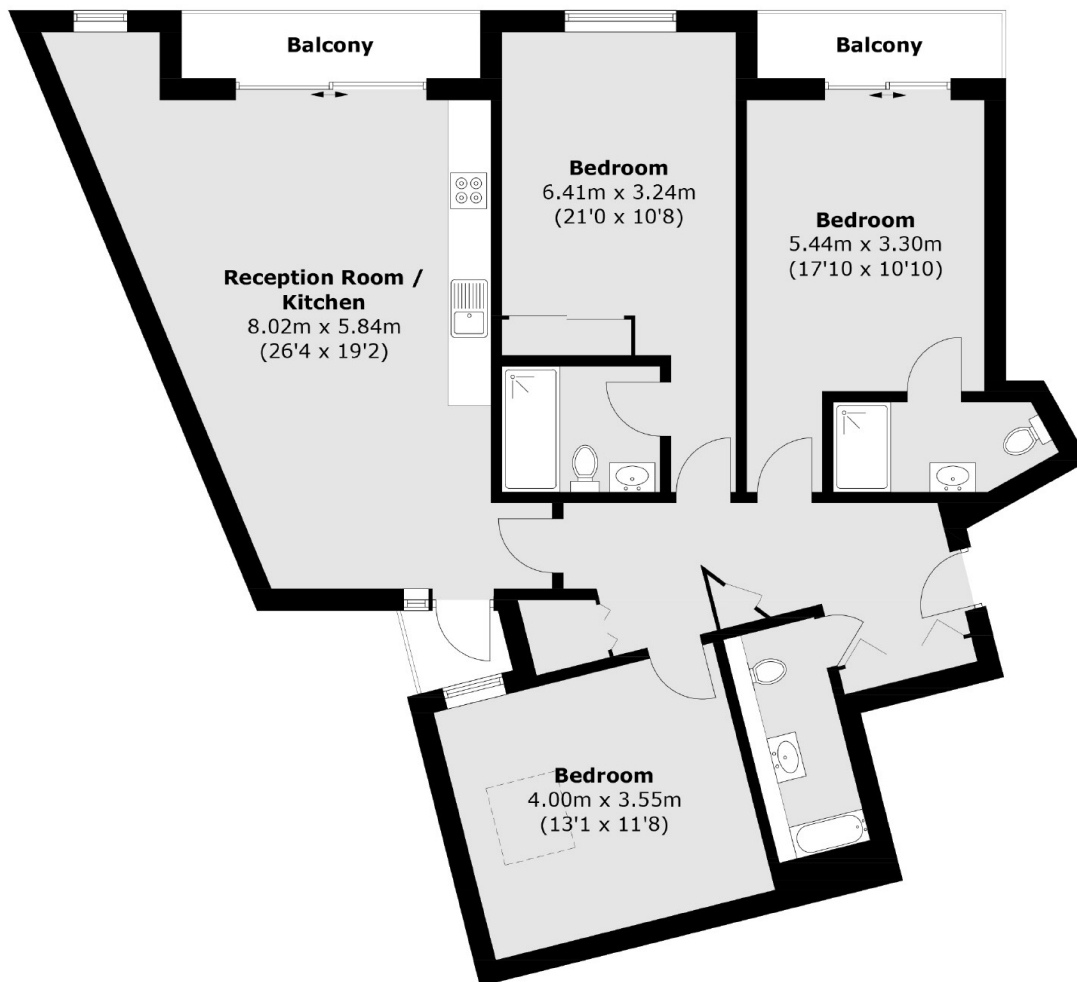

First Floor

Total area (approx.): 108.0 sq. m (1,162.5 sq. ft)