



Connells

Lindsey Road
Luton



Property Description

This two-bedroom semi-detached freehold house is located in the popular Wigmore area of Stopsley. Benefits include; Front and rear gardens, allocated parking and two good size bedrooms. It is also being offered to the market chain-free!

Benefits include; Hallway, kitchen and lounge downstairs.

Upstairs are two bedrooms and family bathroom located off the landing.

The front and rear and laid mostly to lawn, the rear accommodates a shed and gate to front.

There is also an allocated parking space a short stroll from the abode.

Wigmore is a suburb in north east Luton located on the edge of the Hertfordshire borders. It offers an array of shops and amities and is known for its family friendly environment and tranquil living.

Local schools include; Wigmore Primary, Cockernhoe Primary and Putteridge High.

Luton Parkway Station is located under 2 miles from the residence and Luton Mainline Railway Station just over 2.

Call now to view!#



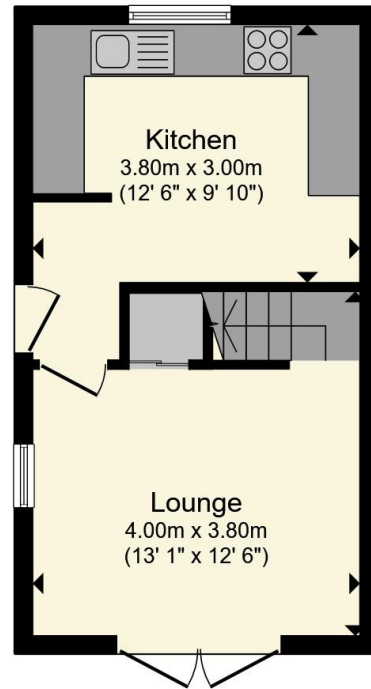

Ground Floor

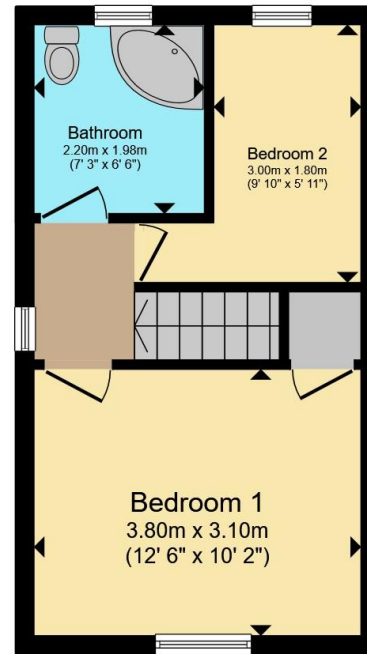

First Floor

Total floor area 54.0 m² (581 sq.ft.) approx

This floor plan is for illustrative purposes only. It is not drawn to scale. Any measurements, floor areas (including any total floor area), openings and orientation are approximate. No details are guaranteed, they cannot be relied upon for any purpose and they do not form part of any agreement. No liability is taken for any error, omission or misstatement. A party must rely upon its own inspection(s). Powered by www.propertybox.io



To view this property please contact Connells on

T 01582 450 999
E luton@connells.co.uk

83-83A George Street
 LUTON LU1 2AT

EPC Rating: D Council Tax
 Band: C

Tenure: Freehold

view this property online connells.co.uk/Property/STP308517



1. MONEY LAUNDERING REGULATIONS Intending purchasers will be asked to produce identification documentation at a later stage and we would ask for your co-operation in order that there will be no delay in agreeing the sale. 2. These particulars do not constitute part or all of an offer or contract. 3. The measurements indicated are supplied for guidance only and as such must be considered incorrect. Potential buyers are advised to recheck measurements before committing to any expense. 4. We have not tested any apparatus, equipment, fixtures, fittings or services and it is in the buyers interest to check the working condition of any appliances.

Connells Residential is registered in England and Wales under company number 1489613, Registered Office is Cumbria House, 16-20 Hockliffe Street, Leighton Buzzard, Bedfordshire, LU7 1GN. VAT Registration Number is 500 2481 05.

See all our properties at www.connells.co.uk | www.rightmove.co.uk | www.zoopla.co.uk

Property Ref: STP308517 - 0003