



Mattock Lane, W5

£425,000

A newly updated one bedroom second-floor apartment, offering well-proportioned accommodation throughout. The property features a spacious living room, a generous eat-in kitchen, and a double bedroom with integrated wardrobes. Further benefits include a private garage, adding valuable storage or parking space.

Located on Mattock Lane, directly opposite Walpole Park, the property is ideally positioned approximately 0.6 miles from Ealing Broadway station, offering access to the Elizabeth line, Central line and District line. A wide range of restaurants, gyms and shops in Ealing Broadway are also just moments away, making this an exceptionally convenient location.

Features

- One Bedroom
- Newly Renovated
- No Onward Chain
- Second Floor
- Garage
- Centrally Located

Mattock Lane, London, W5

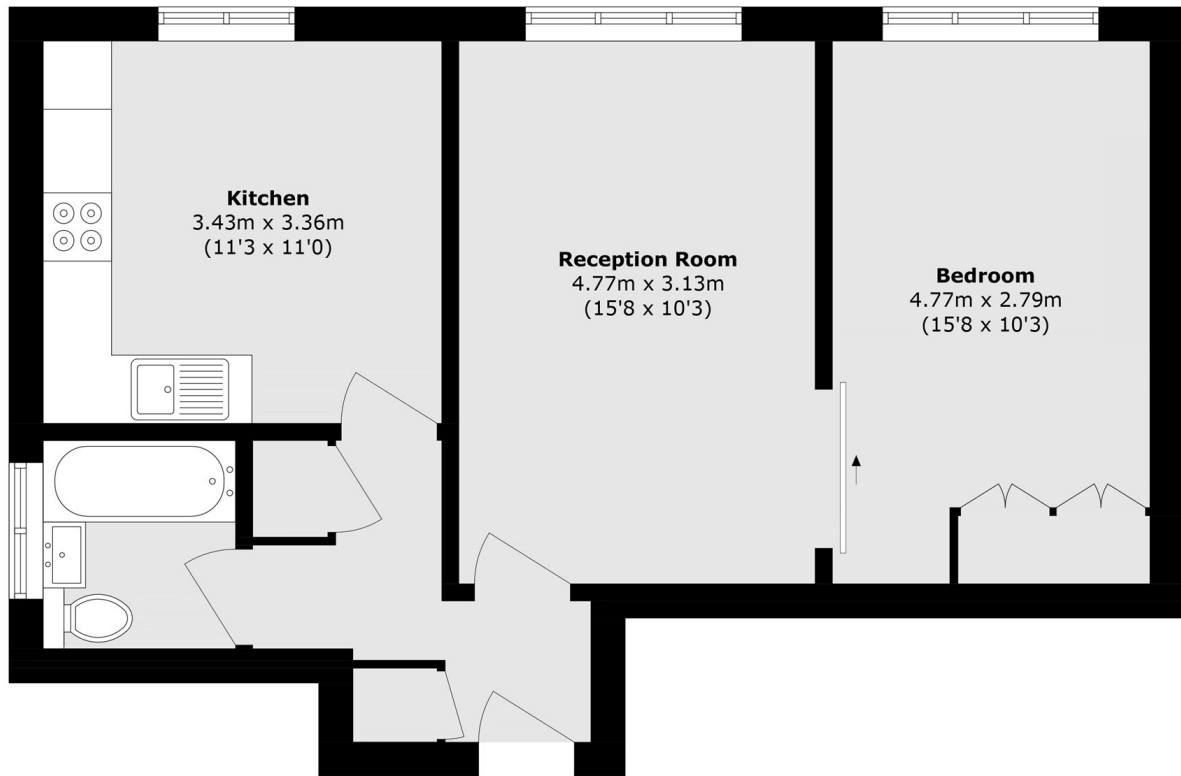

Total area (approx.): 50.8 sq. m (546.8 sq. ft)