



Dymoke Mews, Church Lane
Stevenage | SG1 3BZ

AGENT HYBRID

£290,000



CHAIN FREE, Beautifully presented throughout and finished with an exceptional eye for detail, this stunning one-bedroom home offers a perfect blend of contemporary living and individual character. The property immediately impresses with its striking interiors, where modern finishes are complemented by carefully curated décor, creating a home that feels both stylish and welcoming. Plantation shutters, feature panelling, statement lighting and bespoke touches can be found throughout, giving each room its own personality whilst maintaining a cohesive design. The living room provides a superb entertaining and relaxation space, featuring elegant wall panelling, contemporary lighting, warm colour palettes and an abundance of natural light. The room flows effortlessly into the modern kitchen, which is fitted with sleek high-gloss cabinetry, timber worktops and integrated appliances, creating a practical yet highly attractive space for everyday living. A charming dining area sits beneath the staircase, cleverly maximising space whilst creating a cosy setting for morning coffee, dining or home working. Upstairs, the bedroom is beautifully appointed with ample room for wardrobes, feature décor and a luxurious atmosphere. The accommodation is complemented by a truly distinctive bathroom, showcasing a freestanding roll-top bath, a separate shower, feature panelling and boutique-style finishes rarely found in homes of this size. Outside, the property benefits from a beautifully landscaped private courtyard garden designed for low-maintenance enjoyment. Thoughtfully arranged with paved seating areas, decorative planting, feature lighting and stylish entertaining spaces, the garden provides an attractive extension of the home. The secluded setting creates the perfect space for al fresco dining, morning coffee or relaxing with friends during the warmer months, whilst retaining the same character and individuality found throughout the interior. Furthermore, an off road allocated parking space is located behind the rear garden, offering further convenience. Throughout the property, thoughtful design choices and high-quality presentation create a home that is ready to move straight into, offering buyers something genuinely different from the ordinary. Situated within a convenient location for local amenities, transport links and everyday conveniences, this exceptional home is ideal for first-time buyers, professionals or anyone seeking a property with style, character and individuality. Viewing is highly recommended to fully appreciate the quality, presentation and unique atmosphere this beautiful home has to offer.

DIMENSIONS

- Kitchen/Diner 10'9 x 10'1
- Lounge 10'9 x 9'7
- Bedroom 10'9 x 9'8
- Bathroom 10'9 x 7'1

Ground Floor

Approx. 20.6 sq. metres (221.4 sq. feet)

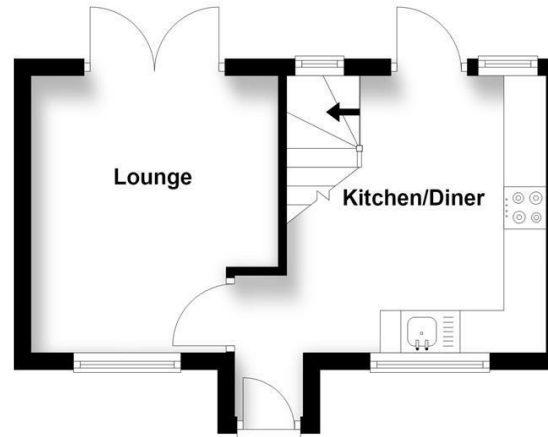

First Floor

Approx. 19.2 sq. metres (206.5 sq. feet)



Total area: approx. 39.7 sq. metres (427.9 sq. feet)

IMPORTANT: We would like to inform prospective purchasers that these sales particulars have been prepared as a general guide only. A details survey has not been carried out, not the service, appliances and fittings tested. Room sizes should not be relied upon for furnishing purposes and are approximate. If floor plans are included, they are for guidance and illustration purposes only and may not be to scale. If there are any important matters likely to affect your decision to buy, please contact us before viewing the property.

Energy Efficiency Rating		Current	Potential
Very energy efficient - lower running costs			
(92 plus) A			
(81-91) B			
(69-80) C			
(55-68) D			

Agent Hybrid

57 High Street, Stevenage, Hertfordshire, SG1 3AQ
 Tel: 01438 870673 - enquiries@agenthybrid.co.uk
 www.agenthybrid.co.uk

AGENT HYBRID