

21 Caistor Close, Whalley Range, Manchester, M16 8NW



JP & Brimelow
ESTATE AGENTS

Offers In The Region Of £335,000



VIDEO TOUR AVAILABLE A charming THREE BEDROOM, linked- detached property, located on a highly popular residential development off Alexandra Road South. Close to the Metrolink stations on St Werburgh's Road and Mauldeth Road West, the property is also close to Whalley Range Lawn Tennis Club, local amenities including Hough End playing fields, bus routes directly into the city centre and motorway links to Manchester International Airport and further afield. The well-planned property consists of an entrance hall, a good-sized lounge with a box bay window and useful under stairs storage cupboard, a fitted kitchen/diner with access out into the rear enclosed garden. Stairs leading to the first-floor landing reveal three good sized bedrooms, and a three-piece bathroom, completing this home. Other benefits include gas fired central heating, a rear enclosed garden, and a detached garage.





EPC Chart

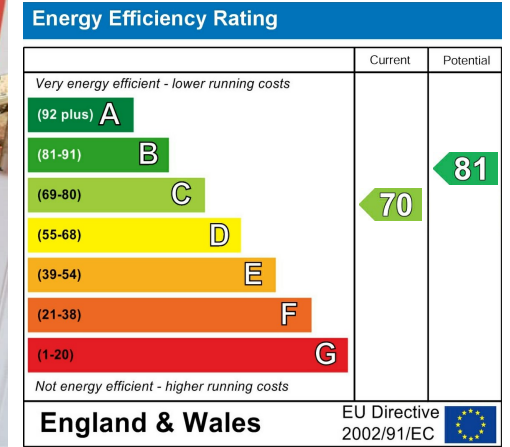

Tenure: **Freehold** Council Tax Band: **C**

Ground Floor

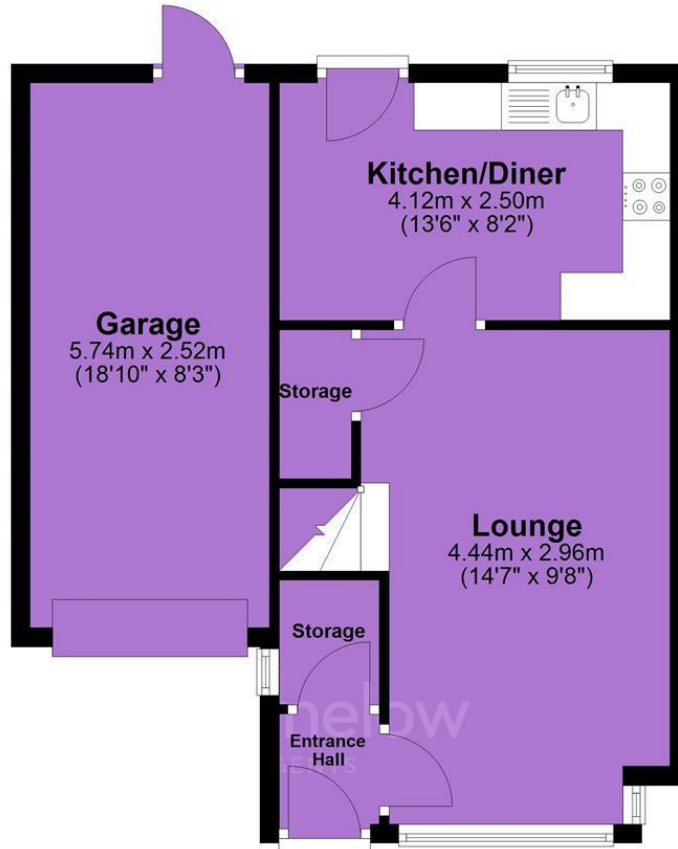

First Floor



JP & Brimelow Estate Agents Ltd
430 Barlow Moor Road, Manchester, M21 8AD
Tel: 0161 8822233
E: sales@jpbrimelow.co.uk www.jpandbrimelow.co.uk



JP & Brimelow
ESTATE AGENTS

NOTICE: JP & Brimelow Estate Agents Ltd for themselves and for the vendors or lessors of this property whose agents they are give notice that:

- (i) the particulars are set out as a general outline only for the guidance of intending purchasers or lessees, and do not constitute, nor constitute part of, an offer or contract;
- (ii) all descriptions, dimensions, references to the condition and necessary permissions for use and occupation, and other details are given in good faith and are believed to be correct but any intending purchasers or tenants should not rely on them as statements or representations of fact but must satisfy themselves by inspection or otherwise as to the correctness of each of them;
- (iii) no person in the employment of JP & Brimelow Estate Agents Ltd has any authority to make or give any representation or warranty whatever in relation to this property.

jpandbrimelowstateagents

@jpandbrimelow