



Luscombe Maye
Since 1873

Court Road, NEWTON FERRERS, South Devon

Guide Price £695,000

🛏 2 🚿 1 🛋 2



DESCRIPTION

Situated on Court Road in the highly sought-after village of Newton Ferrers, this well presented 1930's detached bungalow offers an excellent blend of character and modern comfort. Many of the original features have been retained and the well proportioned rooms with high ceilings create a charming and comfortable home. The property features a garage and driveway parking for multiple vehicles. A recently updated kitchen and breakfast room provides a stylish and practical space with glazed patio doors leading directly onto the rear terrace. The charming, dual aspect lounge-dining room is a calm and comfortable room which enjoys an abundance of natural light throughout the day. The accommodation continues with two well-proportioned double bedrooms, a generous shower room and useful utility room. A boarded loft with ladder access gives accessible storage space but could also be considered for a loft conversion, subject to Planning Permission. Recently installed high efficiency insulation in the loft and new fiberglass roof both with a 10 year guarantee. The bungalow sits in the centre of a large plot with glorious front and rear gardens, providing privacy and ample space for relaxation and entertaining. A timber summer house further enhances the property offering a versatile space for work, leisure or additional storage.

FURTHER INFORMATION Verified Material Information. To ensure legal compliance, we require our sellers to complete a Property Information Questionnaire or provide a Material Information Guide along with the title document. If available, please scan the QR code or access the additional online material information (<https://moverly.com/sale/Morf8NzYkqcS9mR61b84GG/view>). Alternatively, you can contact our team for this information.

South Hams District Council. Council Tax band: E Tenure: Freehold

VIEWING Strictly by appointment with Luscombe Maye, Newton Ferrers Office

What3Words///whispers.brink.elephant



Penns Cottage, 74 Court Road, Newton Ferrers, PL8 1DA

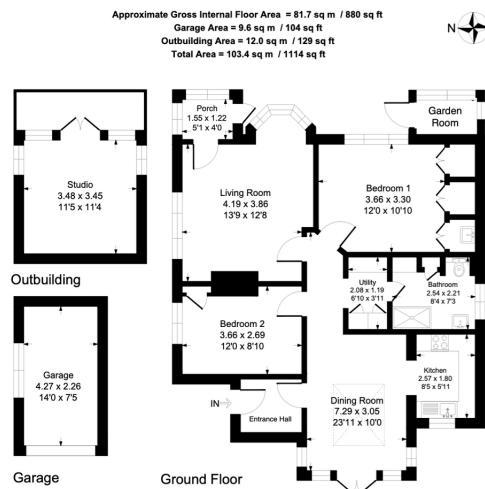

Illustration for identification purposes only, measurements are approximate, not to scale.

 **Luscombe Maye**
 Since 1873



Use the QR code for further "Material Information" about this home

- Detached South Facing Bungalow
- Central Village Location
- Two Double Bedrooms
- Garden Studio/Summer House
- Generous Private Mature Gardens
- 1930's Period Features
- Recently fitted Kitchen
- Feature multifuel burner in Living Room
- Detached Garage
- Private Drive with Ample Parking

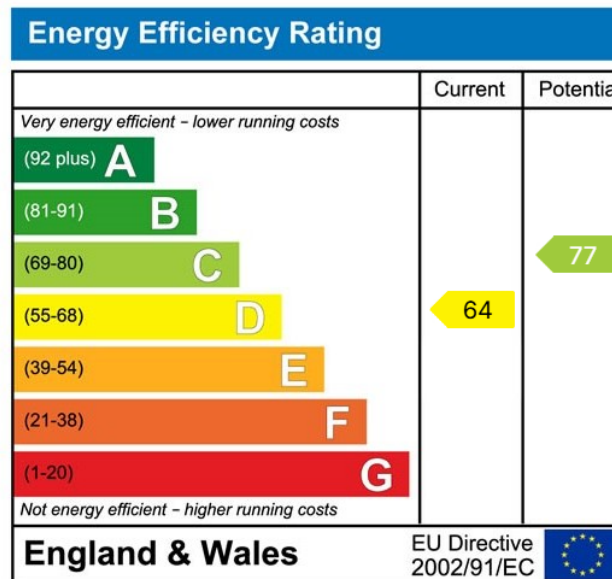

 **Luscombe Maye**
 Since 1873

Newton Ferrers:
 Newton Hill, Newton Ferrers PL8 1AA
 01752 872417
newtonferrers@luscombemaye.com
www.luscombemaye.com